

Monument Set (Procedure and Description)

5/8" x 5 FT IRON ROD WITH ALUM
 CAP STAMPED "NO 7 1997" IS
 SET 8" BELOW GROUND. THIS
 POSITION IS DETERMINED BY FOUND
 STONE CORROBORATED BY EVIDENCE
 FOUND AT HES COR #6. ORIGINAL
 STONE IS LAID ALONG NORTH
 EDGE 2 1/2' BELOW GROUND

5/8" I.R. HES COR #6
 BEARS EAST 20 1/5 FT
 (8" ABOVE GROUND)

N/A

New Accessories

29" ASH MARKED FOR HES COR #6 " x 6 HES 213 MC (S BT " ON A
 DOUBLE BLAZE BEARS N 60° W, 125.0 FT (BT TAG REFERS
 TO COR #6)

9" HOLLY BARK SCRIBED FOR HES COR #6 " x 13T"
 BEARS SOUTH 109.4 FT (BT TAG REFERS TO COR #6)

POWER POLE " 9-140 " BEARS S 39° E 160.8 FT

Sketch of Monument, Accessories, and General Area

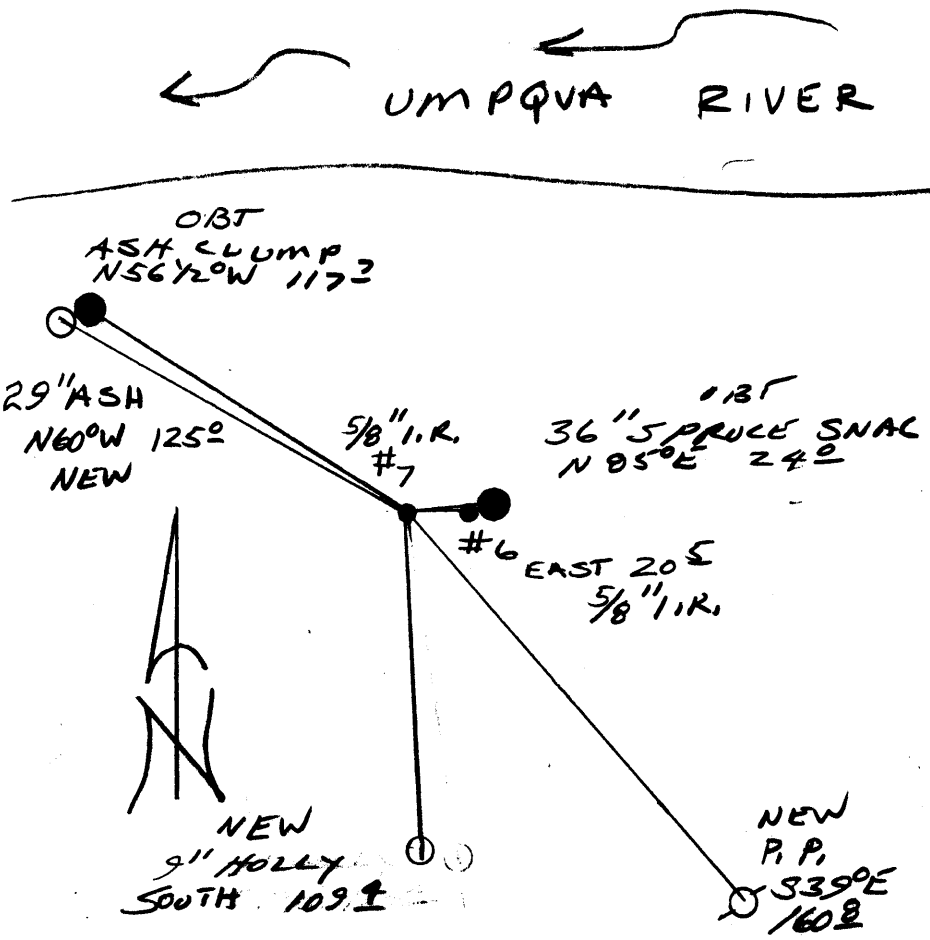

Location & Comments

Comp. Declin. 17 3/4° E
 Agency DLSO
 Party Chief RANDALL W. SMITH
 Notekeeper [Signature]
 Witnesses _____

Address

Surveyor's Seal

REGISTERED
 PROFESSIONAL
 LAND SURVEYOR

Randall W. Smith
 EXPIRES 6-30-98

OREGON
 JULY 25, 1990
 RANDALL W. SMITH
 2469