

RENEWAL

Monument Detail

Monument Set (Procedure and Description)

2 3/4" DIA BRASS CAPON A
 1 3/4" BY 32" LONG IRON PIPE
 PROTRUDES 4" ABOVE GROUND.
 BEARS SOUTH 5' FROM LINE
 TREE

DOUGLAS COUNTY SURVEYOR
 BO 1

SLT BEARS
 NORTH 5 FT

1997
 OFFICE

New Accessories

10" DIA. D. FIR DOUBLE BLAZED AND SCRIBED "SLT 51 CSBT"
 BEARS S 57° W, 16.5 FT
 7" DIA PINE DOUBLE BLAZED AND SCRIBED "SLT 51 CSBT"
 BEARS S 20° W, 30.9 FT
 8" DIA. D. FIR DOUBLE BLAZED AND SCRIBED "SLT 56 CSBT"
 BEAR N 33° E 24.9 FT

Sketch of Monument, Accessories, and General Area

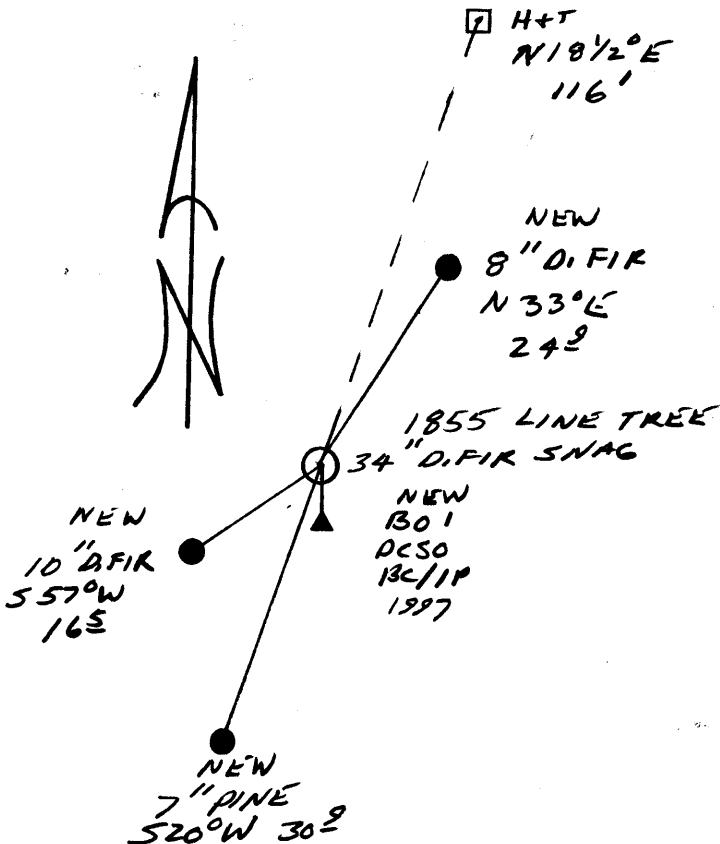

Location & Comments

Comp. Declin. 17 3/4° E
 Agency DCSO
 Party Chief RANDALL W SMITH
 Notekeeper [Signature]
 Witnesses STEPHEN FLAISE

Address _____

Surveyor's Seal

REGISTERED
 PROFESSIONAL
 LAND SURVEYOR

Randall W Smith
 EXPIRES 6-30-98

OREGON
 JULY 25, 1990
 RANDALL W. SMITH
 2468