

Monument Set (Procedure and Description)

Monument Detail

NONE

N/A

New Accessories

11" DIA D.FIR DOUBLE BLAZED AND SCRIBED "ESE DLC 50 CS. 07"
BEARS S51°E, 28.0 FT.

9" DIA D.FIR DOUBLE BLAZED AND SCRIBED "ESE DLC 50 CS. 07"
BEARS S49°W, 16.4 FT.

Sketch of Monument, Accessories, and General Area

Location & Comments

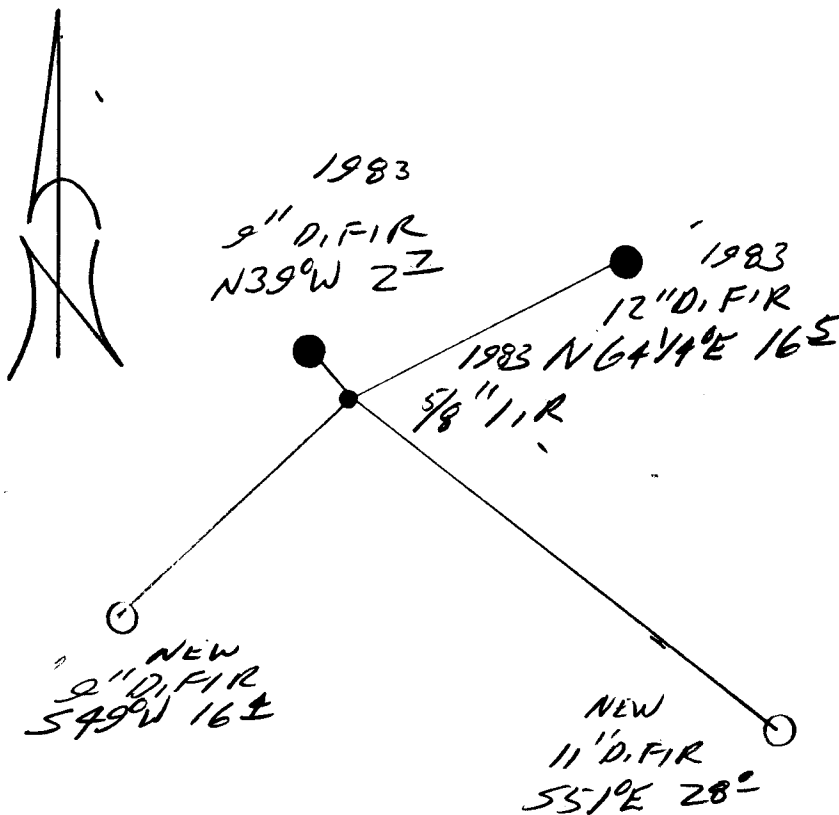

Comp. Declin. 17 3/4° E
 Agency DCS
 Party Chief RANDALL W. SMITH
 Notekeeper [Signature]
 Witnesses [Signatures]

Address

Surveyor's Seal
 REGISTERED
 PROFESSIONAL
 LAND SURVEYOR

[Signature]
 JULY 25 1990

OREGON
 JULY 25, 1990
 RANDALL W. SMITH
 2489