

GOVERNMENT CORNER RESTORATION FORM

Date: 8-8-97 By: PC

This survey consists of:

Township 25S Range 4W Sec. 18 County DOUGLAS Map: _____
State OK Date 7-31-97 No. _____ Narrative: _____
Corner Rpt: CS 64/71-29

Corner Designation

$\frac{1}{4}$ S 18
S 19

DOUGLAS COUNTY SURVEYOR

Condition Report Only

Not Found

Renewed

Unrecorded

Surveyed In

Referenced Out

MONUMENT DETAIL

Previous Renewals 1957 BLM

Monument(s) Found: (Condition and Source)

3/4" DIA. BRASS CAP ON A 2 1/2"
OD. IRON PIPE, SET FLUSH
WITH GROUND. 1957

U.S. COASTAL SURVEY

T 25 S
R 4 W

$\frac{1}{4}$ S 18
S 19

1957

BUREAU OF LAND MANAGEMENT

Accessories Found:

16" NOW 17" DIA W. OAK WITH A FULLY HEALED SINGLE BLAZE
BEARS N 39° E, 107.6 FT (REC N 41 1/2° E, 107.6 FT) 1957

9" NOW 17" DIA. D. FIR WITH A FULLY HEALED SINGLE BLAZE
BEARS S 57° E, 30.7 FT (CORRECS WITH REC.) 1957

Monument Set (Procedure and Description)

Monument Detail

N/A

N/A

New Accessories

8" DIA. W. OAK DOUBLE BLAZED AND SCRIBED "1/4 S 19 CS RT"
BEARS S 28° W, 32.5 FT

11" DIA. ASH SINGLE BLAZED AND SCRIBED "1/4 S 19 CS RT"
BEARS N 88° W, 89.4 FT

Sketch of Monument, Accessories, and General Area

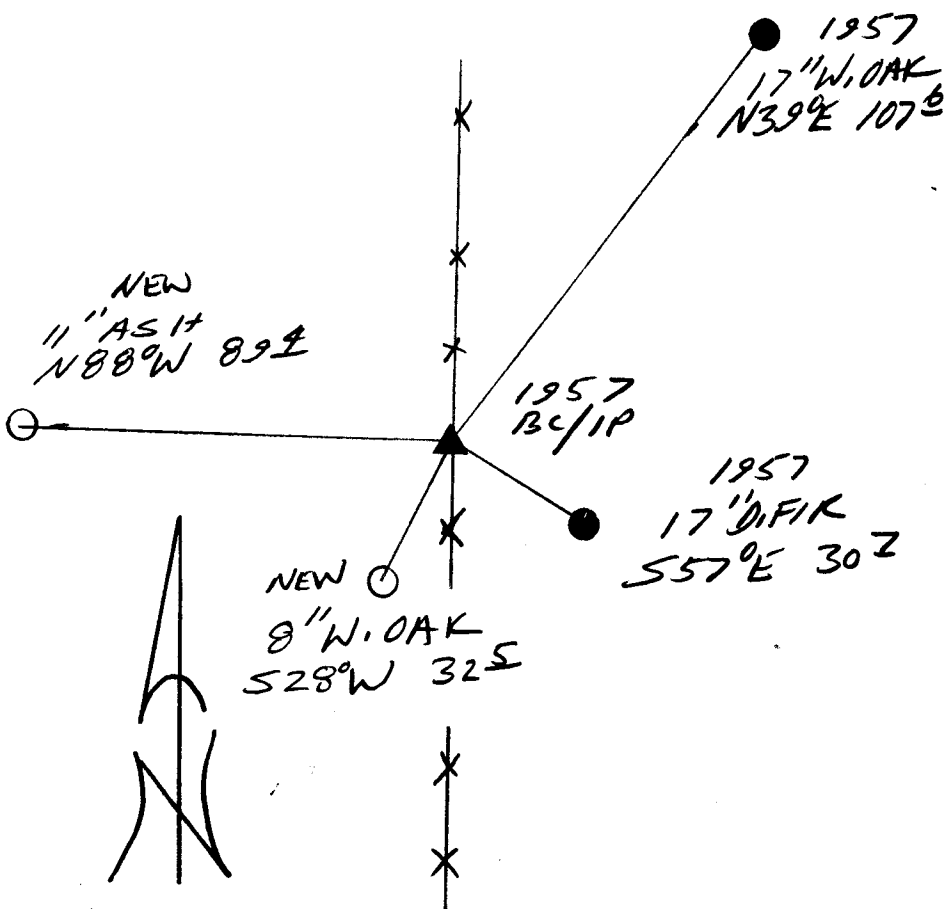

Location & Comments

CORNER LIES IN A
N-S FENCE LINE

Comp. Declin. 17 3/4° E
 Agency WCSO
 Party Chief RANDALL W. SMITH
 Notekeeper [Signature]
 Witnesses STEPHEN T. [Signature]

Address

Surveyor's Seal

REGISTERED
PROFESSIONAL
LAND SURVEYOR

[Signature]
EXPIRES 6-30-98

OREGON
JULY 25, 1990
RANDALL W. SMITH
2469