

Date: 3/12/97 By: BC

GOVERNMENT CORNER RESTORATION FORM

This survey consists of:

Township 31S Range 6W Sec. 1

County DOUGLASS Map:

State OR

Date 2-25-97

No. \_\_\_\_\_

Narrative: \_\_\_\_\_  
Corner Rpt: CS 64/71-11

Corner Designation

1855

1/4 S 1 X S 6  
ONLY

PI #700640

DOUGLAS COUNTY SURVEYOR

- Condition Report Only
- Not Found
- Renewed
- Unrecorded
- Surveyed In
- Referenced Out

Previous Renewals 1878 BLM, 1979 DCSO, 1980 BLM

Monument(s) Found: (Condition and Source)

4" NOW 11" DIA 1 1/2 FT HIGH D.FIR STUMP NO SCRIBING VISIBLE. (ORIG CORNER TREE 1855)

2 1/2" DIA BRASS CAPONA 1/4" OD IRON PIPE FLUSH WITH GROUND. BEARS S 87° E, 5.0 FT FROM ORIG. 1855 CORNER TREE. (AGREES WITH 1980 BLM RECORD). METAL FENCE POST ALONG SW EDGE OF BC/IP (1979 DCSO)

DOUGLAS COUNTY SURVEYOR

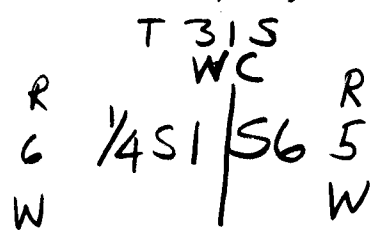

1979

ALL STUMPS IN AREA ARE BURNT  
Accessories Found:

6" NOW 28" DIA 2 1/2 FT HIGH D.FIR STUMP, POSSIBLE HEALED BLAZE BEARS S 87° W, 5.3 FT (AGREES WITH REC) OBT

20" NOW 18" DIA, 2 1/2 FT HIGH D.FIR STUMP WITH AN UNHEALED BURNT BUT DOUBLE BLAZE, BEARS N 36° E, 8.6 FT (AGREES WITH 1980 BLM RECORD) 1979 DCSO

26" NOW 24" DIA, 2 1/2 FT HIGH D.FIR STUMP NO BARK SCRIBING VISIBLE, BEARS S 17 1/2° W, 43.2 FT (AGREES WITH 1980 BLM RECORD) 1979 DCSO

14" NOW 15" DIA 2 FT HIGH D.FIR STUMP WITH PARTIALLY HEALED BURNT BUT DOUBLE BLAZE SCRIBING VISIBLE 1/4" BEARS S 34° E, 28.0 FT (AGREES WITH 1980 BLM RECORD) 1979 DCSO

1979 BT - STUMPS HAVE GALV. METAL CAPS ON TOP OF STUMPS

SEE BLM RENEWAL DCSO RECORDS VOL 45 PG 5 17310

100640

RENEWAL

Monument Set (Procedure and Description)

A 5/8" BY 30" LONG IRON ROD IS DRIVEN THROUGH TOP CENTER OF 1855 CORNER STUMP. AN ALUM. DCSO CAP STAMPED "1/4 1997" IS SET ON TOP OF I.R.

Monument Detail

DOUGLAS COUNTY SURVEYOR

T 31S

WC

R 6 W ONLY | 56 5 W

1979

New Accessories

NONE

Sketch of Monument, Accessories, and General Area

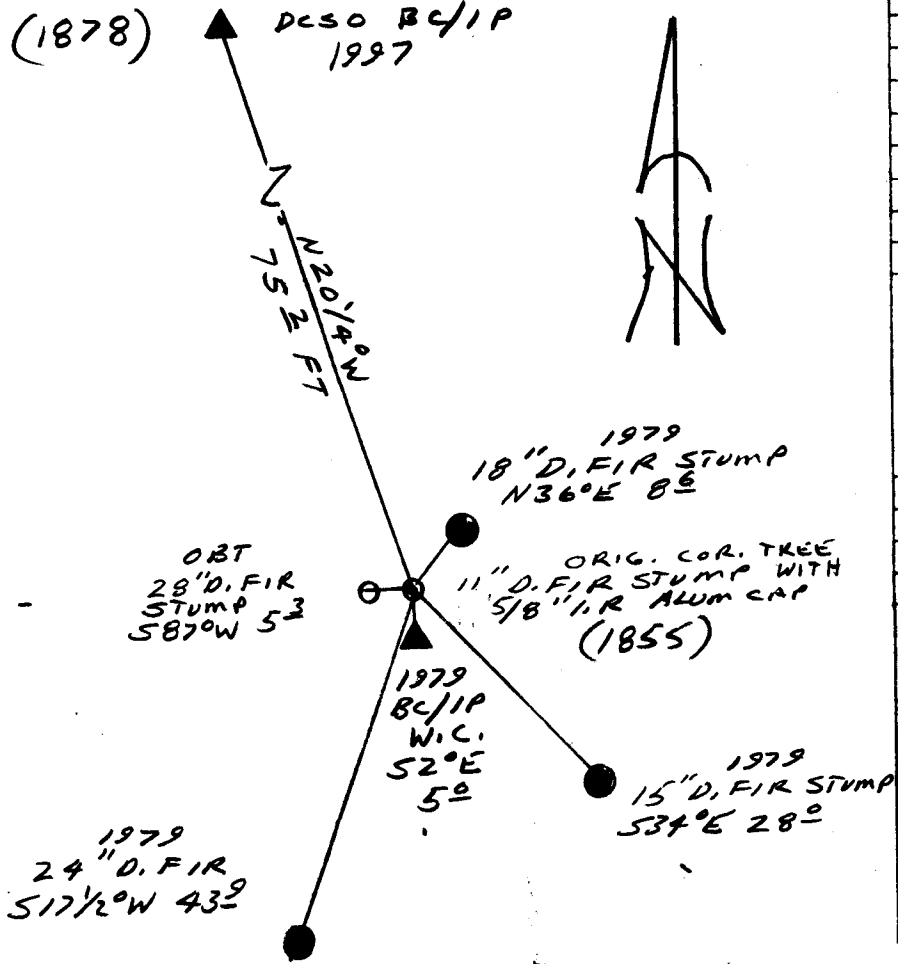

Location & Comments

CORNER LIES ON STEEP WESTERLY SLOPE IN A BURNT CLEAR CUT

NOTE PER 1980 BLM RECORDS THIS CORNER CONTROLS RANGE LINE IS THE 1/4 COR OF SEC. 1 ONLY

Comp. Declin. 17 3/4° E  
 Agency DCSO  
 Party Chief RANDALL W. SMITH  
 Notekeeper J. G. ...  
 Witnesses STEPHEN J. FLAISE

Address

Surveyor's Seal

REGISTERED PROFESSIONAL LAND SURVEYOR

*Randall W. Smith*

JULY 25, 1990

RANDALL W. SMITH

2469

6-30-98