

GOVERNMENT CORNER RESTORATION FORM

Date: 1-28-97 By: AC

Township 27S Range 3W Sec. 34 County DOUGLAS Map: _____

This survey consists of: _____

State OR Date 1-23-97 No. _____

Narrative: _____

Corrct Rpt: 64/71-9

Corner Designation

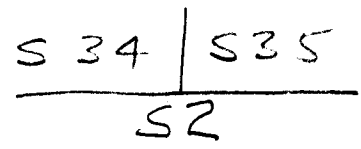

DOUGLAS COUNTY SURVEYOR

- Condition Report Only
- Not Found
- Renewed
- Unrecorded
- Surveyed In
- Referenced Out

Previous Renewals 1988 + 1985 BLM, REN #74

MONUMENT DETAIL

Monument(s) Found: (Condition and Source)

2 1/2" DIA ALUM. CAP ON A
1" O.D. IRON PIPE 11" ABOVE
GROUND. SET BY THOMAS
STRUM DATE UNKNOWN

1958 BLM 3/4" DIA BRASS CAP ON
AN IRON PIPE IS FOUND 7" BELOW
GROUND ALONG NORTHERLY EDGE
OF ALUM CAP/IP.

3/4" I.R. NOTED IN REN #74 IS
FOUND FLUSH WITH GROUND ALONG
NORTH EDGE OF ALUM. CAP
IRON PIPE.

THE BC/IP IS 0.3 FT NORTH OF
ALUM CAP/IP

U.S.P.C. PROPERTY COR.
 T27S R3W
 34 | 35
 RE 4287

U.S. CADASTRAL SURVEY
 T27S R3W
 534 | 535
 S2
 T28S
 1958
 BUREAU OF LAND MANAGEMENT

Accessories Found:

- BRC + DIST TAKEN FROM BLM BC/IP
- 16" NOW 32" DIA. 2 1/2 FT HIGH CEDAR STUMP
WITH A SMALL BLAZE SHOWING ILLEGIBLE SCRIBING,
AND AXE MARK, BEARS N 130° E 35.0 FT
(REC N60° E, 33.0 FT DIST FALLS SHORT OF STUMP
AGREES WITH 1985 BLM DIST.) ORT
 - 12" NOW 12" DIA. 25" HIGH CEDAR SNAG WITH AN UNHEALED
BLAZE. SCRIBING VISIBLE "T27S R3W S34 SC BT" BEARS
N67° 40' W, 102.3 FT (AGREES WITH 1985 BLM REC) 1958 BLM
 - 6" R. FIR, NOW 17" DIA HEMLOCK WITH A FULLY HEALED
DOUBLE BLAZE BEARS N62° W 83.8 FT (AGREES WITH
1985 BLM RECORD) REN #74
 - 11" NOW 9" DIA 12 FT HIGH CEDAR SNAG WITH AN UNHEALED
SINGLE BLAZE. SCRIBING VISIBLE "T27S R35 S35 SC BT"
BEARS N27° E, 197.3 FT (AGREES 1985 BLM REC)
1958 BLM
 - 29" DIA CEDAR WITH A PARTIALLY HEALED SINGLE BLAZE
SCRIBING VISIBLE "C BT" BEARS N 63/4° E, 157.1 FT
(AGREES WITH REC) 1985 BLM

RENEWAL

Monument Set (Procedure and Description)

NONE

Monument Detail

N/A

NOTE: THIS BKG + DIST AGREES WITH ORIG. RECORD

U.S.P.C. PROPERTY COR.
T28S R3W

312
RE 4287

New Accessories

- 2 1/2" ALUM. CAP ON A 1" OLD IRON PIPE PROTRUDING 16" ABOVE GROUND MARKED AS NOTED ON THIS PAGE UNDER MONUMENT DETAIL. SET BY THOMAS SHRUM DATE UNKNOWN BEARS WEST 40.9 FT
- 13" DIA. HEMLOCK DOUBLE BLADED AND SCRIBED "T27S R3W S34SC CSBT" BEARS N 87° W 49.5 FT.
- 11" DIA. ASH DOUBLE BLADED AND SCRIBED "T27S R3W S35SC CSBT" BEARS N 19 1/2° E 62.7 FT

Sketch of Monument, Accessories, and General Area

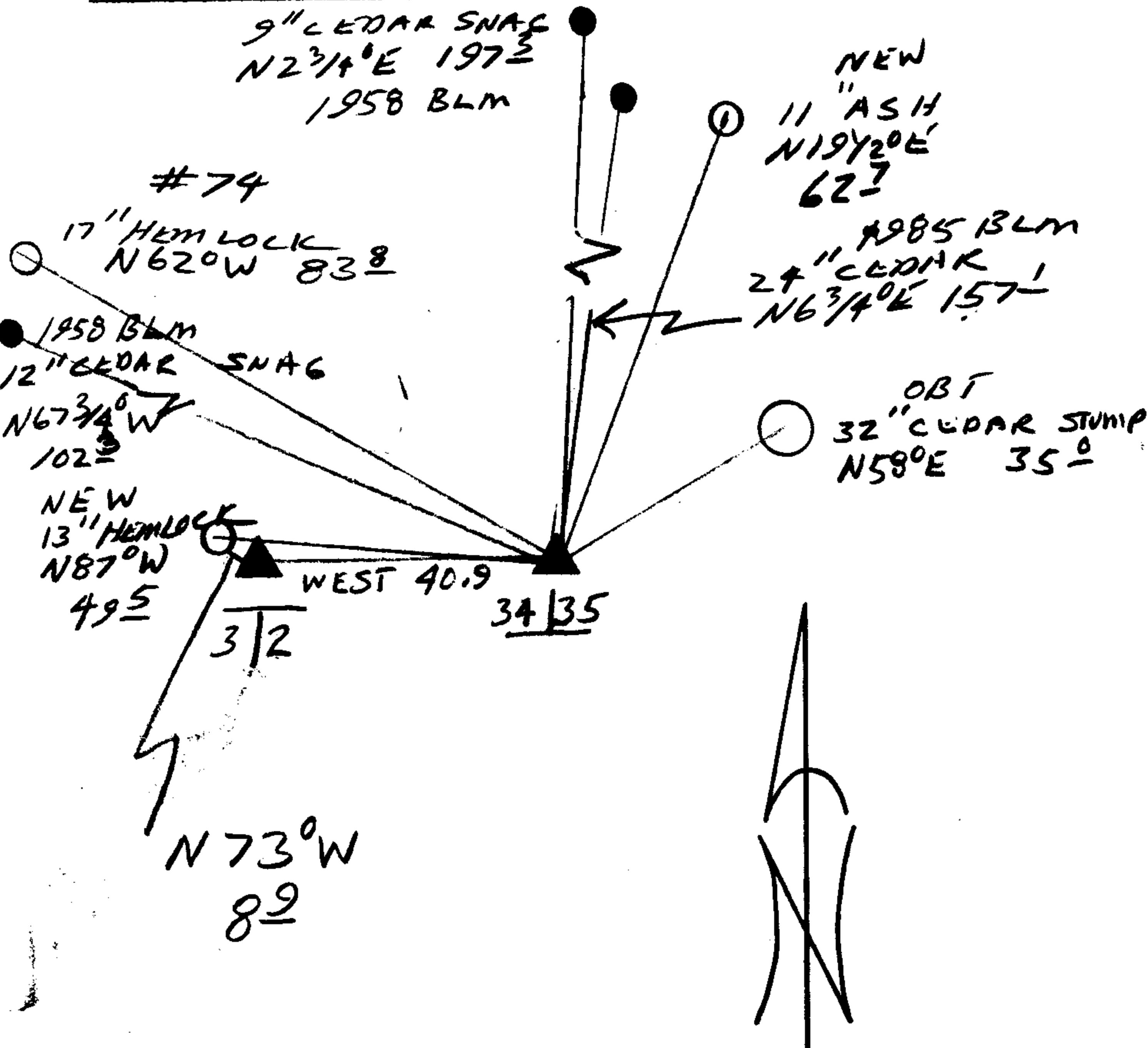

Location & Comments

CORNER LIES IN AN AREA THAT FLOODS OFTEN SET METAL LIT. POST AND SIGN 1 FT SOUTH OF CORNER

Comp. Declin. 17 3/4° E
 Agency DCSO
 Party Chief RANDALL W. SMITH
 Notekeeper [Signature]
 Witnesses STEPHEN J. FLAISE

Address

Surveyor's Seal
 REGISTERED PROFESSIONAL LAND SURVEYOR
 [Signature]
 EXPIRES 6-30-98
 OREGON
 JULY 25, 1990
 RANDALL W. SMITH
 2469