

Monument Set (Procedure and Description)

Monument Detail

NONE

N/A

NEW ACCESSORIES

- 3" D.A. DCSO DRILL CAP STAMPED "BO2 SE DCC 47 1996" IS SET NEAR MIDDLE AT SOUTHERLY EDGE OF A 6' LONG BY 4' WIDE 1/2' HIGH ROCK OUT CROP THAT HAS A N75°E ORIENTATION. DRILL CAP BEARS N79°W 62.9 FT

New Accessories

- 3" D. FIR DOUBLE BLAZED AND SCRIBED "X BT" BEARS N2°E 11.3 FT
- 3" DIA DCSO DRILL CAP STAMPED "BO1 SE DCC 47 1996" IS SET AT EASTERLY END OF A 12' LONG BY 6' WIDE 1' HIGH ROCK OUT CROP THAT HAS A N30°W ORIENTATION. DRILL CAP BEARS S58°W 45.3 FT
- 8" MAPLE DOUBLE BLAZED AND SCRIBED "SE DCC 47 CS BT" BEARS S7°W 57.4 FT

Sketch of Monument, Accessories, and General Area

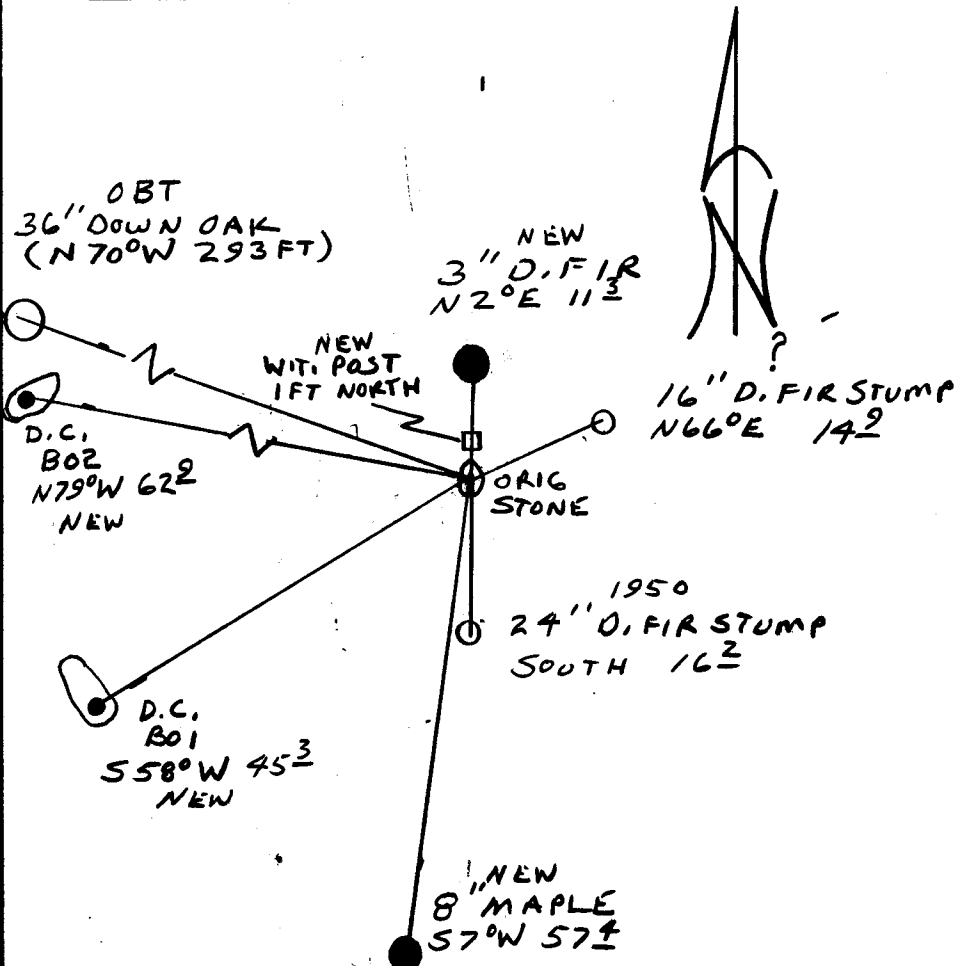

Location & Comments

METAL WITNESS POST AND SIGN IS SET 1 FT NORTH OF CORNER

CORNER LIES APPROX 225 FT EASTERLY OF RAIL ROAD TRACKS

Comp. Declin. 17 3/4° E
 Agency DCCO
 Party Chief LARRY E. MONREAN
 Notekeeper *Barclay W Smith*
 Witnesses

Address

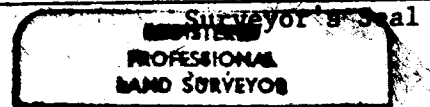

Barry E. Monrean

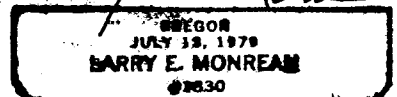

EXPIRES 12-31-96