

GOVERNMENT CORNER RESTORATION FORM

Date: 8-7-96 By: PC

This survey consists of:

Township 31S Range 6W Sec. 35 County DOUGLAS Map: _____

State OR Date 7-16-96 No. _____ Narrative: _____

Corner Rpt: 64/69-18

Corner Designation

1/4 S35 | S36

DOUGLAS COUNTY SURVEYOR

- ____ Condition Report Only
- ____ Not Found
- Renewed
- ____ Unrecorded
- ____ Surveyed In
- ____ Referenced Out

Previous Renewals 1963 DCSO PI# 600140

Monument(s) Found: (Condition and Source)

2 1/2" BRASS CAP ON A 1/2" O.D. IRON PIPE BENT 1 FT WEST PROTRUDING 18" ABOVE GROUND. (1963)

COUNTY SURVEYORS OFFICE
T 315

1/4 S35 | S36

1963

Accessories Found:

MEASUREMENTS TAKEN FROM PLUMB POSITION OF BC/IP
15" NOW 16" DIA 4 FT HIGH DIER STUMP WITH A PARTIALLY HEALED
UPPER BLAZE, SCRIBING VISIBLE "4 S36 CS" LOWER BLAZE
IS HEALED BEARS N 33° E 27.7 FT (RECORD N 23° E
28.5 FT DISTANCE IS A SLOPE MEASUREMENT) 1963

5" NOW 6" DIA DOWN AND ROTTED CEDAR WITH SCRIBING VISIBLE
ON A PARTIALLY HEALED DOUBLE BLAZE "1/4 S35 CS BT"
ROTTED ROOT CROWN BEARS S 83° E, 40.3 FT (AGREES WITH RECORD)
1963

A SEARCH WAS MADE FOR THE 6" FIR AT A BEARING
AS SHOWN IN PI# 600140 OF N. W, 24.9 FT NO
EVIDENCE FOUND (NOTE AREA AROUND CORNER IS HEAVILY
BRUSH COVERED.)

C.S. File No. 64/69-18

RENEWAL

Monument Detail

Monument Set (Procedure and Description)

PLUMB POSITION OF BC/IP IS REFERENCED, BC/IP IS REMOVED AND STRAIGHTENED (MEASURES 36" LONG). BC/IP IS SET AT REFERENCED POSITION, PROTRUDES 8" ABOVE GROUND

N/A

New Accessories

- 3" DIA. D. FIR DOUBLE BLAZED AND SCRIBED "X BT" BEARS S73°W, 10.2 FT
 - 60" DIA 3 FT HIGH D. FIR STUMP WITH A 6" BOAT SPIKE THROUGH A BT TAG SET NEAR TOP CENTER OF STUMP. BOAT SPIKE BEARS N 42° E, 17.6 FT (BOAT SPIKE IS STAMPED 1801)
 - 4" DIA. D. FIR DOUBLE BLAZED AND SCRIBED "X BT" BEARS N80 1/2° E, 6.2 FT
- Sketch of Monument, Accessories, and General Area

Location & Comments

CORNER LIES APPROX EAST, 110 FT FROM THE INTERSECTION OF A GRAVEL ROAD AND A DIRT ROAD

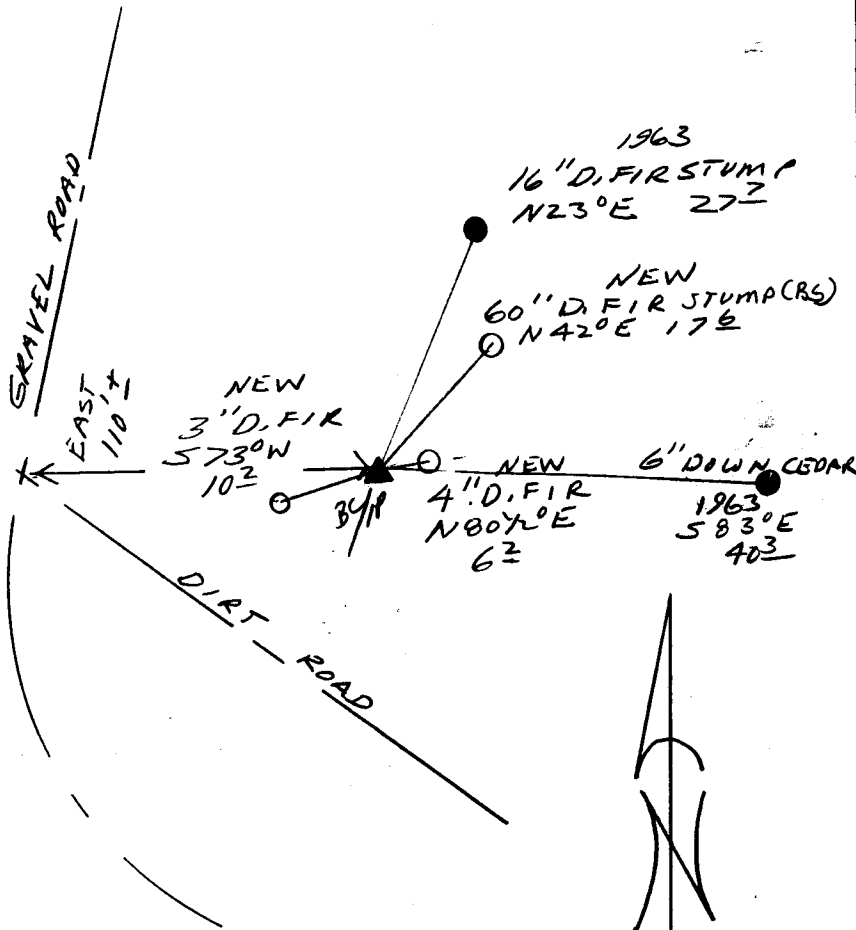

Comp. Declin. 17 3/4° E
 Agency DLSO
 Party Chief RANDALL W. SMITH
 Notekeeper Randall W. Smith
 Witnesses STEPHEN J. FLAUSE

Address

Surveyor's Seal

REGISTERED
 PROFESSIONAL
 LAND SURVEYOR

Randall W. Smith
 EXPIRES 6-30-90

OREGON
 JULY 25, 1990
 RANDALL W. SMITH
 2489