

GOVERNMENT CORNER RESTORATION FORM

Date: 8/7/96 By: PC
This survey consists of:

Township 315 Range 6W Sec. 35 County DOUGLAS
State OR Date 7-24-96 No. _____
Narrative: _____
Corner Rpt: 64/69-16

Corner Designation

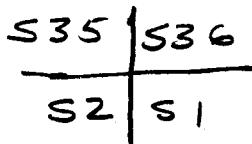

DOUGLAS COUNTY SURVEYOR

- Condition Report Only
- Not Found
- Renewed
- Unrecorded
- Surveyed In
- Referenced Out

PI # 600100 (M122-15)

Previous Renewals 1963 DCSO, 1980 BLM, 1995?

Monument(s) Found: (Condition and Source)

3/4" DIA. BRASS CAP AND 2 1/2" O.D. IRON PIPE PROTRUDING 8" ABOVE GROUND (1980 BLM)

US. DEPT. OF THE INTERIOR
T315 R6W
S35 | S36
S2 | S1
T32S
1980

BUR. OF LAND MANAGEMENT

Accessories Found:

NO OBJ'S FD

12" NOW 21" DIA HEMLOCK WITH A FULLY HEALED DOUBLE BLAZE BEARS S12°E, 3.5 FT (AGREES WITH REC.) 1963 DCSO

NO OTHER BT'S FROM 1963 DCSO RENEWAL FD

1980 BLM BT NOT FD.

11" DIA. D.F.I.R. WITH AN UNHEALED SINGLE BLAZE, SCRIBE VISIBLE "T32S R6W S1 BT" BEARS S91°40'W, 121.2 FT (RECORD PER BT TAG DATED 5-24-95 IS N78°W 121.2 FT) 1995? (M122-15)

NOTE BT TAG HAS INITIALS LDS AND TW

Monument Set (Procedure and Description)

Monument Detail

NONE

N/A

New Accessories

36" DIA 2 1/2 FT HIGH D. FIR WITH A 8" LONG BOAT SPIKE SET THROUGH A BT TAG NEAR TOP CENTER OF STUMP. TOP OF BS IS STAMPED "B01". BS BEARS S 50 1/4° W, 29.7 FT

3" PISTOL BUTT D. FIR DOUBLE BLAZED AND SCRIBED "X BT" CENTER OF TRUNK BEARS N 42 1/2° E, 64.1 FT NOTE: LOWER BLAZE IS 1 1/2' ABOVE GROUND.

Sketch of Monument, Accessories, and General Area

Location & Comments

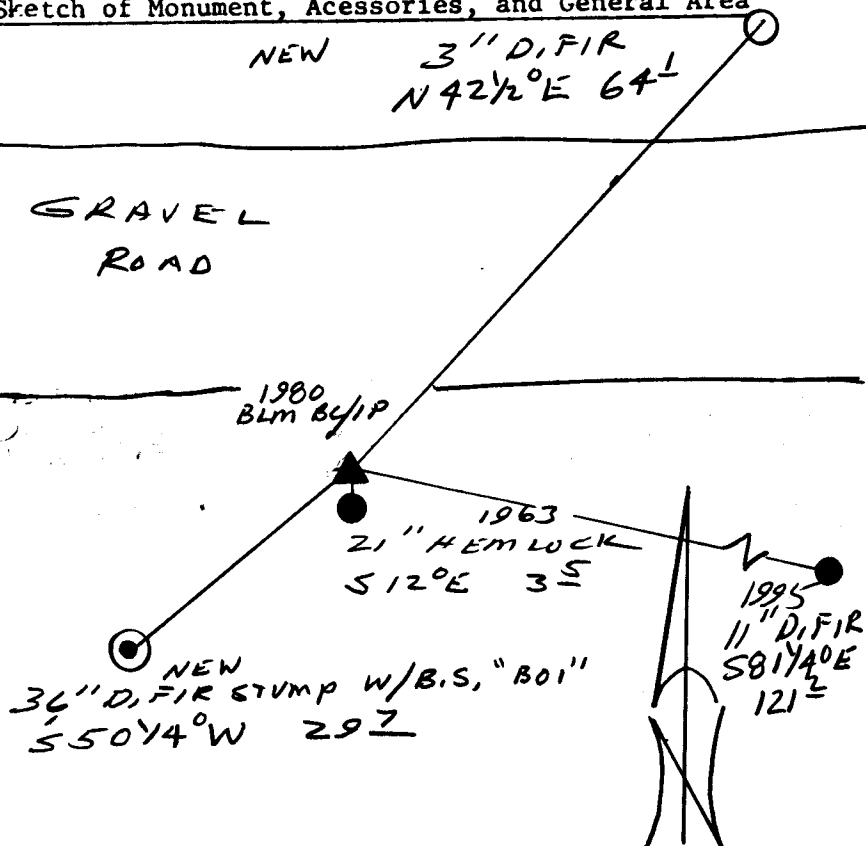

Location & Comments

Comp. Declin. 17 3/4° E

Agency OLSO

Party Chief RANDALL W SMITH

Notekeeper [Signature]

Witnesses STEPHEN J FLAUS

Address _____

Surveyor's Seal

REGISTERED
PROFESSIONAL
LAND SURVEYOR

Randall W Smith
EXPIRES 6-30-98

OREGON
JULY 25, 1980
RANDALL W. SMITH
2469