

GOVERNMENT CORNER RESTORATION FORM

Date: 7-31-96 By: BC

This survey consists of:

Township 26 S Range 7 W Sec. 13 County DOUGLAS Map: _____

State OR Date 7-17-96 No. _____

Narrative: _____

Corner Rpt: CS 64/69-13

Corner Designation

1/4 S14 | S13

DOUGLAS COUNTY SURVEYOR

Condition Report Only

Not Found

Renewed

Unrecorded

Surveyed In

Referenced Out

MONUMENT DETAIL

PI# 600440

Previous Renewals 1922 + 1966 DCSO

Monument(s) Found: (Condition and Source)

2 1/2" BRASS CAP ON A 1 1/2" O.D. IRON PIPE PROTRUSING 10" ABOVE A 3 FT DIA. MOUND OF STONE. (1966)

COUNTY SURVEYORS OFFICE

T26S

1/4 S14 | S13

R7W

1966

Accessories Found:

NO EVIDENCE OF ORIG. RT'S FD

NO EVIDENCE OF NW BT FROM 1922 RENEWAL FD

18" NOW 27" DIA. W. OAK WITH A PREVIOUSLY OPENED UNHEALED BLAZE, NO SCRIBING VISIBLE, BEARS N19°E 39.2 FT (AGREES WITH REC.) 1922

17" NOW 19" DIA. W. OAK (REC. B. OAK) WITH A FULLY HEALED DOUBLE BLAZE, BEARS S63°E, 24.6 FT. (AGREES WITH REC.) 1966

7" NOW 9" DIA. W. OAK (REC. B. OAK) WITH A FULLY HEALED DOUBLE BLAZE, BEARS N25°W, 12.3 FT (AGREES WITH REC.) 1966

Monument Set (Procedure and Description)

NONE

Monument Detail

N/A

New Accessories

7" W. OAK DOUBLE BLAZED AND SCRIBED "1/4 S 1/4 CS BT"
BEARS N74°W 19.7 FT

Sketch of Monument, Accessories, and General Area

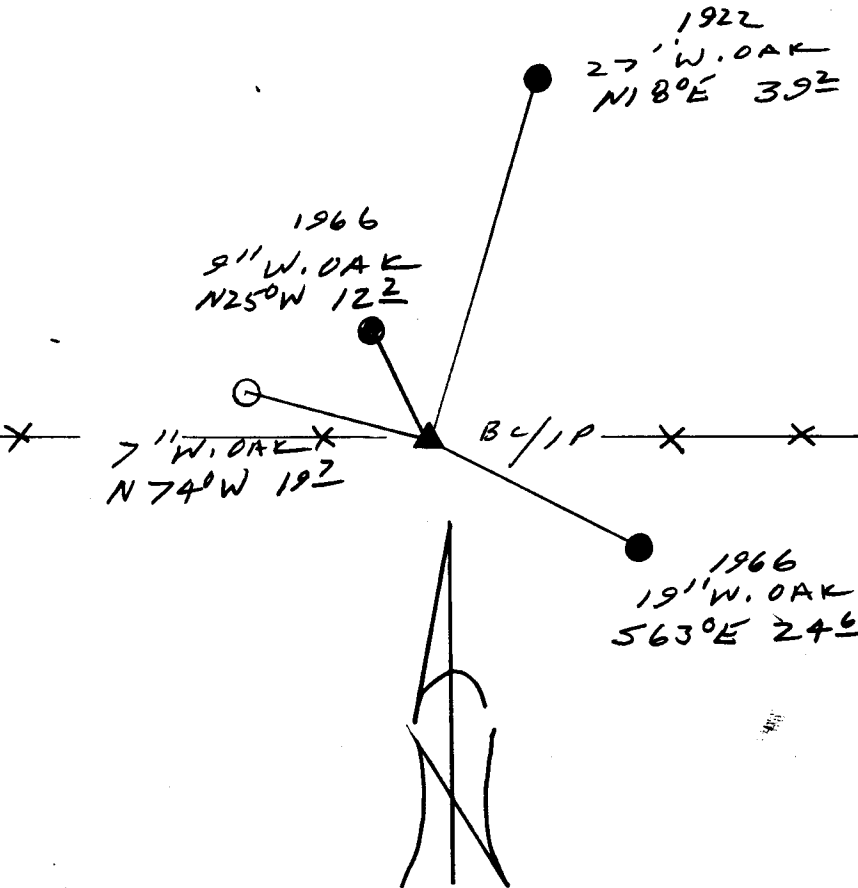

Location & Comments

CORNER LIES IN AN EAST - WEST FENCE LINE APPROX 50 FT EAST OF RIDGE TOP

Comp. Declin. 17 3/4' E
Agency DCSO
Party Chief RANDALL W SMITH
Notekeeper Randall W Smith
Witnesses STEPHEN J FLAUSE

Address

Surveyor's Seal

REGISTERED PROFESSIONAL LAND SURVEYOR

Randall W Smith
6-30-98

OREGON
JULY 25, 1990
RANDALL W. SMITH
2469