

GOVERNMENT CORNER RESTORATION FORM

FILED

Date: 6/25/96 By: PC

Township 25S Range 7W Sec. 26 County DOUGLAS This survey consists of:

State OR Date 6-18-96 No. _____ Map: _____

Corner Designation Narrative: _____

Corner Rpt: 64/69-6

527/S26
534/S35

- ~~Cor~~ DOUGLAS COUNTY
- Not Found SURVEYOR
- Renewed
- Unrecorded
- Surveyed In
- Referenced Out

Previous Renewals 1975 BLM PL# 50020

Monument(s) Found: (Condition and Source)

3 1/2" DIA BRASS CAP ON AN IRON
PIPE IS FOUND 12" BELOW
GROUND. (1975 BLM)

DEPT. OF THE INTERIOR
T 25S R 7W

527/S26
534/S35

1975

BUR. OF LAND MANAGEMENT

Accessories Found:

12" NOW 45" DIA B. OAK WITH A PREVIOUSLY OPENED
UNHEALED BLAZE NO SCRIBING VISIBLE, BEARS
N18°W, 32.3 FT (REC N70°W 33.7 FT) OBT

15" DIA B. OAK NOW ROOT HOLE FOUND NEAR REC
BAG. + DIST (N65°E, 27.7 FT) OBT

NO EVIDENCE OF ANY OTHER OBT'S FOUND

11" NOW 15" DIA D. FIR WITH A FULLY HEALED SINGLE BLAZE
BEARS N56°E, 109.8 FT (REC N56°E, 110.9 FT DIST FITS
WELL WITH A SLOPE MEASUREMENT) 1975 BLM

13" NOW 18" DIA D. FIR WITH A FULLY HEALED SINGLE BLAZE
BEARS N29 1/2°W, 198.5 FT. (AGREES WITH REC) 1975 BLM

34" NOW 46" DIA B. OAK WITH A FULLY HEALED SINGLE BLAZE
BEARS S16 1/2°E, 278.5 FT. (AGREES WITH REC) 1975 BLM

C.S. File No. 64/69-6

Monument Set (Procedure and Description)

Monument Detail

NONE

N/A

New Accessories

NONE

Sketch of Monument, Accessories, and General Area

Location & Comments

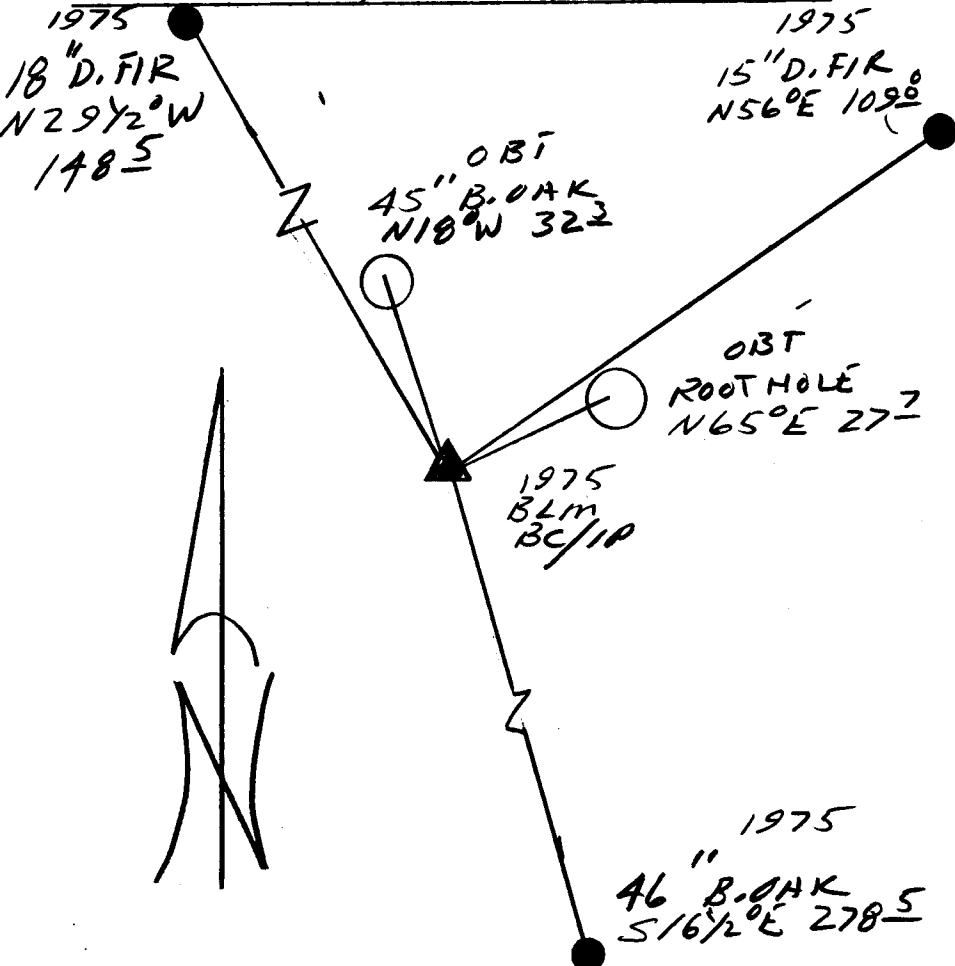

Comp. Declin. 17 3/4° E
 Agency DES
 Party Chief RANDALL W SMITH
 Notekeeper Randall W Smith
 Witnesses STEPHEN J FLAUSÉ

Address _____

REGISTERED
 PROFESSIONAL
 LAND SURVEYOR

Randall W Smith
 EXPIRES 6-30-96

OREGON
 JULY 25, 1990
 RANDALL W. SMITH
 2469