

GOVERNMENT CORNER RESTORATION FORM

Date: 6/12/96 By: BC

Township 31S Range 6W Sec. 15 County DOUGLAS

This survey consists of:

State OR Date 6-10-96 No. _____

Map: _____

Narrative: _____

Corner Designation _____

Corner Rpt: CS 64/69-1

DOUGLAS COUNTY

Condition SURVEYOR Only

Not Found

Renewed

Unrecorded

Surveyed In

Referenced Out

MONUMENT DETAIL

$\frac{1}{4} \frac{S15}{S22}$

Previous Renewals 1964 DCSO

Monument(s) Found: (Condition and Source)

2 1/2" BRASS CAP ON A 1 1/4" O.D. IRON PIPE PROTRUDES 7" ABOVE GROUND. (1964 DCSO)

COUNTY SURVEYORS OFFICE

T 3 Q 5

$\frac{1}{4} \frac{S15}{S22}$

R 6 W

1964

Accessories Found:

D. FIR

22" NOW 30" DIA 20 FT HIGH SNAG NO BARK SCRIBING FOUND, BEARS S 72° W 15.8 FT (AGREES WITH REC.) 0BT

22" NOW 34" DIA. D. FIR NO BARK SCRIBING FOUND BEARS N 60° E, 7.9 FT (AGREES WITH REC.) 0BT

19" NOW 22" DIA 1 1/2' HIGH D. FIR STUMP WITH A FULLY HEALED BLAZE, BEARS S 40° W, 27.9 FT. (AGREES WITH REC) 1964

12" NOW 20" DIA 3 FT HIGH SHATTERED D. FIR STUMP, SCRIBING VISIBLE "15 CS", BEARS N 10° W 47.5 FT (AGREES WITH REC) 1964

Monument Set (Procedure and Description)

Monument Detail

NONE

N/A

New Accessories

5" DIA. D. FIR DOUBLE BLAZED AND SCRIBED "1/4S 15 CS BT"
BEARS N 83° W 11.6 FT

7" DIA. D. FIR DOUBLE BLAZED AND SCRIBED "1/4S 22 CS BT"
BEARS S 16° E 15.3 FT

6" DIA. D. FIR DOUBLE BLAZED AND SCRIBED "1/4S 22 CS BT"
BEARS S 76° E 10.3 FT

Sketch of Monument, Accessories, and General Area

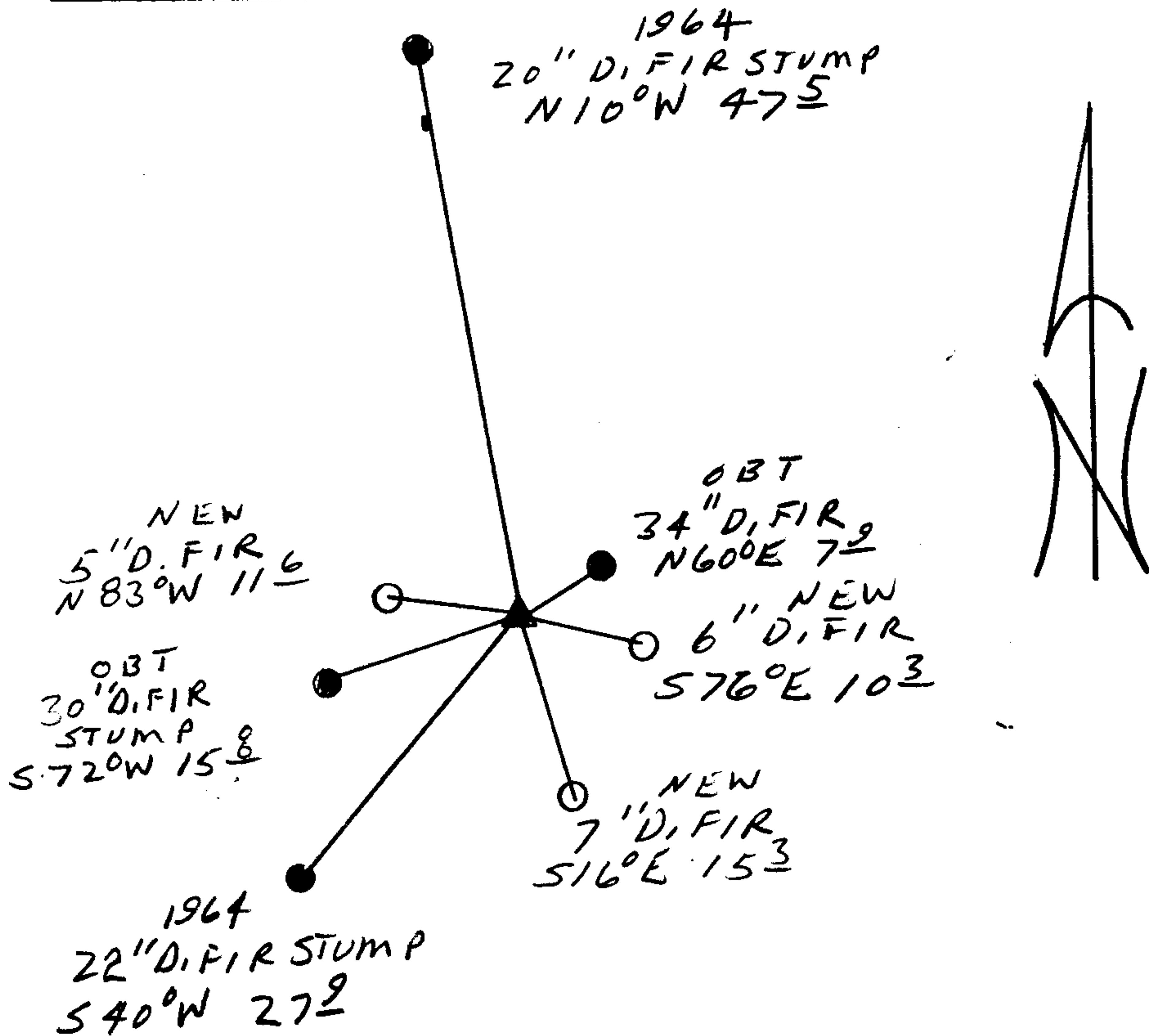

Location & Comments

Comp. Declin. 17 3/4° E
 Agency DCSO
 Party Chief RANDALL W SMITH
 Notekeeper Randall W Smith
 Witnesses STEPHEN J FLAUSE

Address

Surveyor's Seal

REGISTERED
 PROFESSIONAL
 (LAND SURVEYOR)

Randall W Smith
EXPIRES 6-30-96

OREGON
 JULY 25, 1990
 RANDALL W. SMITH
 2489