

GOVERNMENT CORNER RESTORATION FORM

Date: 4/25/96 By: AC

Township 24S Range 4W Sec. 26 County DOUGLAS This survey consists:

State OR Date 2-15-96 No. _____ Map: _____

Corner Designation

S27 | S26

S34 | S35

Narrative: _____
Corner Rpt: CS 64/66-10

DOUGLAS CO. SURVEYOR
Condition of Report Only
 Not Found
 Renewed
 Unrecorded
 Surveyed In
 Referenced Out

MONUMENT DETAIL

Previous Renewals 1972, 1985 BLM

Monument(s) Found: (Condition and Source)

NONE (POSITION OF CORNER FALLS IN OLD SLASH PILE, UNABLE TO LOCATE BLM BC/IP WITH METAL DETECTOR)

N/A

Accessories Found:

- 6" NOW 8" DIA DOWN AND ROTTED D. FIR WE OPEN AND FIND SCRIBE MARKS "BT" ROOT CROWN BEARS N 17 1/4° W, 62.7 FT (AGREES WITH REC) 1985 BLM
- 11" NOW 18" DIA. D. FIR WITH A FULLY HEALED SINGLE BLAZE BEARS S 33° E, 310.9 FT (AGREES WITH REC) 1985 BLM
- 12" NOW 16" DIA D. FIR WITH A FULLY HEALED SINGLE BLAZE BEARS N 73° E, 406.6 FT (AGREES WITH REC) 1985 BLM
- 22" NOW 27" DIA 1 1/2 FT HIGH D. FIR STUMP WITH A FULLY HEALED BLAZE, BEARS S 12 3/4° W, 262.7 FT (AGREES WITH REC) 1985 BLM.

DATE 2-22-96

RENEWAL

Monument Set (Procedure and Description)

Monument Detail

POSITION FOR CORNER IS DETERMINED FROM B.M. 1985 BT'S AS SHOWN ON FRONT. A 2 3/8" DIA BRASS CAP ON A 1 3/8" O.D. BY 32" LONG IRON PIPE IS SET FOR CORNER. BC/IP PROTRUDS 4" ABOVE GROUND. MONUMENT IS SURROUNDED BY A 2 FT DIA MOUND OF STONE

DOUGLAS COUNTY SURVEYORS

T 24 S
R
527 | 526
534 | 535
A
W

1996

OFFICE

New Accessories

6" DIA. D. FIR DOUBLE BLAZED AND SCRIBED "T 24 S R 4 W
S 27 C S BT", BEARS N 80 1/2° W, 42.5 FT

10" DIA. D. FIR DOUBLE BLAZED AND SCRIBED "T 24 S R 4 W
S 34 C S BT", BEARS S 24 1/2° W, 95.0 FT

Sketch of Monument, Accessories, and General Area

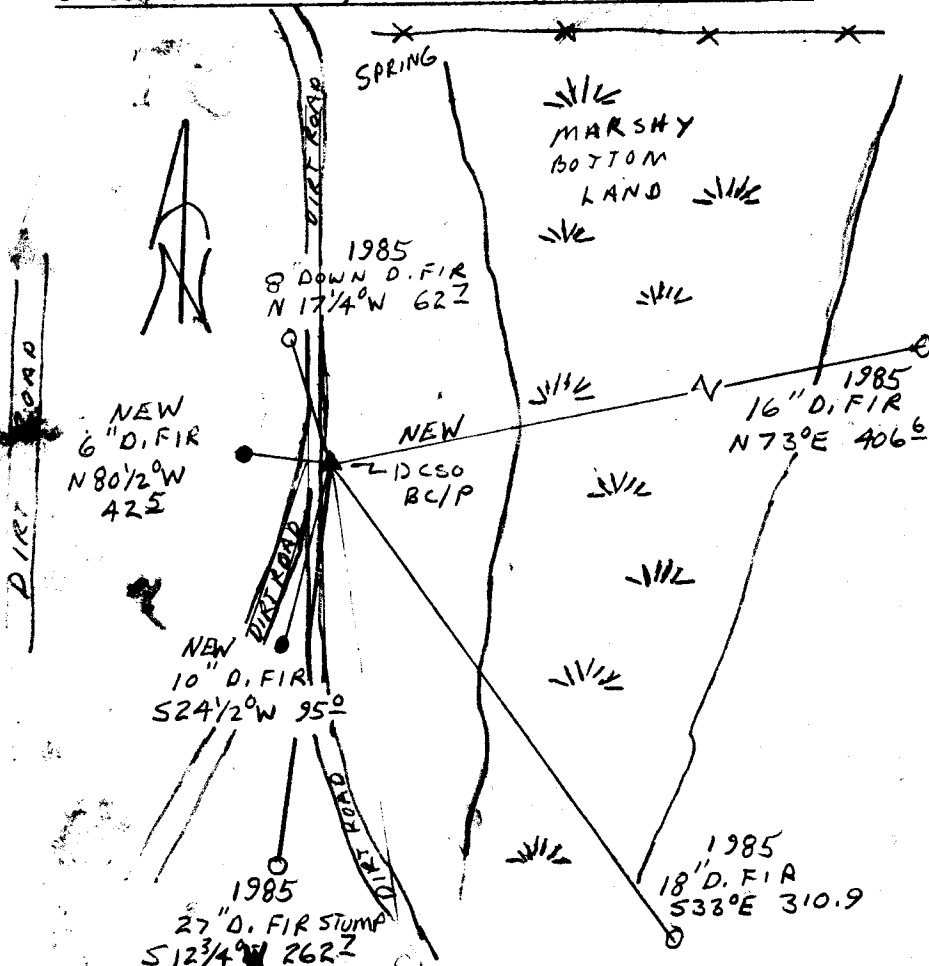

Location & Comments

CORNER LIES APPROX. 30' EAST OF THE INTERSECTION OF DIRT ROADS

Comp. Declin. 17 3/4° E
Agency DCSO
Party Chief RANDALL W. SMITH
Notekeeper [Signature]
Witnesses STEPHEN J. FRAUSE

Address

Surveyor's Seal
REGISTERED
PROFESSIONAL
LAND SURVEYOR
[Signature]
EXPIRES 6-30-96
OREGON
JULY 25, 1990
RANDALL W. SMITH
2489