

GOVERNMENT CORNER RESTORATION FORM

Date: 4/25/96 By: As

Township 33S Range 6W Sec. 5 County DOUGLAS This survey consists of:

State OR Date 9-21-93 No. \_\_\_\_\_ Map: \_\_\_\_\_

Corner Designation \_\_\_\_\_ Narrative: \_\_\_\_\_  
Corner Rpt: CS 64/66-7

- DOUGLAS COUNTY SURVEYOR
- Condition: Survey Only
  - Not Found
  - Renewed
  - Unrecorded
  - Surveyed In
  - Referenced Out

56 | 55 203100

1882 BYARS COR.

Previous Renewals NONE

Monument(s) Found: (Condition and Source)

ORIG. FIR POST NOT FOUND

N/A

Accessories Found:

20" NOW 34" DIA 2 FT HIGH ROTTED D. FIR STUMP, NO BLAZES OR SCRIBING, BEARS N 1° E, 35.8 FT (REG N 1° E, 35.0 FT DISTANCE FITS WELL TO A FACE MEASUREMENT) ORIG. BT

14" NOW 20" DIA 2 1/2 FT HIGH ROTTED D. FIR STUMP, SCRIBING FOUND "BT" BEARS S 13° E, 27.7 FT (REG S 13° E, 27.0 FT DISTANCE FITS WELL TO A FACE MEASUREMENT) ORIG. BT

16" NOW 24" DIA 2 1/2 FT HIGH ROTTED D. FIR STUMP, SCRIBING FOUND "BT" FACING NORTHWEST, NO BLAZES OR SCRIBING FOUND ON NORTHEAST FACE BEARS S 28° W, 19.5 FT (REG S 28° W, 19.1 FT DISTANCE FITS WELL TO A FACE MEASUREMENT) ORIG. BT

NOTE: THIS STUMP IS AN ORIG. BT TO HYDE & GARDNER 1855 NORTH TOWNSHIP LINE OF T 33 S (13" FIR S 68° E 78 LKS)

MONUMENT DETAIL

Monument Set (Procedure and Description)

Monument Detail

A 2 3/8" DIA DCSO BRASS CAP  
 ON A 1 3/8" BY 32" LONG IRON  
 PIPE IS SET FROM ORIG.  
 BRGS AND FACE DISTANCES  
 TO ORIG. BT'S. BC/IP PROTRUDES  
 8" ABOVE GROUND

1" DIA IRON BAR PROTRUDING 4"  
 ABOVE GROUND BEARS N 88 3/4° W,  
 57.1 FT FROM BC/IP (IRON BAR  
 FROM REN #13)

DOUGLAS COUNTY SURVEYORS

T 325

\_\_\_\_\_ R  
 56 | 55 6  
 \_\_\_\_\_ W

T 335

1993  
 OFFICE

New Accessories

7" DIA. MADRONE BARK SCRIBED "T335 R6W 55CS BT"  
 BEARS S 59 1/2° E, 23.9 FT TO CENTER OF ROOT CROWN

9" DIA. D. FIR DOUBLE BLAZED AND SCRIBED "T335 R6W 55CS BT"  
 BEARS S 46 1/2° E, 6.6 FT.

10" DIA. D. FIR DOUBLE BLAZED AND SCRIBED "T335 R6W 56CS BT"  
 BEARS S 31 1/2° W, 14.4 FT

7" DIA. D. FIR DOUBLE BLAZED AND SCRIBED "T335 R6W 56CS BT"  
 BEARS S 79 1/2° W, 4.9 FT

Sketch of Monument, Accessories, and General Area

Location & Comments

\_\_\_\_\_

\_\_\_\_\_

\_\_\_\_\_

\_\_\_\_\_

\_\_\_\_\_

\_\_\_\_\_

Comp. Declin. 18° E

Agency DCSO

Party Chief LARRY E MONRIAN

Notekeeper Randall W Smith

Witnesses STEPHEN J FLAISE

Address

\_\_\_\_\_

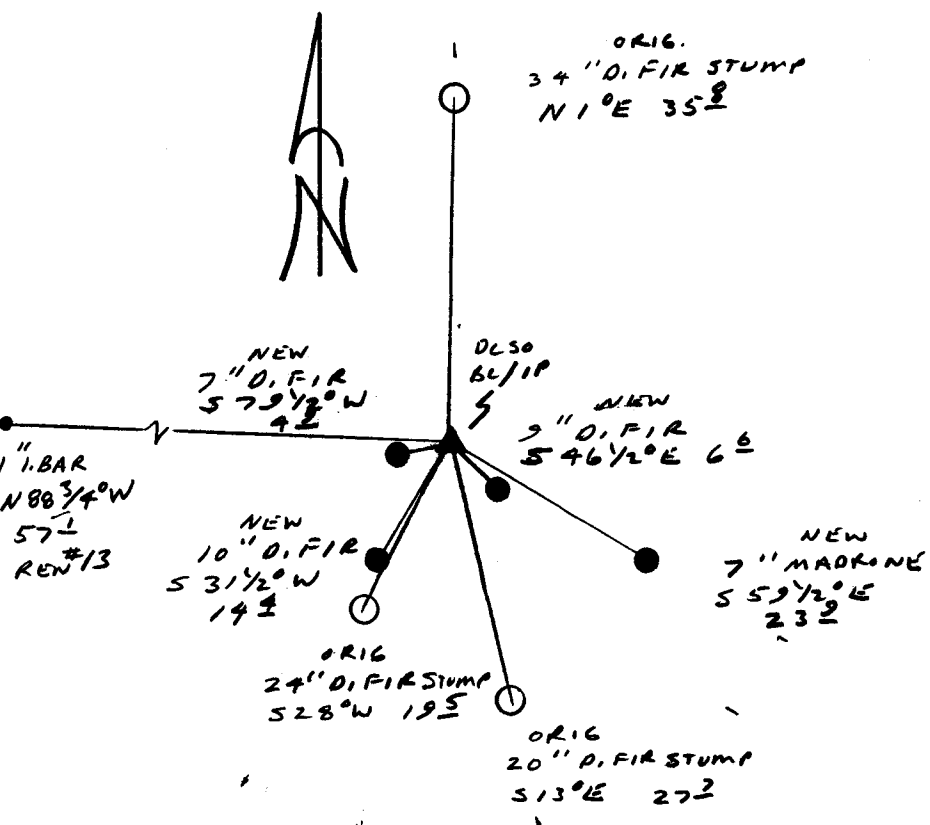

REGISTERED Surveyor's Seal

PROFESSIONAL  
 LAND SURVEYOR

*Randall W Smith*  
 EXPIRES 12-31-94

OREGON  
 JULY 25, 1990  
 RANDALL W. SMITH  
 2469

9-22-93  
Rwd

MEASUREMENTS TAKEN WITH A STAFF COMPASS AND RAIL TAPE

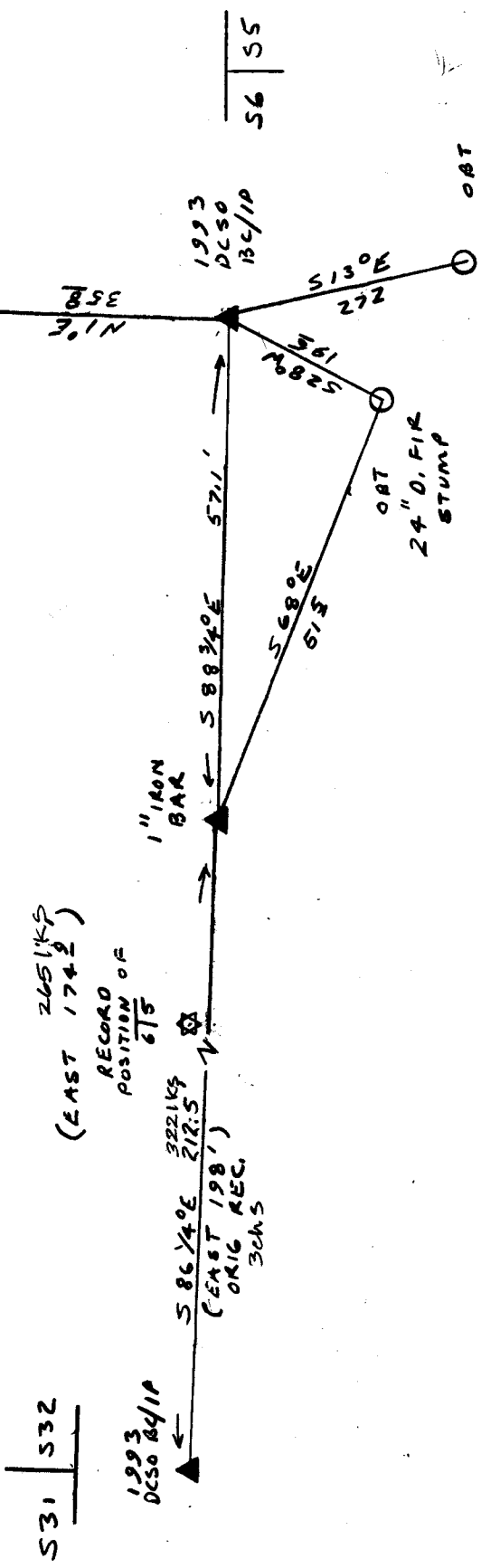

REGISTERED  
 PROFESSIONAL  
 LAND SURVEYOR  
*Randall W. Smith*  
 EXPIRES 12-31-94  
 OREGON  
 JULY 25, 1990  
 RANDALL W. SMITH  
 2489

