

GOVERNMENT CORNER RESTORATION FORM

FILED

Township 235 Range 7W Sec. 20 County DOUGLAS

Date: 12/20/95 By: BC

This survey consists of:

State OR

Date 12-13-95

No. _____

Map: _____

Narrative: _____

Corner Rpt: CS 64/64-12

Corner Designation

S20 | S21

S29 | S28

Condition DOUGLAS COUNTY

Not Found SURVEYOR

Renewed

Unrecorded

Surveyed In

Referenced Out

Previous Renewals #45 #163 AND 1963, 1979 BLM

MONUMENT DETAIL

Monument(s) Found: (Condition and Source)

3/4" DIA BLM BRASS CAP ON A
2 1/2" O.D. IRON PIPE PROTRUDING
6" ABOVE GROUND. (1963 BLM)

5/8" IR PROTRUDING 3" ABOVE
GROUND IS FOUND ALONG
NORTHEASTERY EDGE OF BLM BC/IP
(REN #45)

U.S. DEPT. OF THE INTERIOR

T23S R7W

S20 | S21

S29 | S28

1963

BUR. OF LAND MANAGEMENT

Accessories Found:

10" NOW DOUBLE TRUNKED W/OAK WITH A FULLY HEALED
DOUBLE BLAZE ON 20" DIA SOUTHERLY TRUNK, ROOT CROWN
OF SOUTHERLY TRUNK BEARS N11 1/2°W, 10.6 FT (AGREES WITH REC)
REN #45

10" NOW 22" DIA. W/OAK WITH A FULLY HEALED DOUBLE BLAZE,
BEARS S88°E, 72.6 FT ROOT CROWN (REC. S88°E, 71.9
GOES TO CENTER OF TRUNK) REN #45

DOUBLE TRUNKED MAPLE, 20" NOW 41" DIA. WESTERLY TRUNK
WITH A FULLY HEALED BLAZE ON WESTERLY TRUNK, BEARS
N85°E, 123.4 FT TO ROOT CROWN OF WESTERLY TRUNK.
1963 BLM

15" NOW DOWN WITH A ROOTED APPROX 24" DIA ROOT WAD
BEARS S65 1/2°W 124.1 FT (AGREES WITH REN 163
REC) 1963 BLM (A SMALL ILLIGIBLE SCRIBE
MARK WAS FOUND IN DOWN TRUNK)

C.S. File No: 64/64-12

Monument Set (Procedure and Description)

Monument Detail

N/A

N/A

New Accessories

21" DIA W. OAK DOUBLE BLAZED AND SCRIBED "T235 R7W
S29 CS BT", BEARS S58°W, 184.7 FT

Sketch of Monument, Accessories, and General Area

Location & Comments

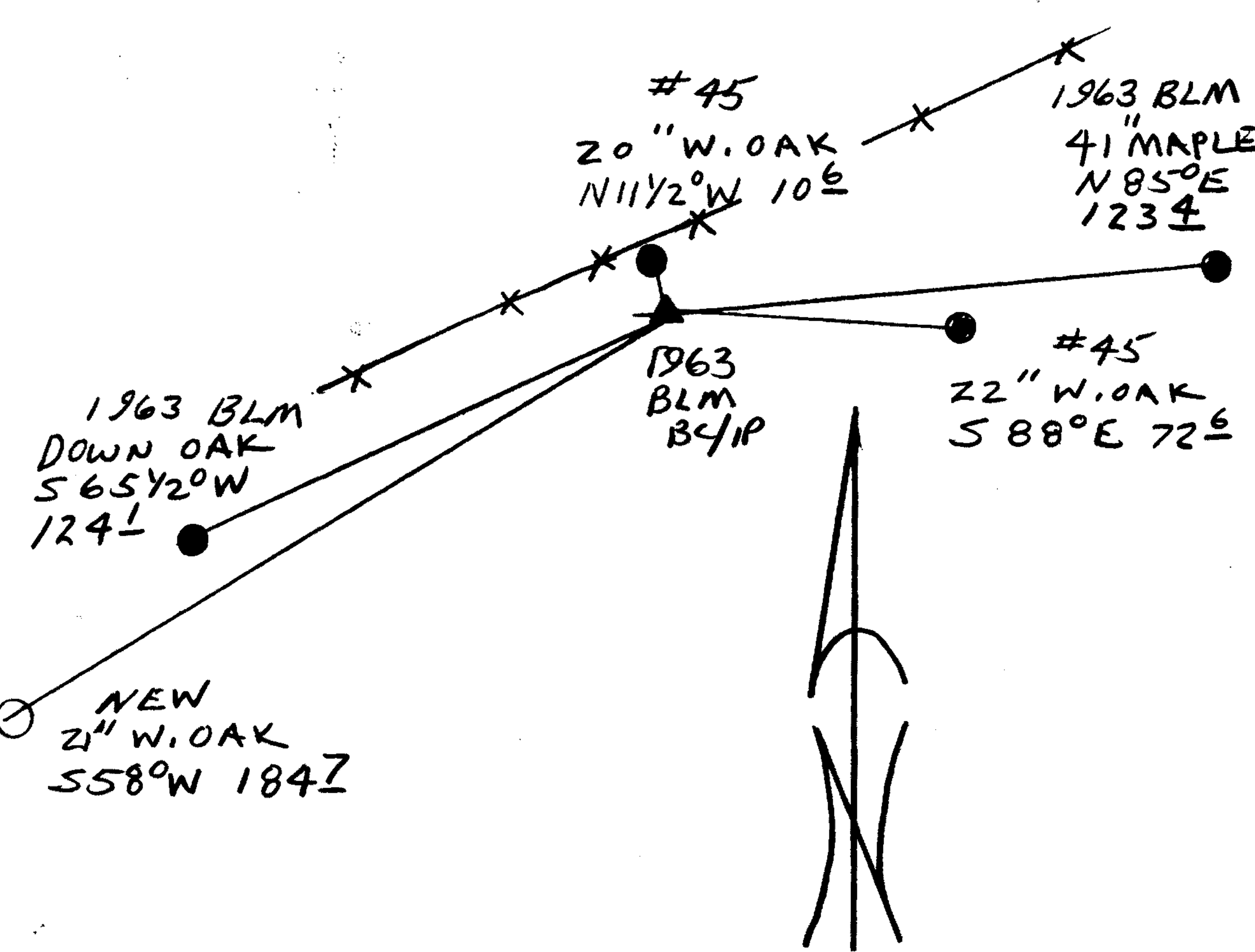

Comp. Declin. 17 3/4° E
 Agency DCSO
 Party Chief RANDALL W SMITH
 Notekeeper Randall W Smith
 Witnesses STEPHEN J FLAUS

Address

Surveyor's Seal
 REGISTERED
 PROFESSIONAL
 LAND SURVEYOR

Randall W Smith
 EXPIRES 6-30-96

OREGON
 JULY 25, 1990
 RANDALL W. SMITH
 2469