

Monument Set (Procedure and Description)

2 3/8" DIA BRASS CAP ON A
 1 1/8" O.D. BY 32" LONG IRON
 PIPE IS SET AT A POSITION
 DETERMINED FROM EVIDENCE
 OF REMAINING ORIG. BT.
 EX/1P PROTRUDES 5" ABOVE
 GROUND.

Monument Detail

DOUGLAS COUNTY SURVEYORS
 T 245

1/4 $\frac{523}{526}$ R
 4
 W

1995
 OFFICE

New Accessories

10" DIA. D. FIR DOUBLE BLAZED AND SCRIBED "1/4 S23 CS BT", BEARS
 N 79°E, 11.3 FT.
 12" DIA. B. OAK DOUBLE BLAZED AND SCRIBED "1/4 S26 CS BT" BEARS
 S 26°W, 36.6 FT.
 4" DIA. D. FIR DOUBLE BLAZED AND SCRIBED "X BT" BEARS N 44°W, 7.8 FT.
 9" DIA. D. FIR DOUBLE BLAZED AND SCRIBED "1/4 S26 CS BT" BEARS
 S 13 1/2°E, 11.6 FT.

Sketch of Monument, Accessories, and General Area

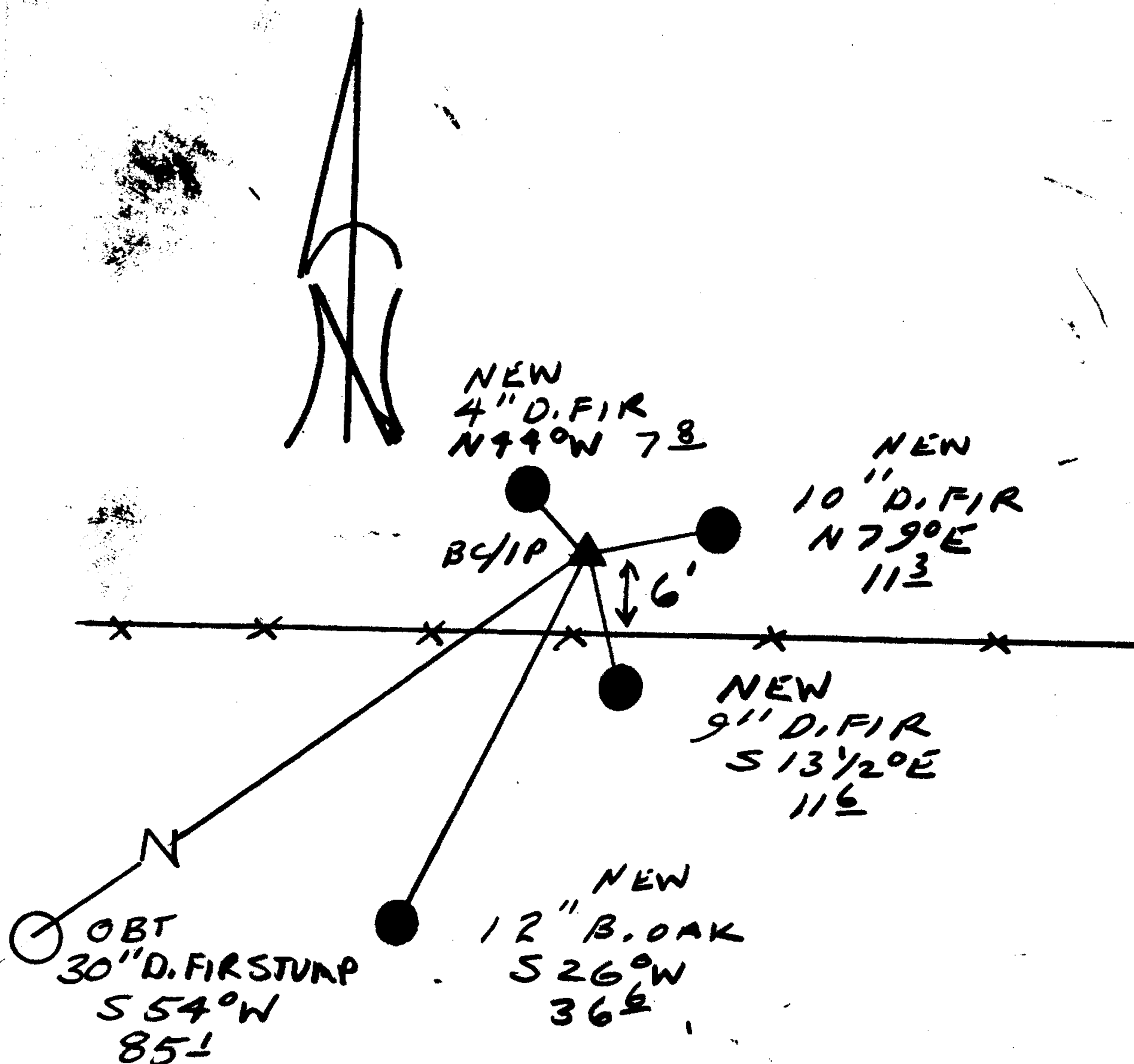

Location & Comments

CORNER LHS 6' NORTH
 OF AN EAST-WEST
 FENCE LINE

HARVEY CHRISTENSEN SURVEY
 CREW HAD RECENTLY
 FOUND ORT

Comp. Declin. 17 3/4° E
 Agency DCSD
 Party Chief RANDALL W SMITH
 Notekeeper *Randall W Smith*
 Witnesses STEPHEN J FLAUS

Address

Surveyor's Seal

REGISTERED
 PROFESSIONAL
 LAND SURVEYOR

Randall W Smith
 EXPIRES 6-30-96

OREGON
 JULY 25, 1990
 RANDALL W. SMITH
 2489