



RENEWAL

Monument Set (Procedure and Description)

Monument Detail

NONE

- HARVEY CHRISTENSEN INDICATED THAT POSITION OF THIS TREE IS LESS THAN 20 FT FROM A PROPORTIONED IN POINT.
- POSITION OF ORIG. SW BT WOULD FALL IN SKID ROAD NO EVIDENCE FOUND.

N/A

New Accessories

NONE

Sketch of Monument, Accessories, and General Area

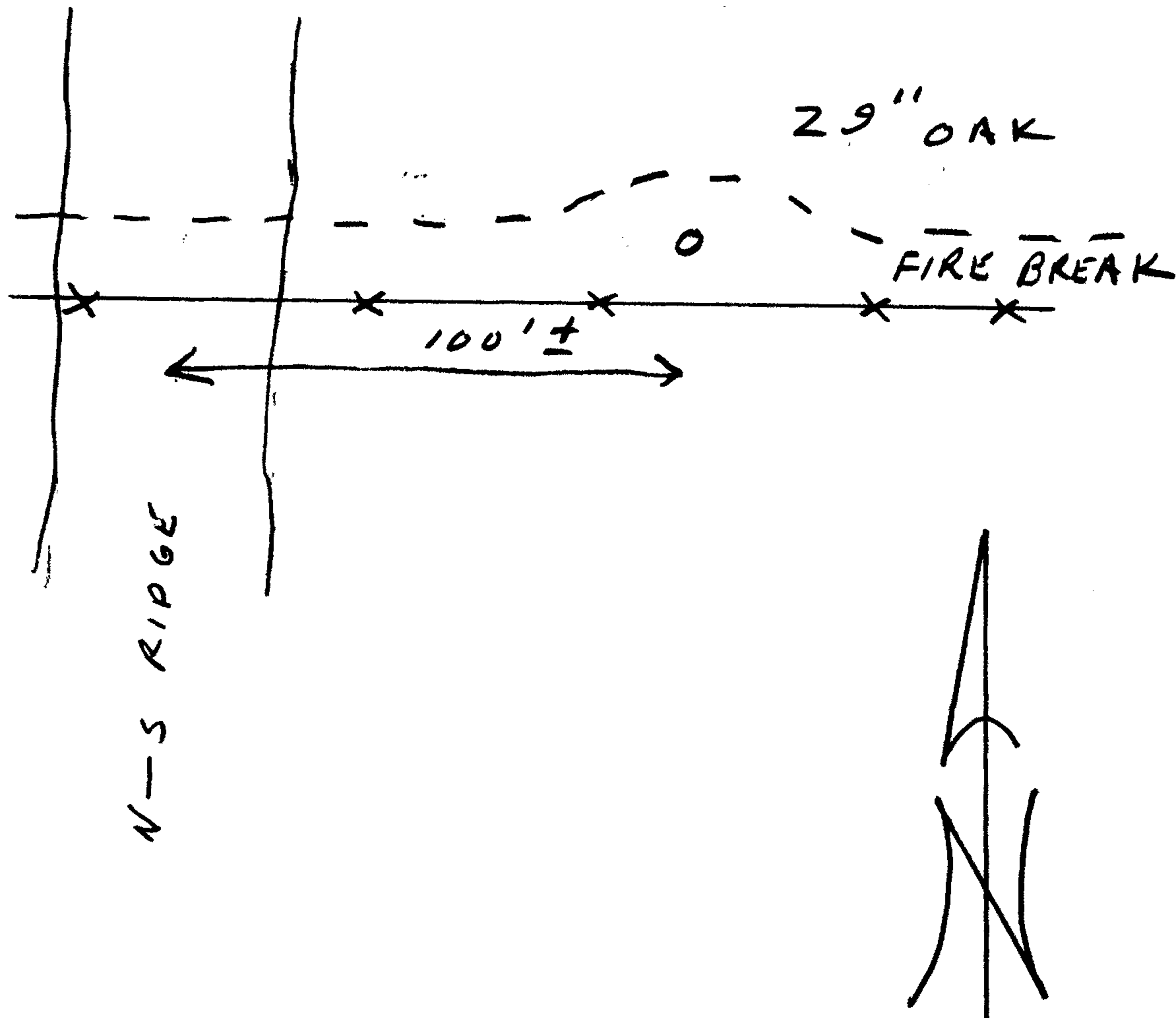

Location & Comments

HARVEY CHRISTENSEN INDICATES THAT  $\frac{1}{4}$  WOULD BE SET FROM THIS TREE.

Comp. Declin. 17 3/4° E  
 Agency DCSO  
 Party Chief RANDALL W. SMITH  
 Notekeeper Randall W. Smith  
 Witnesses STEPHEN J. FLAUSE  
HARVEY CHRISTENSEN  
RON

Address

Surveyor's Seal

REGISTERED PROFESSIONAL LAND SURVEYOR

*Randall W. Smith*  
EXPIRES 6-30-96

OREGON  
JULY 25, 1990  
RANDALL W. SMITH  
2469