

GOVERNMENT CORNER RESTORATION FORM

FILED

Township 28S Range 3W Sec. 34

Date: 12/7/95 By: BC
County DOUGLAS This survey consists of:

State OR Date 10-12-95 No. _____

Map: _____
Narrative: _____
Corner Rpt: C5 64/64-3

Corner Designation

1/4 S34 | S35

DOUGLAS COUNTY
Condition Report Only
Not Found
 Renewed
Unrecorded
Surveyed In
Referenced Out

Previous Renewals DCSO REN #83 1962, 1994 CARTER

Monument(s) Found: (Condition and Source)

2 1/2" DIA. DCSO BRASS CAP ON A
1 1/2" O.D. IRON PIPE PROTRUDING
17" ABOVE GROUND (REN #83)
6" X 8" X 14" GRANITE STONE
WITH THE MARKS "1/4" ON
SOUTH FACE IS FOUND ALONG
SOUTH EDGE OF BC/PP. (ORIG.
CORNER STONE) NOTE: CORNER
STONE NOTED AS NOT FOUND
AN REN #83, NOT MENTIONED
IN 1994 RENEW BY RICK CARTER.

MONUMENT DETAIL
see attached copy

COUNTY SURVEYORS
T 28S
1/4 S34 | S35 R
3
W
1962
OFFICE

Accessories Found:

- 24" NOW 36" DIA 2 FT HIGH BURNT CEDAR STUMP
WITH EVIDENCE OF A LOWER BLAZE NO SCRIBING
VISIBLE, BEARS S35°W, 7.3 FT TO BLAZE, METAL FC
POST NEAR CENTER BEARS S41°W, 7.9 FT AS NOTED IN 1994
RENEWAL (AGREES WITH REC) OBT.
- 10" NOW 28" DIA 1 FT HIGH BURNT CEDAR STUMP,
NO BLAZING OR SCRIBING, CENTER BURNT OUT, BEARS
S76°E, 29.0 FT TO CENTER, (REC S74°E, 27.7 FT) OBT
- 10" NOW 10" DIA. D. FIR WITH UNHEALED DOUBLE
BLAZE, SCRIBING VISIBLE "1/4 35 BT" BEARS
N62°E, 1.7 FT (AGREES WITH REC) 1994 RENEWAL

✓169

REC'D JUN 30 1994

6-29-94

GENTLEMEN:

PLEASE ACCEPT THE FOLLOWING INFORMATION
CONCERNING THE REREFERENCING OF THE CORNER SHOWN
BELOW

RICH CARTER

6-24-94

1/4 COR 34 | 35 T285 R3W

FOUND OLD LOCATION TAG ON
38" DIA. INCENSE CEDAR STUMP

WITH 5 FT STEEL FENCE POST
AT CENTER BEARS S41W
7.9 FEET STUMP PAINTED
ORANGE WITH TAG ON STUMP

SCRIBED TAGGED AND PAINTED

10" D.BH. DOUGLAS FIR BEARS N62°E
1 7/8 FEET SCRIBED 1/4 S35 BT
TREE IS TAGGED & PAINTED ORANGE

MONUMENT IS 2" BC OLD 1" G.I.P.
MARKED

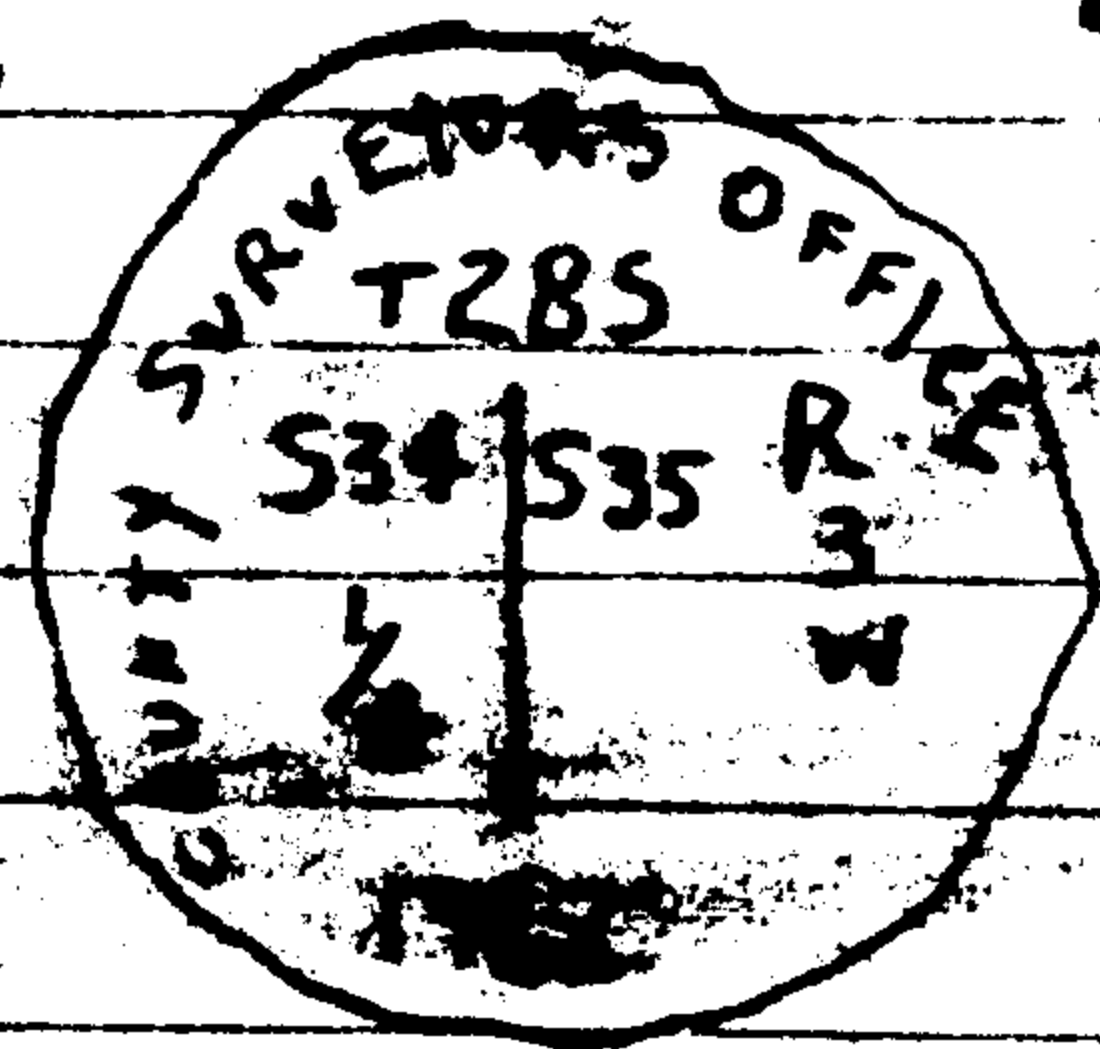

PUT 5 FT STEEL FENCE POST BEARS NORTH
1 FOOT

PUT LOCATION TAG ON 7" D. FIR ON EAST
SIDE OF SPUR #1 BEARS N52W 6 FT
RICH CARTER 6-24-94