

GOVERNMENT CORNER RESTORATION FORM

Date: 10/11/95 By: PC

Township Z3S Range 9W Sec. 23

County DOUGLAS Map: \_\_\_\_\_

This survey consists of:

State OR

Date 10-3-95

No. \_\_\_\_\_

Narrative: \_\_\_\_\_  
Corrler Rpt: CS 64/64

Corner Designation

1/5 23  
1/4 526

DOUGLAS COUNTY  
SURVEYOR

- Condition Report Only
- Not Found
- Renewed
- Unrecorded
- Surveyed In
- Referenced Out

Previous Renewals #75

Monument(s) Found: (Condition and Source)

5/8" IR WITH YELLOW PLASTIC  
CAP MARKED "PE 6245" BENT,  
PROTRUDES 17" ABOVE GROUND,  
(REN # 75)

BENT FENCE POST PROTRUDES  
30" ABOVE GROUND. HAS  
A BLM TAG ATTACHED DATE  
1973

N/A

Accessories Found:

6" NOW 35" D. FIR WITH A PREVIOUSLY OPENED BLAZE  
SCRIBING VISIBLE "4" BEARS S 55° E, 23.8 FT  
(AGREES WITH REC) O.B.T.

30" NOW 28" DIA 4 FT HIGH BROKEN AND ROTTED  
D. FIR STUMP BEARS N 38° E, 13.1 FT TO CENTER  
CORIG REC N 38° W 11.2 FT, REN # 75 N 38° E 11.2 FT  
DIST IS A POSSIBLE FACE MEASUREMENT) O.B.T.?

37" NOW 37" DIA 5 FT HIGH D. FIR STUMP WITH  
A PARTIALLY HEALED SINGLE BLAZE, SCRIBING VISIBLE  
"14" BEARS N 16° W, 16.2 FT (AGREES WITH REC)  
REN # 75

RENEWAL

Monument Set (Procedure and Description)

POSITION OF FENCE POST AND  
 5/8" I.R. IS REFERENCED AND  
 A 2 3/8" DIA BRASS CAP ON 1 3/8" O.D.  
 BY 32" LONG IRON PIPE IS SET  
 AT REFERENCED POSITION. BC/IP  
 PROTRUDES 10" ABOVE GROUND.

FENCE POST IS RESET ALONG  
 NORTH EDGE OF BC/IP, PROTRUDES  
 36" ABOVE GROUND (5 FT LONG)

5/8" I.R. IS SET ALONG SOUTH EDGE  
 OF BC/IP, PROTRUDES 10" ABOVE  
 GROUND. (3 FT LONG)

CORNER IS SURROUNDED BY A  
 1 1/2 FT DIA MOUND OF SAND  
 STONE

Monument Detail

DOUGLAS COUNTY SURVEYORS  
 T 235  
 1/4 S 23 R  
 S 26 9  
 W  
 1995  
 OFFICE

New Accessories

4" DIA. D. FIR DOUBLE BLAZED AND SCRIBE "X BT"  
 BEARS S 67° W, 15.9 FT

11" DIA HEMLOCK DOUBLE BLAZED AND SCRIBED "1/4 S 23 CS BT"  
 BEARS N 89° E, 54.6 FT

Sketch of Monument, Accessories, and General Area

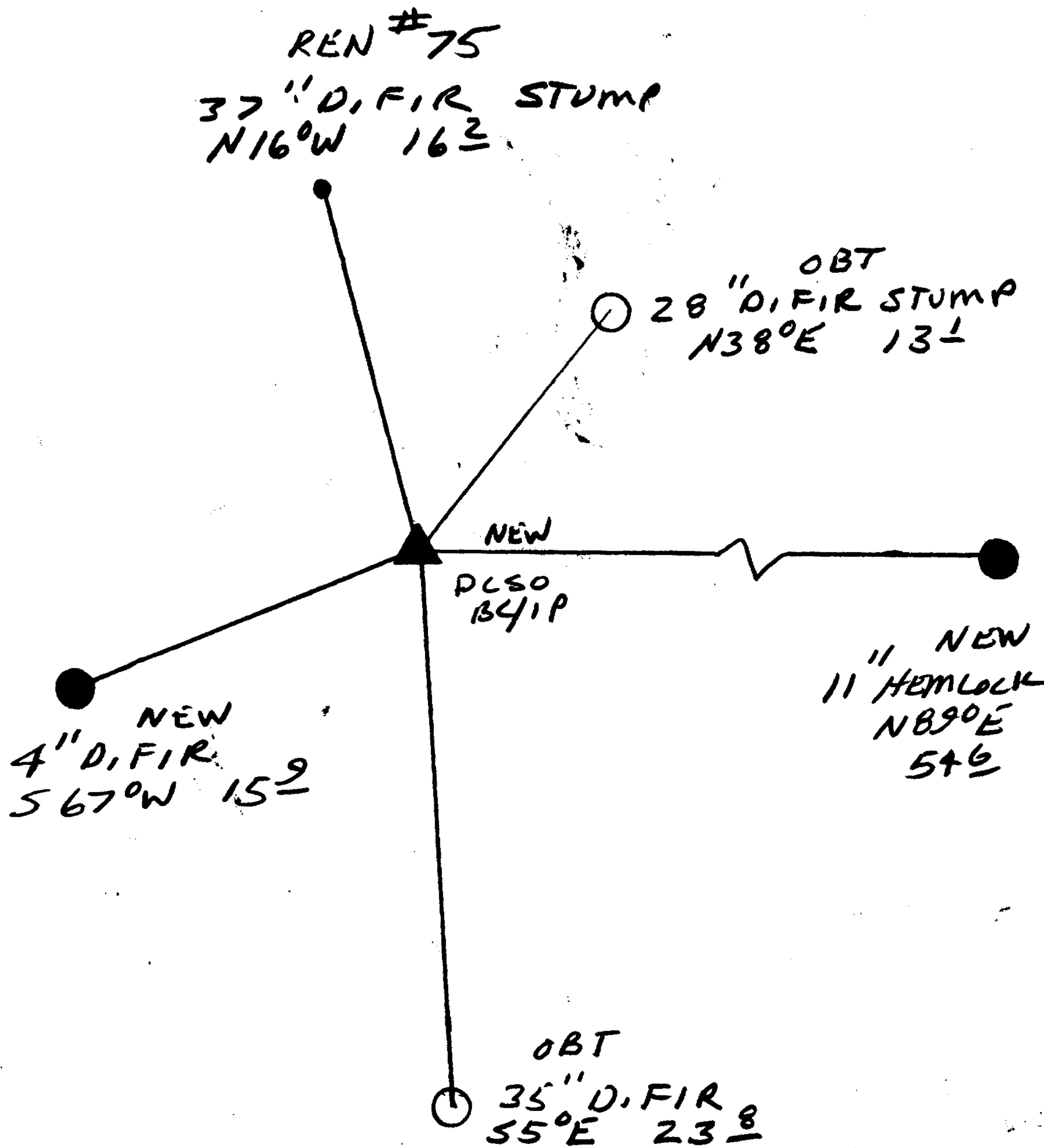

Location & Comments

Comp. Declin. 17 3/4° E  
 Agency DCSO  
 Party Chief RANDALL W SMITH  
 Notekeeper Randall W Smith  
 Witnesses STEVEN J FLAUS

Address

Surveyor's Seal

REGISTERED  
 PROFESSIONAL  
 LAND SURVEYOR

*Randall W Smith*  
 EXPIRES 6-30-96

OREGON  
 JULY 25, 1990  
 RANDALL W. SMITH  
 2489