

GOVERNMENT CORNER RESTORATION FORM

Date: 10/5/95 By: PC

Township Z5S Range 6W Sec. 15 County DOUGLAS State: \_\_\_\_\_

This survey consists of:

State OR Date 7-5-95 No. \_\_\_\_\_

Name: \_\_\_\_\_  
Corner Rep: CS 64/63-14

Corner Designation

S16 | S15  
S21 | S22

DOUGLAS COUNTY  
SURVEYOR

- Condition Report Only
- Not Found
- Renewed
- Unrecorded
- Surveyed In
- Referenced Out

Previous Renewals 1962 DCSO PI # 400400

Monument(s) Found: (Condition and Source)

2 1/2" DIA. DCSO BRASS CAP ON  
1 1/2" O.D. IRON PIPE PROTRUDES  
7" ABOVE GROUND. (1962 DCSO)

MONUMENT DETAIL

COUNTY SURVEYORS OFFICE

T 25S | R 6W  
S16 | S15  
S21 | S22  
1962

Accessories Found:

15" NOW 36" DIA DOWN B. OAK WITH A PREVIOUSLY  
OPENED BLAZE SCRIBING FOUND "BT" REMAINING  
1 FT HIGH STUMP BEARS N 78° E 200.6 FT  
(REC N 78 1/2° E 200.6 FT) ORIG. BT.

NO EVIDENCE OF ANY OTHER ORIG. BT'S FOUND

14" NOW 18" DIA. W. OAK WITH A FULLY HEALED DOUBLE  
BLAZE BEARS S 18 3/4° W, 60.6 FT (REC S 21° W 60.6 FT)  
1962 DCSO

18" NOW 36" DIA 1 FT HIGH D. FIR STUMP WITH A  
FULLY HEALED LOWER BLAZE VISIBLE, BEARS N 56 1/2° W  
49.5 FT (REC N 55° W, 49.5 FT). 1962 DCSO

8" NOW 13" DIA. W. OAK WITH A FULLY HEALED DOUBLE  
BLAZE BEARS S 49 3/4° E, 63.4 FT (REC S 48° E,  
63.4 FT) 1962 DCSO

21" NOW 27" DIA. W. OAK WITH A FULLY HEALED DOUBLE  
BLAZE BEARS N 76 1/2° E, 160.1 FT (REC N 78 1/2° E,  
160.1 FT) 1962 DCSO

RENEWAL

Monument Set (Procedure and Description)

NONE

Monument Detail

N/A

New Accessories

11" DIA. W. OAK DOUBLE BLAZED AND SCRIBED  
"T 255 R6W S16 CS BT", BEARS N 49 3/4° W, 115.0 FT

Sketch of Monument, Accessories, and General Area

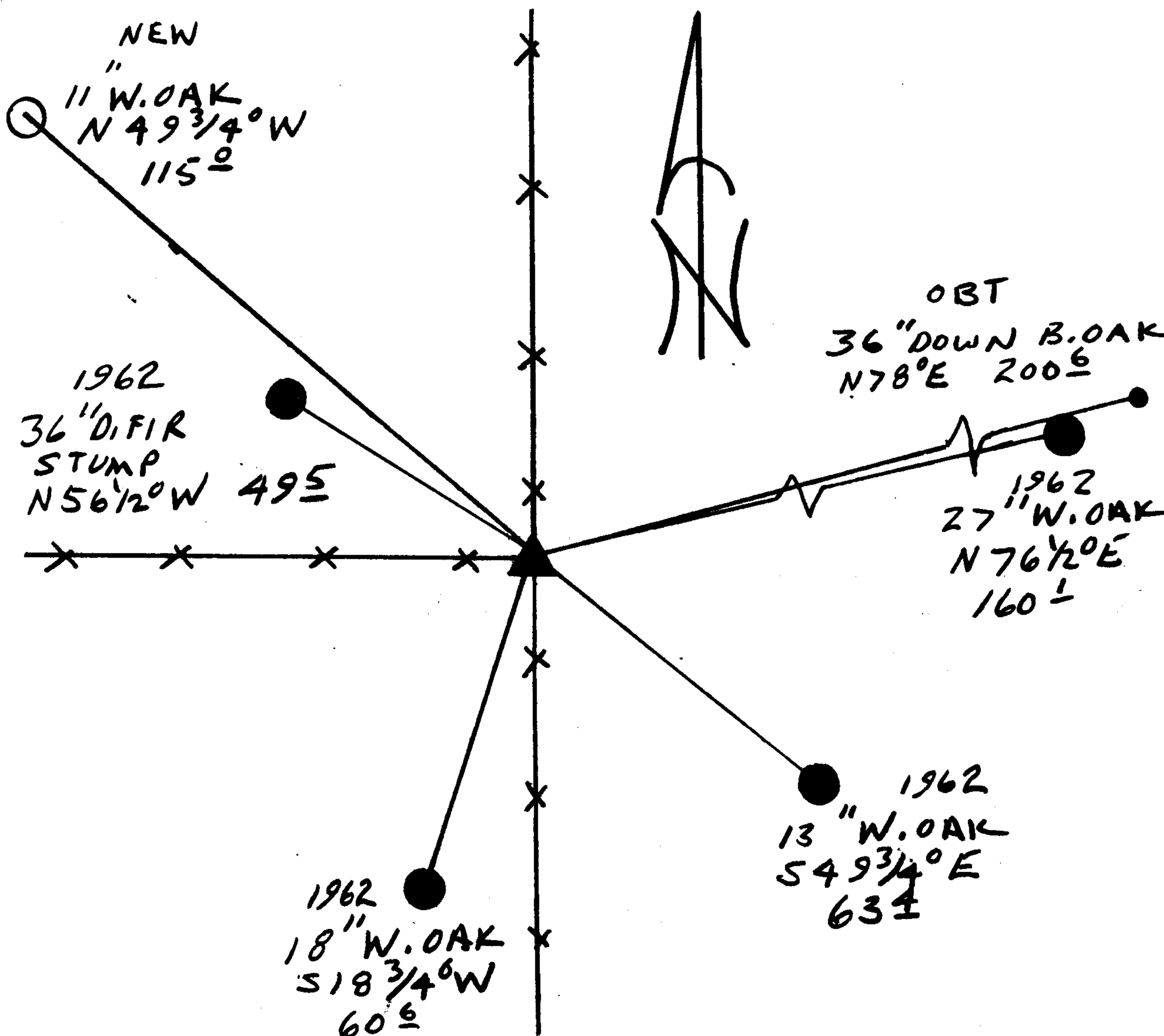

Location & Comments

CORNER LIES AT THE INTERSECTION OF A NORTH - SOUTH AND WEST RUNNING FENCE LINES

Comp. Declin. 17 3/4° E  
Agency DCSO  
Party Chief RANDALL W SMITH  
Notekeeper *Randall W Smith*  
Witnesses STEPHEN J FLAUSE

Address

Surveyor's Seal

REGISTERED PROFESSIONAL LAND SURVEYOR

*Randall W Smith*  
EXPIRES 6-31-96

OREGON  
JULY 25, 1990  
RANDALL W. SMITH  
2489