

GOVERNMENT CORNER RESTORATION FORM

Date: 10/4/95 By: MC

Township 22S Range 12W Sec. 18 County DOUGLAS

This survey consists of: _____

State OR Date 5-31-95 No. _____

Map: _____

Narrative: _____

Corner Rpt: CS 64/103-12

Corner Designation

S 13 | S 18
S 24 | S 19

DOUGLAS COUNTY

SURVEYOR

Condition Report Only

Not Found

Renewed

Unrecorded

Surveyed In

Referenced Out

MONUMENT DETAIL

Previous Renewals # 90 # 152

Monument(s) Found: (Condition and Source)

AS NOTED 5-17-95
(SEE ATTACHED RENEWAL)
1981 DCSO BRASS CAP IS
REMOVED AND YELLOW PLASTIC
CAP IS SET IN TOP MARKED
"DOUG. CO. SURVEYOR 1995"
5/8" I.P. REMAINS ALONG NW
EDGE. I.P. NOW PROTRUDES
3" ABOVE GROUND. (REN #152)

N/A

Accessories Found:

BRG'S AND DIST TAKEN FROM A POSITION DETERMINED FROM
ORG. BT'S AND A REN # 90 BT.

- 30" NOW 36" DIA 4 1/2 FOOT HIGH ROTTED SPRUCE STUMP WITH A POSSIBLE BLAZE NO SCRIBING FOUND BEARS N15°W, 10.6 FT TO BLAZE (AGREES WITH REC) CENTER BEARS N15°W, 11.8 FT O.B.T
- 24" NOW 46" DIA 7 FOOT HIGH ROTTED SPRUCE STUMP WITH AN OPENED BLAZE AND SCRIBING VISIBLE "S" AND OTHER ILLEGIBLE MARKS, BEARS S72°E, 44.9 FT TO BLAZE (AGREES WITH REC) CENTER BEARS S72°E, 45.9 FT O.B.T
- 30" NOW 26" DIA 4 1/2 FOOT HIGH ROTTED SPRUCE STUMP, NO BLAZES OR SCRIBING FOUND, BEARS S62 1/2°W, 32.3 FT TO A POSITION THAT WOULD FIT A POSSIBLE BLAZE LOCATION, (AGREES WITH REC) CENTER BEARS S62 1/2°W, 33.5 FT, REN #90
- 19" NOW 30" DIA SPRUCE WITH A FULLY HEALED DOUBLE BLAZE, BEARS, S56 1/2°W, 32.1 FT (REC S59°W, 35.4 FT) REN #152
- 18" SPRUCE NOW 24" DIA D. FIR WITH A FULLY HEALED DOUBLE BLAZE, BEARS, N24°W, 32.9 FT (REC N28°W, 30.4 FT) REN #152
- 24" NOW 34" DIA. SPRUCE WITH A FULLY HEALED DOUBLE BLAZE, BEARS S97 1/2°E, 68.3 FT (REC S8 1/2°E, 71.4 FT) REN #152

RENEWAL

Monument Set (Procedure and Description)

A 2 3/8" DIA DCSO BRASS CAP ON 1 3/8" O.D. BY 32" LONG IRON PIPE AT A POSITION DETERMINED FROM TWO REMAINING ORIGINAL BEARING TREES AND BEARING TREE MARKED BY EPSTEIN IN REN #90. BC/IP PROTRUDES 2" ABOVE GROUND.

1981 DCSO IRON PIPE BEARS N19 3/4° E, 3.5 FT.

CORNER IS S20° W, 4.7 FT FROM A 4" X 4" X 8 FT HIGH WHITE WOODEN POST

Monument Detail

DOUGLAS COUNTY SURVEYORS
T 2 2 5

R		R
13	S13 S18	12
W	S24 S19	W

1995
OFFICE

New Accessories

4" DIA CASCARA DOUBLE BLAZED AND SCRIBED "X BT" BEARS S88 1/2° W, 9.7 FT.

7" DIA ALDER BARK SCRIBED "T 2 2 5 R 13 W S 24 CS BT" BEARS S31 1/2° W, 18.4 FT

Sketch of Monument, Accessories, and General Area

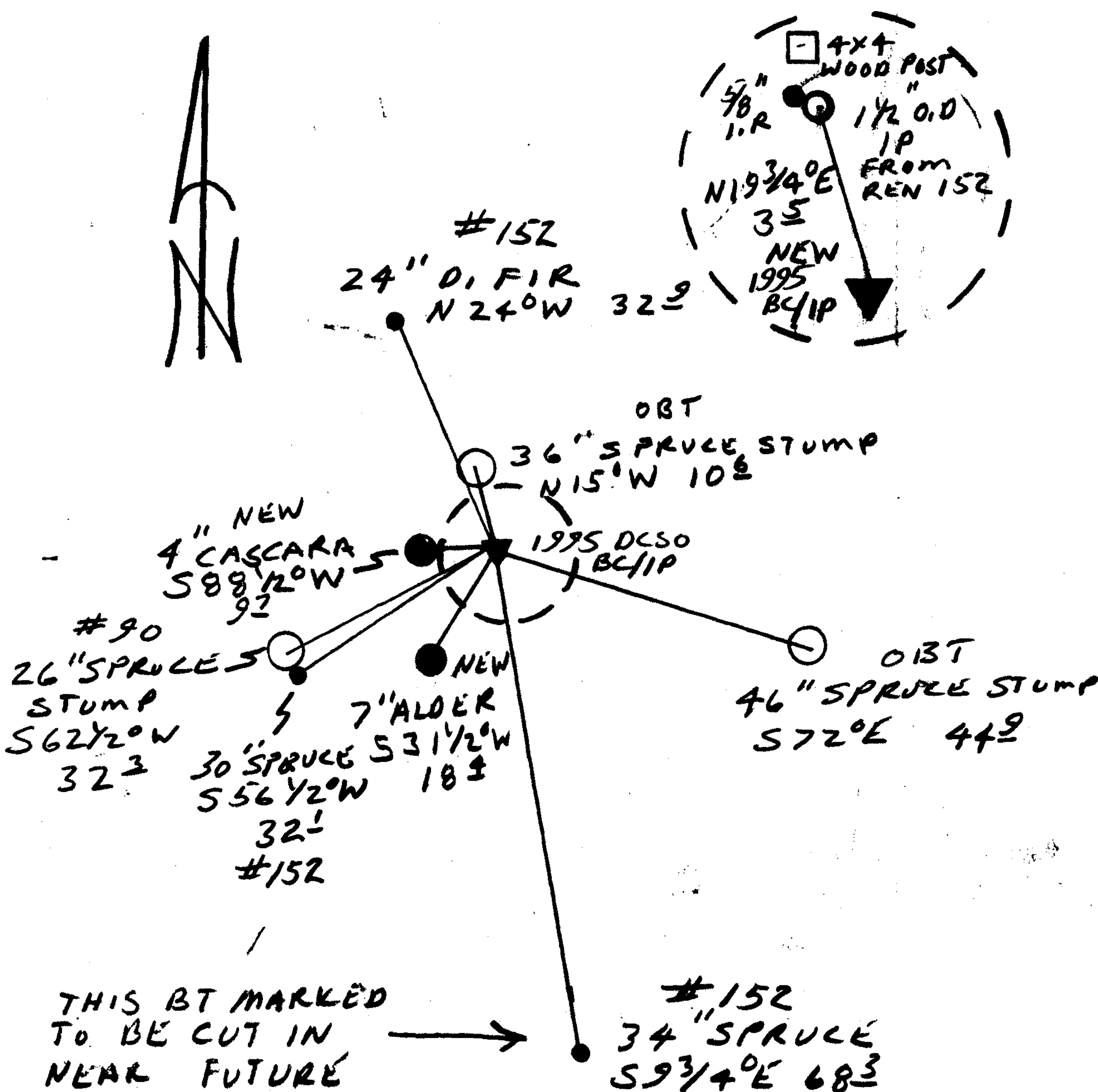

Location & Comments

BT TAGS ARE CHANGED TO REFLECT BRC'S AND DISTANCES DETERMINED IN THIS RENEWAL

AREA AROUND CORNER HAS HEAVY UNDERGROWTH

Comp. Declin. 17 3/4° E
Agency DCSO
Party Chief RANDALL W SMITH
Notekeeper Randall W Smith
Witnesses STEPHEN J FLAUSE

Address

Surveyor's Seal

REGISTERED PROFESSIONAL LAND SURVEYOR

Randall W Smith
EXPIRE 6-30-96

OREGON
JULY 25, 1990
RANDALL W. SMITH
2469

GOVERNMENT CORNER RESTORATION FORM

Township 22S Range 12W Sec. 18 County DOUGLAS

State OR Date 5-17-95 No. _____

Corner Designation

S13 | S18

S24 | S19

- Condition Report Only
- Not Found
- Renewed
- Unrecorded
- Surveyed In
- Referenced Out

Previous Renewals #90, #152

MONUMENT DETAIL

Monument(s) Found: (Condition and Source)

2 1/2" DIA DCSO BRASS CAP ON
A 1 1/2" IRON PIPE, PROTRUDES
4" ABOVE GROUND. (REN 152)

5/8" I.R. ~~4" PROTRUDES~~
5" ABOVE GROUND ALONG
NORTHWEST EDGE OF BC/IP
(SOURCE UNKNOWN)

4" X 4" X 8 FT HIGH WHITE
WOODEN POST BEARS N19°E
1.15 FT

DOUGLAS CO. SURVEYOR

T 22S
R
S13 | S18

S24 | S19
13
W
1981
R
12
W

Accessories Found:

30" NOW 36" DIA. 4 1/2 FOOT HIGH ROTTED SPRUCE STUMP
WITH A POSSIBLE BLAZE, NO SCRIBING FOUND, BEARS
N28°W, 9.2 FT (REC. N15°W, 10.6 FT) OBT

24" NOW 46" DIA. 7 FOOT HIGH ROTTED SPRUCE STUMP
WITH AN OPENED BLAZE, ILLEGIBLE SCRIBING VISIBLE,
BEARS S68 1/2°E, 45.9 FT (REC S72°E, 44.9 FT
DIST. POSSIBLE FACE MEASUREMENT) OBT

CRIG. SW AND NE AT'S ARE GONE

POSSIBLE REN 90 BT

30" NOW 70" DIA 4 1/2 FT HIGH ROTTED SPRUCE
STUMP NO BLAZES OR SCRIBING FOUND, BEARS.
S58°W, 50.4 FT (REC. S62 1/2°W, 32.3 FT

1 1/2" NOW 30" DIA SPRUCE WITH A FULLY HEALED DOUBLE
BLAZE, BEARS S54°W 35.4 FT. (AGREES WITH REC) REN 152

18" ~~NOW~~ NOW 24" DIA. D. FIR WITH A FULLY HEALED
DOUBLE BLAZE, BEARS ~~S~~°W, 30.4 FT (AGREES WITH REC) REN 152

24" NOW 34" DIA SPRUCE WITH A FULLY HEALED DOUBLE
BLAZE, BEARS S8 1/2°E, 71.4 FT (AGREES WITH REC) REN 152

RENEWAL

Monument Set (Procedure and Description)

Monument Detail

NONE

N/A

New Accessories

4" DIA. CASCARA DOUBLE BLAZED AND SCRIBED "X BT"
BEARS S 71 1/2° W 11.5 FT

7" DIA. ALDER BARK SCRIBED "T 225 R 13 W S 24 CS BT"
BEARS S 39° W 21.6 FT

Sketch of Monument, Accessories, and General Area

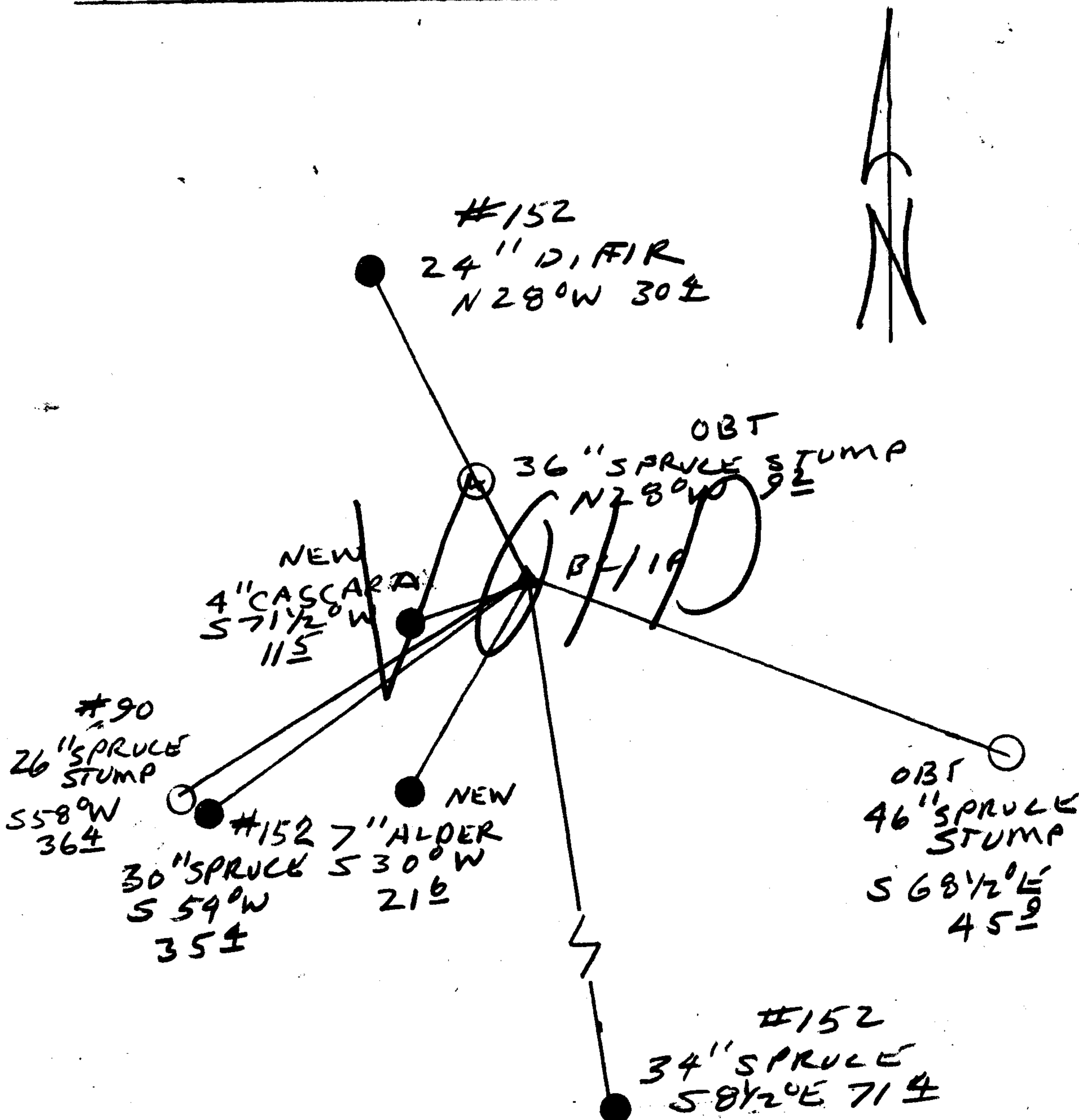

Location & Comments

Comp. Declin. 17 3/4° E
 Agency DCSO
 Party Chief RANDALL W SMITH
 Notekeeper Paul Hill
 Witnesses STEPHEN J FLAWE

Address

Surveyor's Seal

REGISTERED
PROFESSIONAL
LAND SURVEYOR

Randall W Smith
EXPIRE 6-30-96

OREGON
JULY 25, 1990
RANDALL W. SMITH
2489

Job ID : XYZ
 Job name : Misc.. computations
 Description :
 Reference :
 Projection : None
 Date printed: 25/05/95 10:20am

Radial report from point 94 (COORD)

Point	Azimuth	Distance	Northing	Easting	Elevation	Name
94	-	-	4831.804	5419.484	<Null>	COORD
76	N15°11'37"E	3.979	4835.644	5420.527	<Null>	COORD
85	S73°30'16"E	44.635	4819.130	5462.282	<Null>	COORD
93	S62°37'00"W	32.340	4816.929	5390.768	<Null>	COORD
84	N15°21'08"W	11.153	4842.559	5416.531	<Null>	COORD

Radial report from point 95 (I/P)

Point	Azimuth	Distance	Northing	Easting	Elevation	Name
95	-	-	4832.347	5419.371	<Null>	I/P
76	N19°19'02"E	3.493	4835.644	5420.527	<Null>	COORD
85	S72°52'52"E	44.900	4819.130	5462.282	<Null>	COORD
93	S61°40'30"W	32.494	4816.929	5390.768	<Null>	COORD
86	S74°43'47"W	0.100	4832.321	5419.275	<Null>	COORD
84	N15°32'27"W	10.600	4842.559	5416.531	<Null>	COORD

OOT (S72E 44.9) \pm = 0.69 FT LFT
 EPPST (S62 37W 32.34) \pm = 0.53 FT
 OOT (N15W 10.6) \pm = 0.10 FT

FACE MEASUREMENTS