

GOVERNMENT CORNER RESTORATION FORM

Date: 5-30-95 By: JP

Township 31S Range 9W Sec. 15

County DOUGLAS Map: _____

This survey consists of:

State OR Date 1-23-95

No. _____ Narrative: _____
Correr Rpt: C.S. 64/58-4

Corner Designation

S16 | S15
S21 | S22

DOUGLAS COUNTY

Condition Report Only

Not Found

Renewed

Unrecorded

Surveyed In

Referenced Out

Previous Renewals #106

Monument(s) Found: (Condition and Source)

2 1/2" DIA. DCSO BRASS CAP ON A
1 1/2" O.D. BY 36" LONG IRON PIPE.
FOUND LOOSE IN ROOT WAD OF
TIPPED OUT TREE. BC/IP
HAS NO POSITION (REN #106)

COUNTY SURVEYORS OFFICE

T 31S R 9W

S15 | S16

S21 | S22

1967

NOTE: S15 AND S16
ARE MARKED IN
WRONG QUADRANT

Accessories Found:

- 72" NOW 50" DIA 15 FT HIGH ROTTED D. FIR SNAG
NO SCRIBING OR BLAZES VISIBLE BEARS N50°E
21.8 FT (AGREES WITH REC) OBT.
- 60" NOW 66" DIA 10 FT HIGH D. FIR STUMP WITH
A "W" CRUISERS AXE MARK IN BARK NO BLAZES
OR SCRIBING VISIBLE BEARS S70°W, 59.4 FT
(AGREES WITH REC) OBT
- 60" NOW 48" DIA 3 FT HIGH D. FIR STUMP WITH
ILLEGIBLE SCRIBING VISIBLE, BEAR N40°W, 69.5 FT
(REC N40°W, 66.0 FT ORIG REC) OBT DIST OF 72 FT
FROM REN #106 IS A SLOPE MEASUREMENT.
- FOUND REMAINS OF OLD STUMP NEAR REC BEARING
AND DIST OF ORIG 18" W. FIR (REC S45°E 85.8 FT) OBT
- 12" NOW 10" DIA 1 FT HIGH ROTTED D. FIR STUMP
NO BLAZES OR SCRIBING FOUND BEARS S73°W
21.7 FT (REC S67°W 21.7 FT). REN #106
- ALL OTHER RT'S FROM REN #106 ARE TIPPED
OUT OF GROUND AND POSITIONS ARE NOT DETERMINABLE

RENEWAL

Monument Set (Procedure and Description)

Monument Detail

DCSO BE/IP IS SET FROM POSITIONS OF ORIG. BT'S AS DETERMINED FROM ACCESSORIES FOUND (SEE FRONT PAGE) THE MARK "RESET 1995" ARE ADDED. BE/IP PROTRUS 2" ABOVE GROUND.

COUNTY SURVEYORS OFFICE
T 315 R 9W

S16 | S15
S21 | S22

RESET 1995
1967

NOTE: S16 AND S15 ARE NOW MARKED IN CORRECT QUADRANTS

New Accessories

- 9" MADRONE BARK SCRIBED "T315 R9W S16 CS BT" BEARS N 20° W, 28.0 FT
- 13" D. FIR DOUBLE BLAZED AND SCRIBED "T315 R9W S21 CS BT" BEARS S 20 1/2° W, 24.0 FT
- 18" D. FIR DOUBLE BLAZED AND SCRIBED "T315 R9W S15 CS BT" BEARS N 86 1/2° E, 18.1 FT
- 19" D. FIR DOUBLE BLAZED AND SCRIBED "T315 R9W S22 CS BT" BEAR S 43 1/2° E, 36.5 FT

Sketch of Monument, Accessories, and General Area

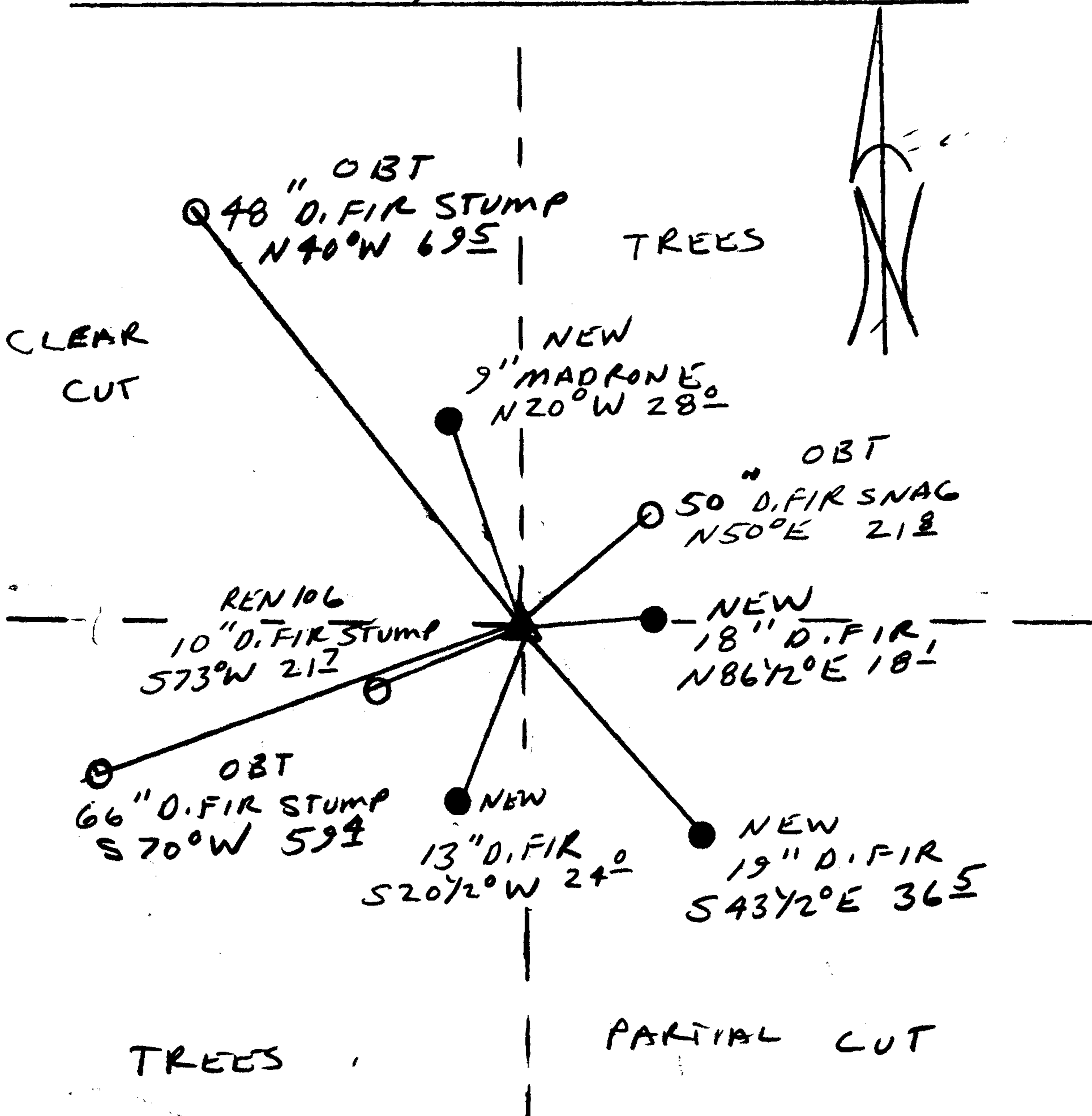

Location & Comments

Comp. Declin. 17 3/4° E
 Agency DCSO
 Party Chief RANDALL W SMITH
 Notekeeper Randall W Smith
 Witnesses STEPHEN J FLAVSK

Address

Surveyor's Seal

REGISTERED
PROFESSIONAL
LAND SURVEYOR

Randall W Smith
06/30/96 EXPIRES

OREGON
JULY 25, 1990
RANDALL W. SMITH
2489