



Monument Set (Procedure and Description)

Monument Detail

HAINES T IRON IS REFERENCED AND REMOVED. AT REFERENCED POSITION A 2 1/2" DIA DCSO BRASS CAP ON 1 3/8" BY 32" LONG IRON PIPE IS SET. BC/IP PROTRUDES 9" ABOVE GROUND. 24" LONG HAINES T IRON IS SET ALONG SOUTH EDGE OF BC/IP, PROTRUDES 4" ABOVE GROUND.

DOUGLAS COUNTY SURVEYORS  
T 22 S  
R 7 S 13 / S 18 R 6  
W W  
1/4  
1995  
OFFICE

New Accessories

12" DIA. MAPLE DOUBLE BLAZED AND SCRIBED "1/4 S 13 CS BT"  
BEARS N 40 1/2° W, 15.8 FT

18" DIA. D. FIR DOUBLE BLAZED AND SCRIBED "1/4 S 18 CS BT"  
BEAR S 56° E, 42.4 FT.

Sketch of Monument, Accessories, and General Area

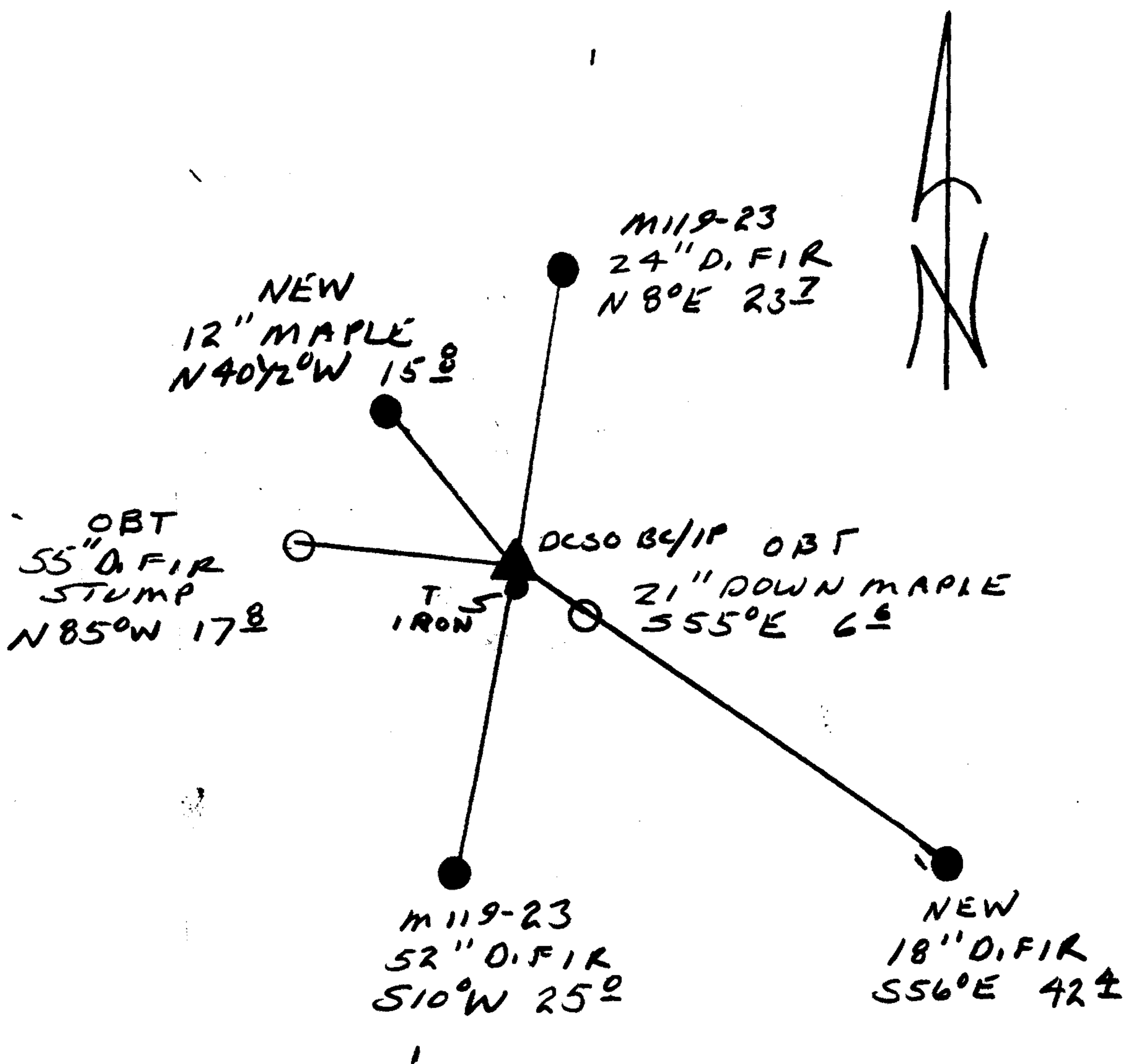

Location & Comments

Comp. Declin. 17 3/4° E  
Agency DCSO  
Party Chief RANDALL W. SMITH  
Notekeeper Randall W. Smith  
Witnesses \_\_\_\_\_

Address

Surveyor's Seal

REGISTERED  
PROFESSIONAL  
LAND SURVEYOR

*Randall W. Smith*  
EXPIRES 6/30/96

OREGON  
JULY 25, 1990  
RANDALL W. SMITH  
2469