

GOVERNMENT CORNER RESTORATION FORM

Date: 12/28/94 By: JP
This survey consists of:

Township 26S Range ZW Sec. 17 County DOUGLAS

State OR Date 10-24-94 No. _____

Narrative: _____
Corner Rpt: C.S. 64/52

Corner Designation

C 1/4 S 17

DOUGLAS COUNTY
SURVEYOR

- Condition Report Only
- Not Found
- Renewed
- Unrecorded
- Surveyed In
- Referenced Out

Previous Renewals 1959 BLM

Monument(s) Found: (Condition and Source)

3/4" DIA BRASS CAP ON A
2" I.D. IRON PIPE PROTRUDES
2" ABOVE GROUND. 1959 BLM

U.S. CADASTRAL SURVEY

C 1/4 S 17

1959
BUREAU OF LAND MANAGEMENT

Accessories Found:

18" NOW 21" DIA HEMLOCK WITH A FULLY HEALED
SINGLE BLAZE, BEARS N 75 1/4° E, 47.8 FT
(AGREES WITH REC) 1959 BLM

8" NOW 14" DIA HEMLOCK WITH A FULLY HEALED
SINGLE BLAZE, BEARS S 24 1/2° W, 27.2 FT
(REC S 24 1/2° W, 27.2 FT DIST IS A SLOPE MEASUREMENT)
1959 BLM

Monument Set (Procedure and Description)

Monument Detail

NONE

N/A

New Accessories

10" MAPLE DOUBLE BLAZED AND SCRIBED "CY4S17CS BT"
BEARS N 1° W, 27.2 FT

7" MAPLE DOUBLE BLAZED AND SCRIBED "CY4S17CS BT"
BEARS N 89° W, 5.2 FT

Sketch of Monument, Accessories, and General Area

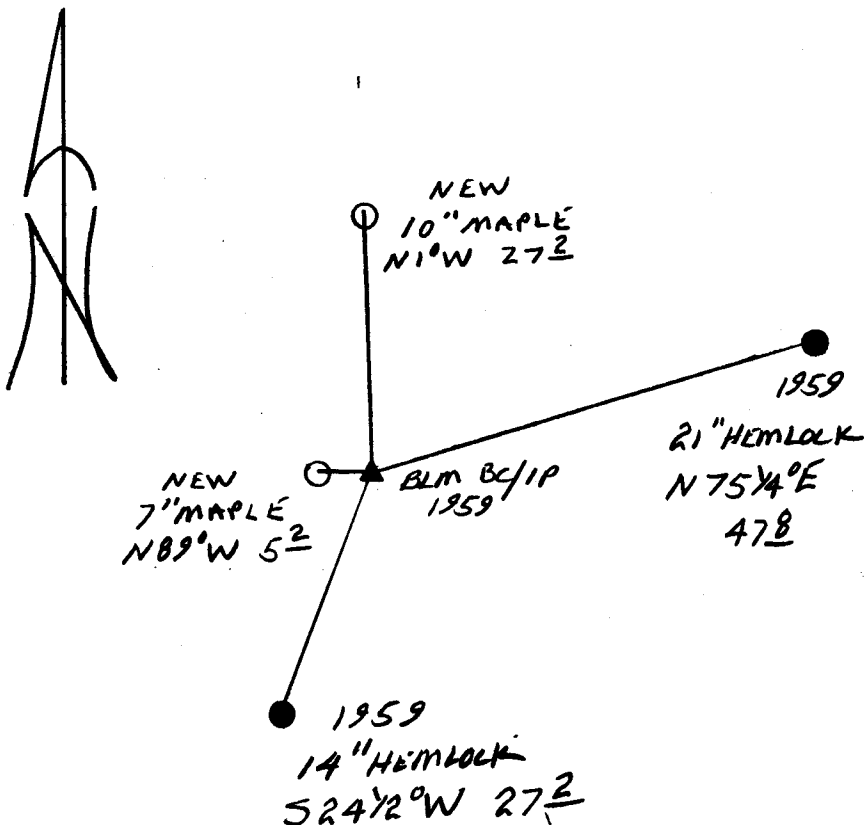

Location & Comments

CORNER LIES IN OLD
GROWTH TIMBER ON
A BENCH

Comp. Declin. 17 3/4° E
Agency DCS
Party Chief RANDALL W SMITH
Notekeeper Randall W Smith
Witnesses STEPHEN J FLAUS

Address

Surveyor's Seal

REGISTERED
PROFESSIONAL
LAND SURVEYOR

Randall W Smith
EXPIRES 12-31-94

OREGON
JULY 25, 1990
RANDALL W. SMITH
2489