

Monument Set (Procedure and Description)

Monument Detail

(NA)

New Accessories

A 5 INCH D.B.H. DOUGLAS FIR SCRIBED "X BT" ON A DOUBLE BLAZE BEARS N 12° E, 35± FEET DISTANT (BASE OF TRUNK PISTOL-BUTTED; BEARING AND DISTANCE TO CENTER OF ROOT CROWN AS PER MANUAL OF INSTRUCTIONS)
A 19 INCH D.B.H. MADRONE SCRIBED "S SW DLC 43 CS BT" ON A DOUBLE BLAZE (UPPER BLAZE IS HIGH SEPERATED FROM LOWER BLAZE BY AN OLD PARTIALLY HEALED DEEP SAW KERE), TREE BEARS N 75° E, 47± FEET DISTANT.

Sketch of Monument, Accessories, and General Area

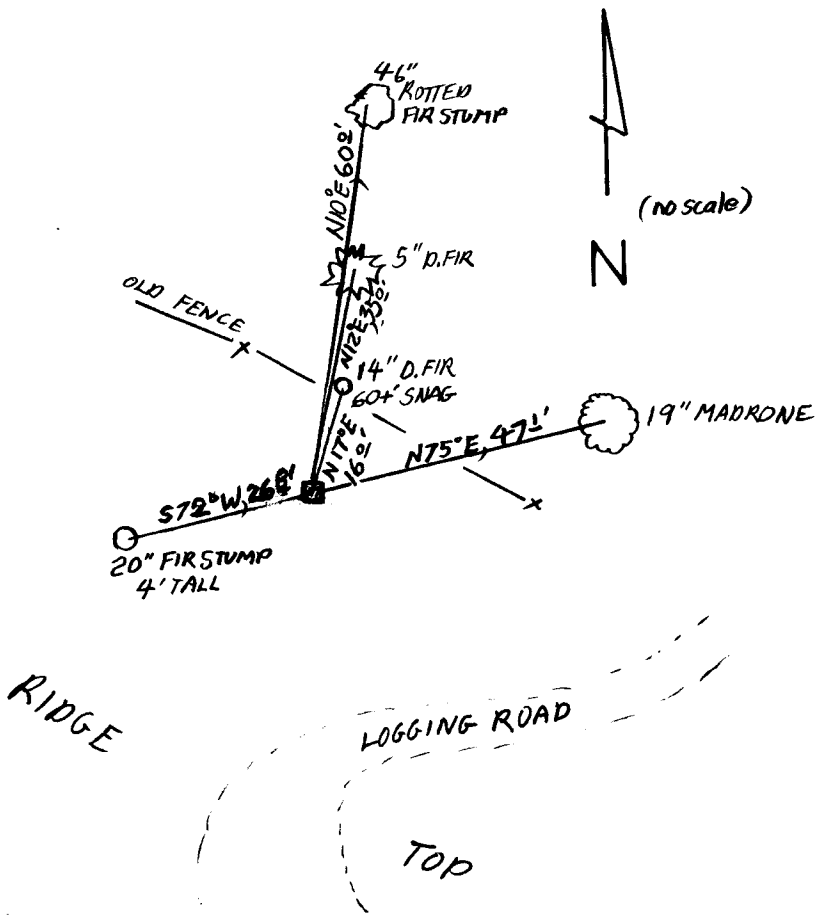

Location & Comments

MONUMENT IS JUST NORTHEAST OF EDGE OF SMALL BENCH ON CREST OF NORTHWEST RUNNING RIDGE. A LOGGING ROAD TRAVERSES THIS RIDGE AND BENCH APPROXIMATELY 50 SOUTH FROM CORNER POSITION. MONUMENT LIES 15 FEET SOUTH FROM A RANDOM EAST-WEST FENCE LINE (OLD BROKENDOWN).

Comp. Declin. _____

Agency DCSO

Party Chief STEPHEN JOHN FLAYSE

Notekeeper Stephen John Flayse

Witnesses _____

Address _____

Surveyor's Seal

REGISTERED PROFESSIONAL LAND SURVEYOR
Randall W. Smith
EXPIRES 12-31-94
OREGON
JULY 25, 1990
RANDALL W. SMITH
2489