

GOVERNMENT CORNER RESTORATION FORM

Date: 8/29/94 By: AC

Township 29S Range 6W Sec. 20

County DOUGLAS Map: _____

This survey consists of:

State OR Date 6-20-94

No. _____

Narrative: _____

Corner Rpt: CS 64/52

Corner Designation

S20	S21
S29	S28

DOUGLAS COUNTY

Condition SURVEYOR Only

Not Found

Renewed

Unrecorded

Surveyed In

Referenced Out

Previous Renewals #80 #82 #96 #169, 1990 BLM

Monument(s) Found: (Condition and Source)

3/4 DIA BLM BRASS CAP ON A
2 1/2" O.D. IRON PIPE PROTRUDING
4" ABOVE GROUND. (1990 BLM
PENDING RESURVEY)

I.P. NOTED IN RENEWALS NOT
VISIBLE.

MONUMENT DETAIL

DEPT. OF THE INTERIOR

T29S R6W

S20	S21
S29	S28

1990

BUR. OF LAND MANAGEMENT

Accessories Found:

ALL ORIG BT'S AND BT'S FROM RENEWALS 80 AND 82
NOW GONE

BT'S FROM REN #96

- 14" NOW 24" DIA 4 FT HIGH D. FIR STUMP WITH A
FULLY HEALED DOUBLE BLAZE, BEARS S89°W, 5.5 FT
(AGREES WITH REC)

- 18" NOW 24" DIA 2 FT HIGH D. FIR STUMP WITH A FULLY
HEALED LOWER BLAZE. WE OPEN AND FIND GOOD
SCRIBE MARKS "BT" BEARS N 81 1/4° E, 100.0 FT (REC N 80° E,
100.0 FT)

SE BT FROM REN 96 NOW GONE

BT'S FROM REN #169

- UNKNOWN DIA NOW 15 1/2 FT HIGH D. FIR STUMP WITH A
FULLY HEALED SINGLE BLAZE BEARS S 43 1/2° E,
94.2 FT (REC S 42° E 94.2 FT)

- 9" NOW 24" DIA 3 1/2 FT HIGH D. FIR STUMP WITH A
FULLY HEALED DOUBLE BLAZE BEARS N 38 3/4° W, 6.5 FT
(REC N 31° W 6.5 FT)

BT'S FROM 1990 PENDING RESURVEY (REC TAKEN FROM BT TAGS)

- 20" DIA. D. FIR WITH A PARTIALLY HEALED SINGLE BLAZE
ILLEGIBLE SCRIBING VISIBLE, BEARS S 85 1/2° E, 57.8 FT
(REC S 85 1/2° E, 58.4 FT, DIST IS TO CENTER OF TRUNK).

- 16" DIA 3 FT HIGH D. FIR STUMP WITH A PARTIALLY HEALED SINGLE
BLAZE, ILLEGIBLE SCRIBING VISIBLE, BEARS N 21 1/4° E, 43.7 FT
(AGREES WITH REC)

#276

Monument Set (Procedure and Description)

Monument Detail

NONE

N/A

New Accessories

- 13" DIA MADRONE BARK SCRIBED "T 295 RGW S 29 CS BT"
BEARS S 77 1/4° W, 34.0 FT
- 13" DIA J. CEDAR DOUBLE BLAZED AND SCRIBED "T 295 RGW S 20 CS BT"
BEARS N 28 1/2° W, 47.7 FT
- 4" DIA D. FIR DOUBLE BLAZED AND SCRIBED "X BT"
BEARS N 58 1/2° E, 16.2 FT

Sketch of Monument, Accessories, and General Area

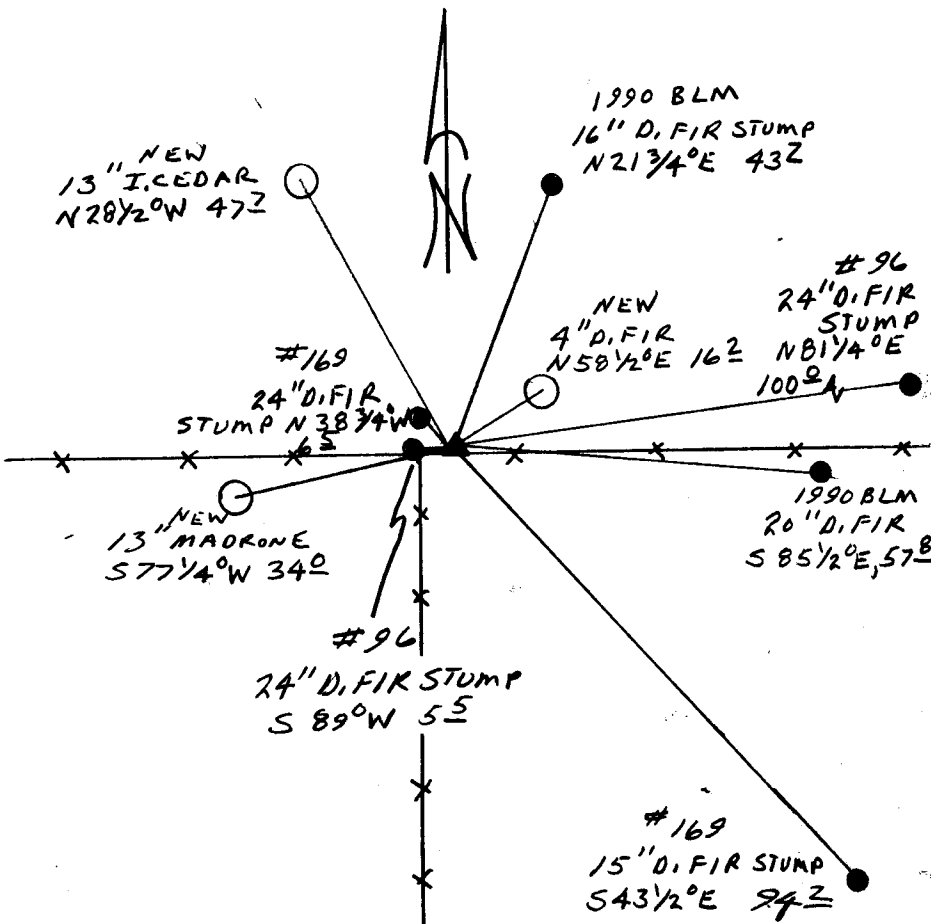

Location & Comments

CORNER LIES NEAR THE INTERSECTION OF A EAST-WEST AND SOUTH RUNNING FENCE LINE, 4 1/2 FT EAST OF THE INTERSECTION AND 1 1/2 FT NORTH OF THE EAST-WEST FENCE LINE. ALL BRG'S TAKEN AWAY FROM FENCE LINE.

Comp. Declin. 17 3/4° E
 Agency DCSG
 Party Chief RANDALL W SMITH
 Notekeeper Randall W Smith
 Witnesses STEPHEN J FLAUSK

Address

Surveyor's Seal

REGISTERED
 PROFESSIONAL
 LAND SURVEYOR

Randall W Smith
 EXPIRES 12-31-94

OREGON
 JULY 25, 1990
 RANDALL W. SMITH
 2489