

GOVERNMENT CORNER RESTORATION FORM

Date: 8/17/94 By: BC

Township 27S Range 5W Sec. 2 County DOUGLAS

This survey consists of:

State OR Date 6-22-94 No. _____

Map: _____

Narrative: _____

Corner Rpt: CS 64/52

Corner Designation

$\frac{1}{4} \frac{S2}{S11}$

DOUGLAS COUNTY

Condition: Report Only

Not Found

Renewed

Unrecorded

Surveyed In

Referenced Out

MONUMENT DETAIL

Previous Renewals 1967 BAUGHMAN PJ#540600

Monument(s) Found: (Condition and Source)

2 1/2" DIA BRASS CAP ON A 1 1/2" O.D.
IRON PIPE PROTRUDING 17" ABOVE
GROUND, BC/IP LEANS 7"
NORTH EAST OF PLUMB (1967)

T 27S R 5W

2 | 11

LS 536 1968

Accessories Found:

1" IRON ROD PROTRUDING 3" ABOVE GROUND, BEARS S 18 1/2° E,
40.8 FT (REL S 14° E 44.0 FT) 1967

4" MADRONE BT FROM 1967 RENEWAL NOW GONE

RENEWAL

Monument Detail

Monument Set (Procedure and Description)

BC/IP IS PLUMBED AND REFERENCED,
 MEASURES 36" LONG. BC/IP
 RETURNED TO PLUMB POSITION, PROTRUDES
 8" ABOVE GROUND

N/A

New Accessories

1 1/4" DIA MADRONE DOUBLE BLAZED AND SCRIBED "1452CS BT"
 BEARS N 80 3/4° E, 146.0 FT.
 5/8" BY 32" LONG IRON ROD WITH ALUM DCSO CAP STAMPED "B01 1994"
 PROTRUDES 6" ABOVE GROUND, BEARS S 85° W, 10.0 FT
 5/8" BY 32" LONG IRON ROD WITH ALUM DCSO CAP STAMPED "B02 1994"
 PROTRUDES 6" ABOVE GROUND, BEARS N 45° W, 25.0 FT.

Sketch of Monument, Accessories, and General Area

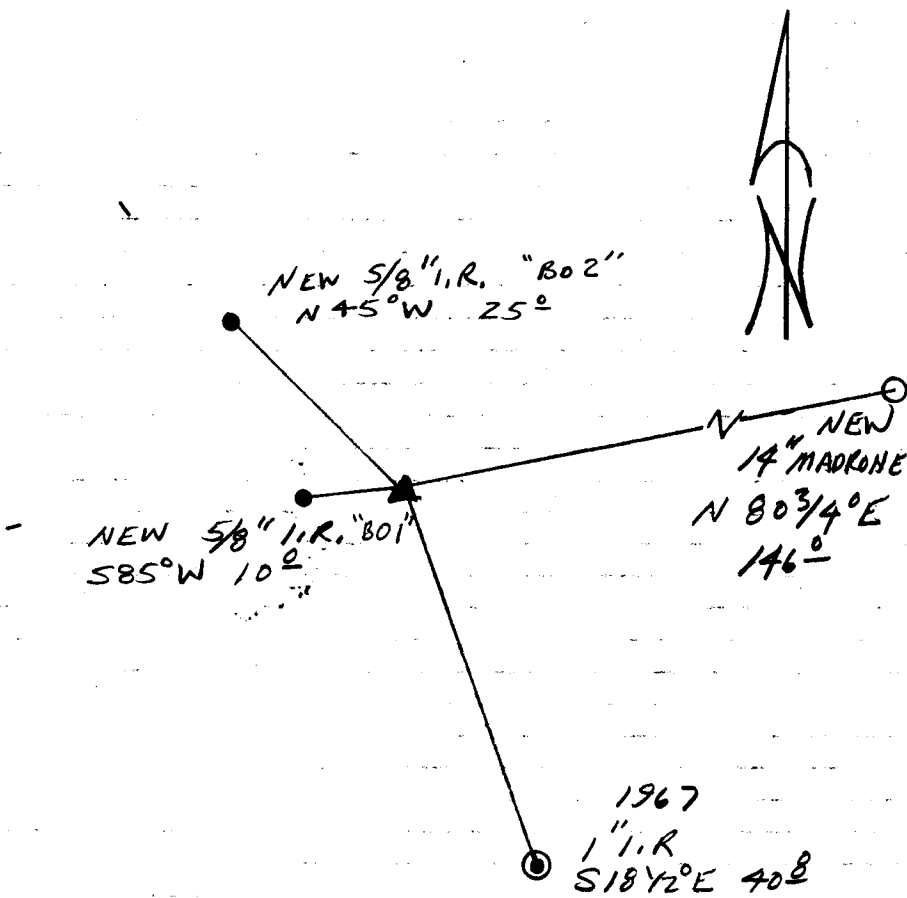

Location & Comments

Comp. Declin. 17 3/4° E
 Agency DCSO
 Party Chief RANDALL W SMITH
 Notekeeper Randall W Smith
 Witnesses STEPHEN J FLAUSE

Address

Surveyor's Seal

REGISTERED
 PROFESSIONAL
 LAND SURVEYOR

Randall W Smith
 EXPIRES 12-31-94

OREGON
 JULY 25, 1990
 RANDALL W. SMITH
 2489