

GOVERNMENT CORNER RESTORATION FORM

Date: 6/17/94 By: JC

Township 28 S Range 7 W Sec. 7

County DOUGLAS Map: _____

State OR Date 5-23-94 No. _____

This survey consists of: _____

Narrative: _____

Corner Rpt: 64/51

Corner Designation

1/4
S7
ONLY

DOUGLAS COUNTY

- Condition Report Only
- Not Found
- Renewed
- Unrecorded
- Surveyed In
- Referenced Out

PI # 100540

Previous Renewals 1924 MENSCH

Monument(s) Found: (Condition and Source)

2 1/2" DIA BRASS CAPON A 1" O.D.
IRON PIPE PROTRUDES 2" ABOVE
GROUND (1924)

U.S. GENERAL LAND OFFICE

1/4
S7

1924
SURVEY

Accessories Found:

7" NOW 19" DIA L. CEDAR WITH A FULLY HEALED
SINGLE BLAZE, BEARS N19°E, 27.7 FT (AGREES
WITH REC) 1924

14" NOW 27" DIA T. CEDAR WITH A FULLY HEALED
SINGLE BLAZE BEARS S73°E, 34.3 FT (AGREES
WITH REC) 1924

RENEWAL

Monument Set (Procedure and Description)

Monument Detail

NONE

N/A

New Accessories

6" DIA. D. FIR DOUBLE BLAZED AND SCRIBED "1/4S7 CS BT"
BEARS S 17 1/2° E, 25.6 FT

6" DIA. D. FIR DOUBLE BLAZED AND SCRIBED "1/4S7 CS BT"
BEARS N 70° E, 22.8 FT

Sketch of Monument, Accessories, and General Area

Location & Comments

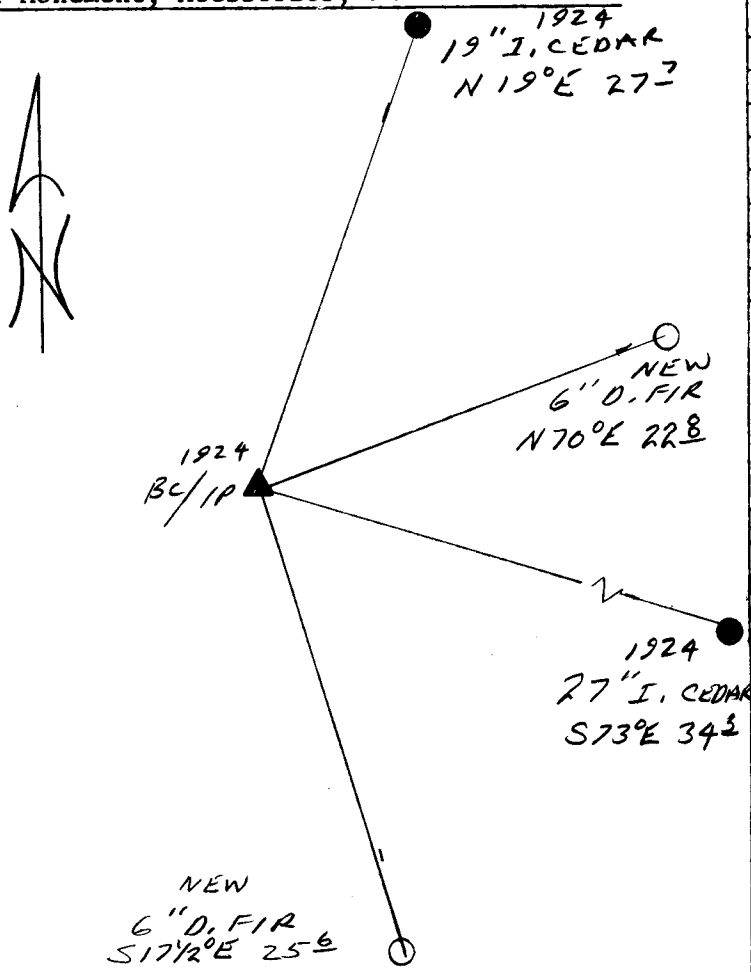

Comp. Declin. 17 3/4° E
 Agency DCS
 Party Chief RANDALL W. SMITH
 Notekeeper Randall W. Smith
 Witnesses STEPHEN J. FLAUSK

Address

Surveyor's Seal

REGISTERED
 PROFESSIONAL
 LAND SURVEYOR

Randall W. Smith

EXPIRES 12-31-94

OREGON
 JULY 25, 1990
 RANDALL W. SMITH
 2400