

GOVERNMENT CORNER RESTORATION FORM

Date: 6-15-94 By: JP

This survey consists of:

Township 27S Range 5W Sec. 14 County DOUGLAS Map: _____

State OR Date 5-3-94 No. _____

Narrative: _____

Corner Rpt: C.S. 64/51

Corner Designation

1/4 S15 | S14

DOUGLAS COUNTY

~~Condition Report Only~~

~~Not Found~~

Renewed

~~Unrecorded~~

~~Surveyed In~~

~~Referenced Out~~

MONUMENT DETAIL

Previous Renewals 1921 EPPSTEIN, 1960 BYRON

Monument(s) Found: (Condition and Source)

2 1/2" DIA BRASS CAP ON A 1 1/4"
O.D. IRON PIPE PROTRUDING 19"
ABOVE GROUND (1960)

1/2" STEEL BAR WITH HOOK IS
FOUND FLUSH WITH GROUND ALONG
WEST EDGE OF BC/IP. (1921)

COUNTY SURVEYORS OFFICE
T27S R5W

1/4 S15 | S14

1960

Accessories Found:

NO ORIG. OR BT'S FROM 1921 EPPSTEIN RENEWAL
FOUND

1 1/4" W. OAK NOW EVIDENCE OF ROOTS FOUND BEARS
S45°W 34.9 FT AGREES WITH RECORD. (1960)

Monument Set (Procedure and Description)

Monument Detail

NONE

N/A

New Accessories

- 19" DIA W. OAK DOUBLE BLAZED AND SCRIBED "Y4S15CS BT" BEARS S 30 1/2° W, 49.7 FT
- 21" DIA. W. OAK SINGLY BLAZED AND SCRIBED "Y4S15CS BT" BEARS S 11 1/2° W, 32.7 FT (NOTE CNTOR BLAZE 1 1/2 FT ABOVE GROUND)
- DOUBLE TRUNKED B. OAK DOUBLE BLAZED AND SCRIBED "Y4S14CS BT" ON WESTERLY 19" TRUNK ROOT CROWN BEARS N 18° E, 133.2 FT
- 14" MADRONE BARK SCRIBED "Y4S14CS BT" BEARS N 6° E, 89.2 FT

Sketch of Monument, Accessories, and General Area

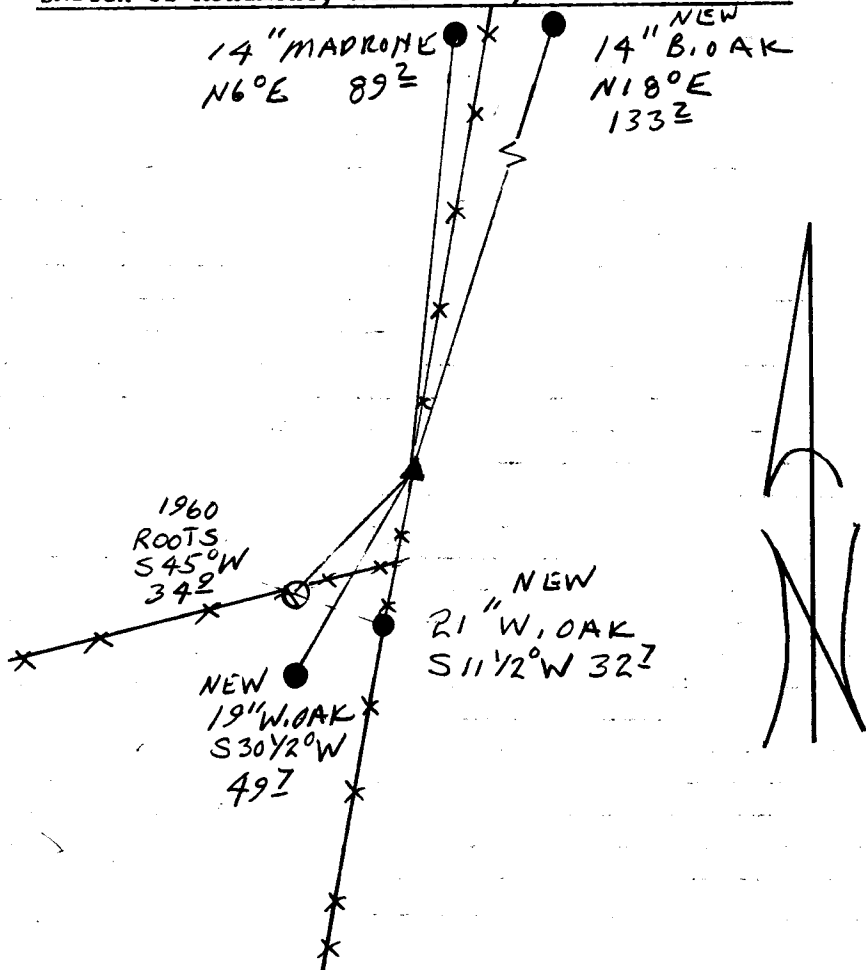

Location & Comments

CORNER LIES 1 FT EAST OF A NORTHERLY-SOUTHERLY FENCE LINE.

Comp. Declin. 17 3/4° E
 Agency DCSG
 Party Chief RANDALL W. SMITH
 Notekeeper Randall W. Smith
 Witnesses STEPHEN J. FLAUSE

Address

Surveyor's Seal

REGISTERED PROFESSIONAL LAND SURVEYOR

Randall W. Smith

EXPIRES 12-31-94

OREGON
 JULY 25, 1990
 RANDALL W. SMITH
 2489