

GOVERNMENT CORNER RESTORATION FORM

Date: 5/31/94 By: JC
This survey consists of:
Map: _____
Narrative: _____
Corner Rpt: C.564/51

Township 20S Range 12W Sec. 26 County DOUGLAS
State OR Date 4-21-94 No. _____

Corner Designation

S27/S26
S34/S35

DOUGLAS COUNTY
SURVEYOR

- Condition Report Only
- Not Found
- Renewed
- Unrecorded
- Surveyed In
- Referenced Out

Previous Renewals #58

Monument(s) Found: (Condition and Source)

1/2" I.D. IRON PIPE PROTRUDING
8" ABOVE GROUND, REN 58

N/A

Accessories Found:

24" NOW 60" DIA. 10' HIGH SPRUCE STUMP NO BLAZES
OR SCRIBING VISIBLE, BEARS N66 1/2° W, 43.5 FT
TO ROOT CROWN (REC N61° W, 35.6 FT IS A POSSIBLE
BLAZE MEASUREMENT). ORIG. BT

40" NOW 48" DIA. 8' HIGH ROTTED SPRUCE STUMP
WITH SCRIBING VISIBLE " 34" BEARS S88° W, 73.2 FT,
TO ROOT CROWN (REC S88° W 65.3 FT IS A POSSIBLE
BLAZE MEASUREMENT) ORIG BT

30" NOW 50" DIA. 8' HIGH SPRUCE STUMP WITH
ILLEGIBLE SCRIBE MARK VISIBLE IN A PREVIOUSLY
OPENED BLAZE BEARS S64° E, 12.7 FT (REC
S64° E, 11.2 FT IS A BLAZE MEASUREMENT).
ORIG. BT

CX

RENEWAL

Monument Set (Procedure and Description)

2 3/8" DIA. BRASS CAP ON A 1 3/8" O.D. IRON PIPE IS SET AT REFERENCED POSITION OF 1/2" I.P. BC/I.P. PROTRUDES 7" ABOVE GROUND

1/2" IRON PIPE MEASURED 27" LONG WHEN REMOVED IS SET ALONG NORTH EDGE OF BC/I.P. PROTRUDES 7" ABOVE GROUND.

Monument Detail

DOUGLAS COUNTY SURVEYORS

T 20 S

R

S 27 | S 26

1

S 34 | S 35

2

W

1994
OFFICE

New Accessories

- 6" DIA SPRUCE DOUBLE BLAZED "T 20 S R 12 W S 27 C S B T"
- BEARS N 34° W, 29.1 FT
- 24" DIA 2 FT HIGH HEMLOCK STUMP WITH BOAT SPIKE THROUGH BT TAG SET NEAR CNT. ON TOP, BS STAMPED "B02", BS BEARS S 2° E, 36.4 FT
- 30" DIA 1/2 FT HIGH SPRUCE STUMP WITH BOAT SPIKE THROUGH BT TAG SET NEAR CNT. ON TOP, BS STAMPED "B01", BS BEARS N 83 1/2° E, 38.8 FT
- 26" DIA 1/2 FT HIGH HEMLOCK STUMP WITH BOAT SPIKE THROUGH BT TAG SET NEAR CNT. ON TOP, BS STAMPED "B03", BS BEARS S 58 1/2° W, 17.9 FT

Sketch of Monument, Accessories, and General Area

Location & Comments

CORNER LIES IN A NEW CLEAR CUT

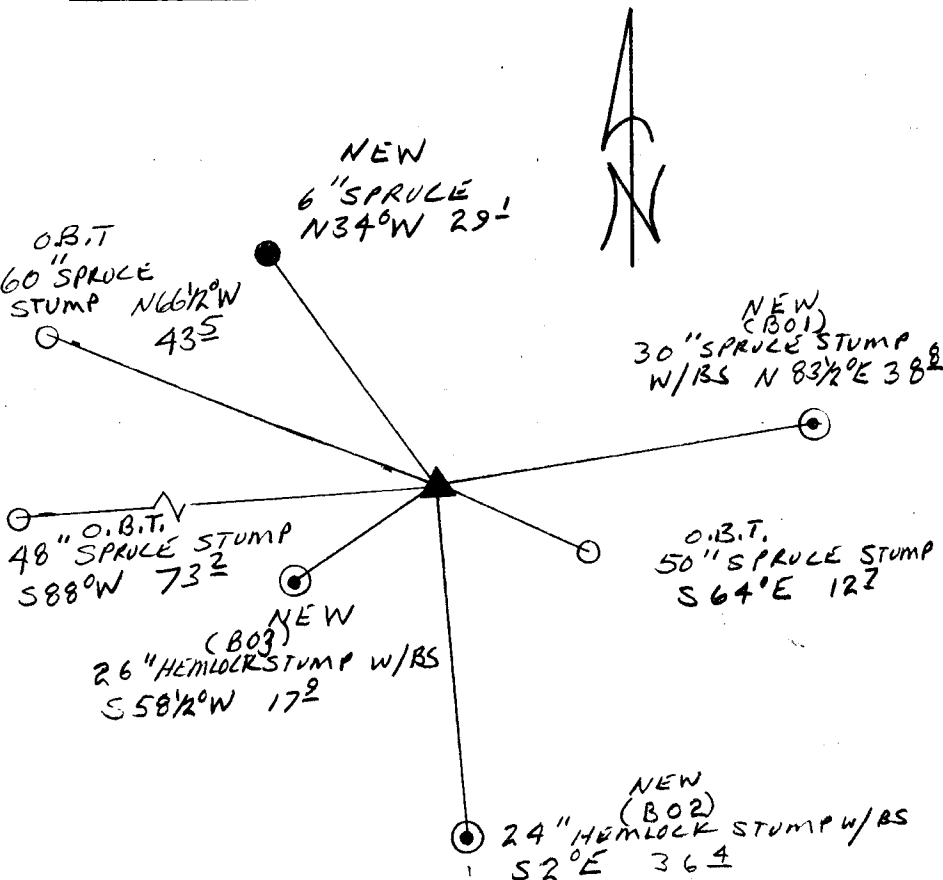

Comp. Declin. 17 3/4° E
 Agency DCSB
 Party Chief RANDALL W. SMITH
 Notekeeper *Randall W. Smith*
 Witnesses STEPHEN J. FLAISE

Address

Surveyor's Seal

REGISTERED
PROFESSIONAL
LAND SURVEYOR

Randall W. Smith
EXPIRES 12-31-94

OREGON
JULY 25, 1990
RANDALL W. SMITH
2489