

RENEWAL

Monument Set (Procedure and Description)

Monument Detail

A 2 3/8" DIA BRASS CAP ON
 A 1 3/8" O.D BY 32" LONG
 IRON PIPE IS SET AT REC,
 BRG AND DISTANCE FROM
 REMAINING ORIG. BT, BC/IP
 PROTRUDES 3" ABOVE GROUND

DOUGLAS COUNTY SURVEYORS
 R SW
 T 27 S
 S 10
 1/4 515
 1994
 OFFICE

New Accessories

14" DIA. W. OAK DOUBLE BLAZED AND SCRIBED "1/4 S10 CS BT"
 BEARS N 12° W, 38.0 FT

9" DIA. B. OAK DOUBLE BLAZED AND SCRIBED "1/4 S10 CS BT"
 BEARS N 77° E, 31.7 FT

18" DIA. D. FIR DOUBLE BLAZED AND SCRIBED "1/4 S15 CS BT"
 BEARS S 10 1/2° W, 70.2 FT

Sketch of Monument, Accessories, and General Area

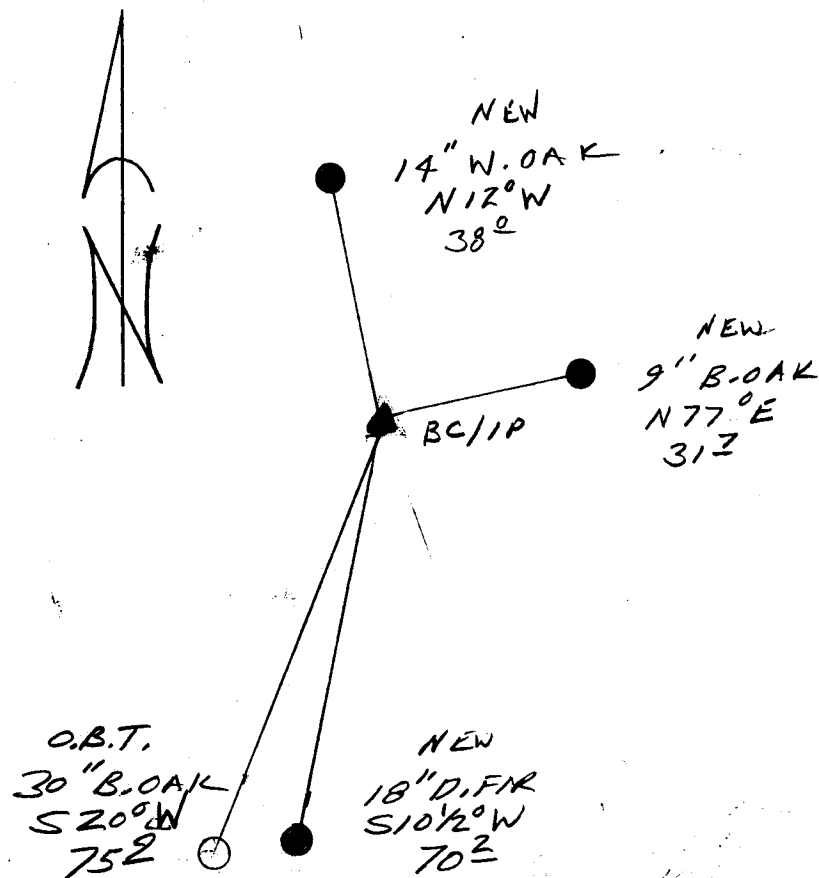

Location & Comments

Comp. Declin. 17 3/4° E
 Agency DCSA
 Party Chief RANDALL W SMITH
 Notekeeper RANDALL W SMITH
 Witnesses STEPHEN J FLANSB

Address

Surveyor's Seal

REGISTERED
 PROFESSIONAL
 LAND SURVEYOR

Randall W Smith
 EXPIRES 12-31-94

OREGON
 JULY 25, 1990
 RANDALL W. SMITH
 2489