

GOVERNMENT CORNER RESTORATION FORM

FILED

Date: 3-15-94 By: JC

This survey consists of

Township 27S Range 5W Sec. 34 County DOUGLAS

Map: _____

State OR Date 12-13-93 No. _____

Narrative: _____
Corner Rpt: C.S. 64/50

Corner Designation

S34/S35
S3/S2

DOUGLAS COUNTY

SURVEYOR

Condition Report Only

Not Found

Renewed

Unrecorded

Surveyed In

Referenced Out

MONUMENT DETAIL

Previous Renewals 1959 BYRON PI# 500100

Monument(s) Found: (Condition and Source)

A 2 1/2" DIA DCSO BRASS CAP
ON A 1 1/2" DIA. IRON PIPE
PROTRUDING 12" ABOVE GROUND,
(1959)

COUNTY SURVEYORS OFFICE

T 27 S R 5 W

S34/S35

S3/S2

T 28 S R 5 W

1959

Accessories Found:

10" NOW 37" DIA B. OAK WITH FULLY HEALED BLAZES
BEARS N 62 1/2° E, 23.0 FT (REC N 62 1/2° E 21.8 FT) O.B.T.

26" NOW 36" DIA 10' HIGH HOLLOWED AND BURNED
OAK SNAG NO BLAZES OR SCRIBING VISIBLE BEARS
S 33 1/2° E 55.0 FT (AGREES WITH 1959 REN) O.B.T.

NO EVIDENCE OF ANY OTHER ORIG BT'S FD.

28" NOW 36" DIA. B. OAK WITH A FULLY HEALED DOUBLE BLAZE
BEARS S 28 1/2° W, 69.8 FT (AGREES WITH REC.) 1959 REN

11" NOW 19" DIA W. OAK WITH A FULLY HEALED DOUBLE BLAZE
BEARS N 3 1/2° W, 59.9 FT (REC N 1/2° W 59.9 FT) 1959 REN.

27-5 500100

24-5 500700

C.S. File No. 64/50

RENEWAL

Monument Set (Procedure and Description)

Monument Detail

NONE

N/A

New Accessories

21" DIA W. OAK DOUBLE BLAZED AND SCRIBED "T28S R5W S2 CS BT"
BEARS S27 1/2° E, 113.7 FT

Sketch of Monument, Accessories, and General Area

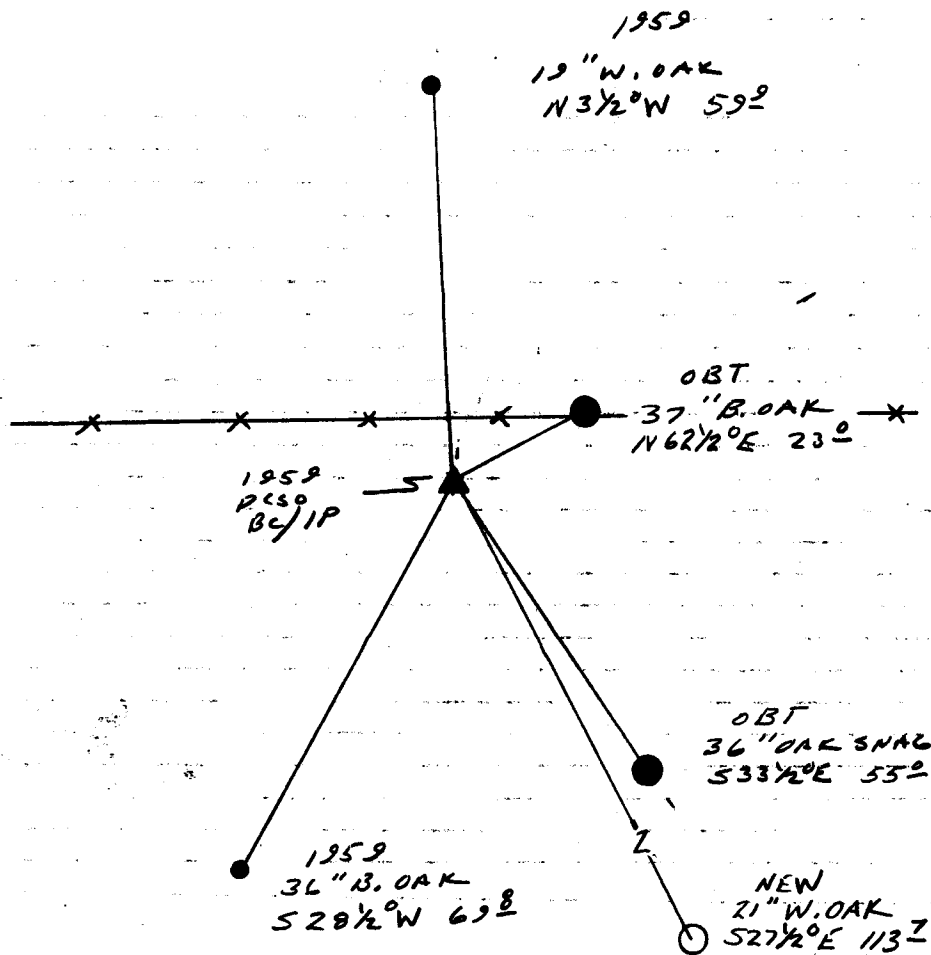

Location & Comments

EAST — WEST FENCE
LINE IS TO NORTH
OF CORNER.

Comp. Declin. 17 3/4° E
Agency DCSO
Party Chief RANDALL W. SMITH
Notekeeper Randall W. Smith
Witnesses STEPHEN J. FLAISE

Address

Surveyor's Seal

REGISTERED
PROFESSIONAL
LAND SURVEYOR

Randall W. Smith
EXPIRES 12-31-94

OREGON
JULY 25, 1990
RANDALL W. SMITH
2469