

GOVERNMENT CORNER RESTORATION FORM

Date: 3-15-94 By: JC

Township 27S Range 5W Sec. 24 County DOUGLAS This survey consists of:

State OR Date 11-18-93 No. _____

Map: _____

Narrative: _____

Corner Rpt: C.S. 64/50

Corner Designation

SW COR
DLC 50

- DOUGLAS COUNTY
- Condition Report Only
- Not Found
- Renewed
- Unrecorded
- Surveyed In
- Referenced Out

Previous Renewals 1953 BBI PI# 050050

Monument(s) Found: (Condition and Source)

CORNER LIES AT THE INTERSECTION OF PAVED ROADS. A STRING METAL SIGNAL WAS NIPPED AT APPROX. POSITION OF CORNER.

N/A

Accessories Found:

ONE TIE FROM 1953 BBI RENEWAL REMAINS A 1/4" DIA COPPER ROD SET IN CONCRETE BEARS $\Delta 25^{\circ} 16'$, 41.26 FT (AGREES WELL WITH 1953 BBI REN AND RECENT SURVEYS)

X

Monument Set (Procedure and Description)

Monument Detail

NONE

N/A

New Accessories

BRG'S ARE TRUE

- DCSO BC IN CONC. MON. "DIXIE 1980" BEARS S 71°56'36"W, 100.08 FT
- DCSO BC IN CONC. MON. "DIXIE RMI 1980" BEARS N 69°57'23"W, 96.44 FT
- OGS BC IN CONC. MON. "S 83 F 253 1934" BEARS S 20°48'13"E, 45.13 FT
- 5/8" I.R. BEARS N 47°34'28"E, 43.04 FT
- 5/8" I.R. BEARS N 61°34'04"E, 60.95 FT

Sketch of Monument, Accessories, and General Area

Location & Comments

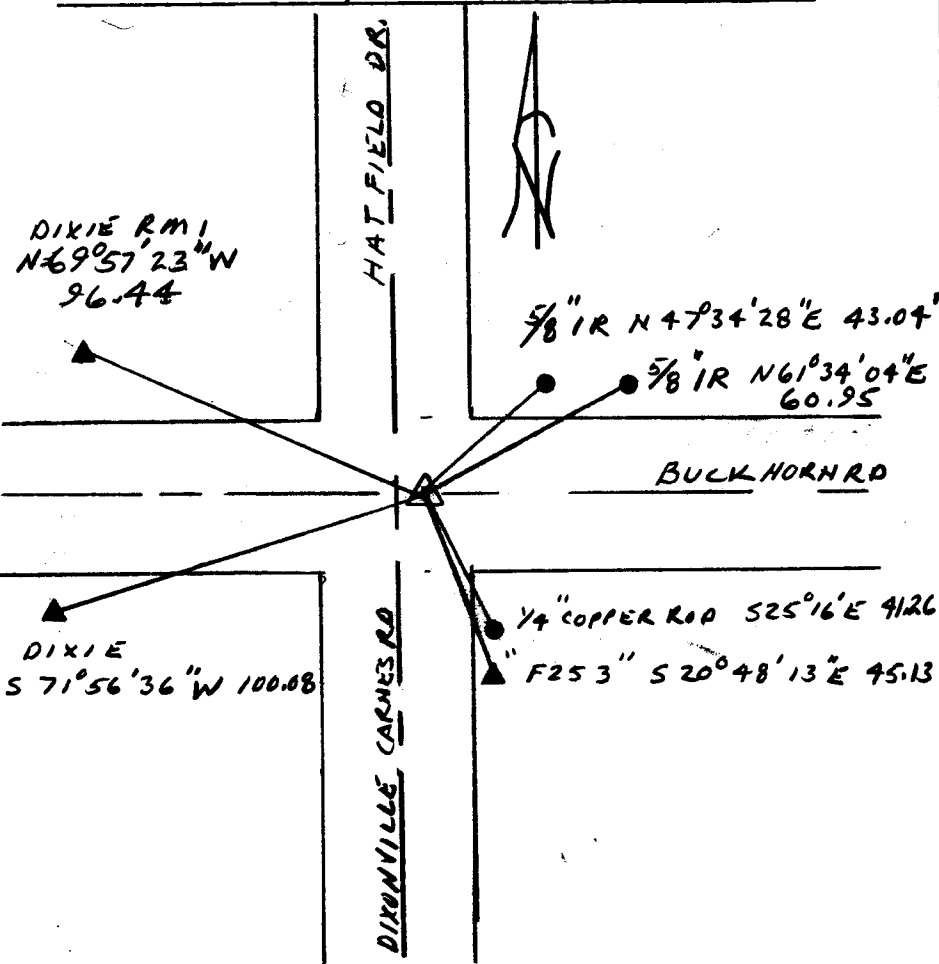

Location & Comments

Comp. Declin. 17 3/4° E

Agency DLSS

Party Chief RANDALL W SMITH

Notekeeper Randall W Smith

Witnesses STEPHEN J FLAISE

Address _____

REGISTERED Surveyor's Seal
 PROFESSIONAL
 LAND SURVEYOR
Randall W Smith
 EXPIRES 12-31-94
 OREGON
 JULY 25, 1990
 RANDALL W. SMITH
 2469