

GOVERNMENT CORNER RESTORATION FORM

Date: 3-15-94 By: JC

This survey consists of:

Township 27S Range 5W Sec. 14 County DOUGLAS

Map: \_\_\_\_\_

State OR

Date 12-8-93

No. \_\_\_\_\_

Narrative: \_\_\_\_\_

Corner Rpt: C.S. 64/50

Corner Designation

$\frac{1}{4}$   $\frac{S14}{S23}$

DOUGLAS COUNTY

Condition: Report Only

Not Found

Renewed

Unrecorded

Surveyed In

Referenced Out

MONUMENT DETAIL

PI # 540400

Previous Renewals VOL 4 Pg 72, 1949 GODFREY CS 43/24

Monument(s) Found: (Condition and Source)

A CONGLOMERATE STONE, TOP  
MEASURES 7" X 7" PRITHMS 3"  
ABOVE GROUND. (VOL 4 PG 72)

2" LP FD 6" BELOW GROUND  
0.4 FT SOUTH OF STONE. (1949 GODFREY)

N/A

Accessories Found:

BRG'S AND DISTANCES FROM STONE  
10" NOW 25" DIA. W. OAK WITH A PREVIOUSLY OPENED BLAZE;  
SCRIBING IS VISIBLE, REOPEN BLAZE AND FIND MARK  
SCRIBING "BT", BEARS S76°E, 239.7 FT  
(ORIG REC S76°E, 233 FT; 1949 GODFREY FIELD NOTES CS 43/24  
S 75°41'10"E, 239.7 FT) ORIG BT

ORIG. NE BT IS GONE. (ORIG REC. N76°E, 95 FT; 1949  
GODFREY FIELD NOTES CS 43/24 N76°21'50"E, 96.3 FT).

24" NOW 51" DIA DOUBLE TRUNKED B. OAK, WITH A FULLY  
HEALED DOUBLE BLAZE ON 37" DIA SOUTHERLY TRUNK.  
BEARS N127°20'W, 129.7 FT TO CENTER OF SOUTHERLY TRUNK.  
(AGREES WITH REC.) 1949 GODFREY

14" NOW 41" DIA. MULTI TRUNKED W. OAK, WITH A FULLY  
HEALED DOUBLE BLAZE ON 21" DIA NORTHERLY TRUNK.  
BEARS S73°E, 197.6 FT TO CENTER OF NORTHERLY TRUNK.  
(AGREES WITH REC.) 1949 GODFREY

RENEWAL

Monument Set (Procedure and Description)

REFERENCED STONE, A 2 3/8" DIA. DCSD BRASS CAP ON A 1 3/8" O.D. BY 32" LONG IRON PIPE IS SET AT REFERENCED POSITION BC/IP PROTRUDES 5" ABOVE GROUND. STAKE MEASURED 16" X 12" X 8" (REC. 7" X 7" X 16") IS RESET ALONG NORTH EDGE OF BC/IP PROTRUDING 3" ABOVE GROUND. 2" I.P. IS UNDISTURBED AT SOUTH 0.1 FT 6" BELOW GROUND.

Monument Detail

DOUGLAS COUNTY SURVEYORS  
T276-R5W

1/4 S14 R  
S23 VI

1994

OFFICE

POSSIBLE EXPLANATION FOR DOUBLE FIELD NOTES IS THAT ONE SET OF NOTES USED STAFF COMPASS WITH BAD DECLINATION DURING FIELD SEARCH OF CORNER, AND A SET OF NOTES FROM FIELD SURVEY THAT SHOWS BEN. TREE TIES.

New Accessories

9" DIA. B. OAK DOUBLE BLAZED AND SCRIBED "1/4 S23 CS BT"  
BEARS 576 1/4° W, 85.5 FT

855  
Sketch of Monument, Accessories, and General Area

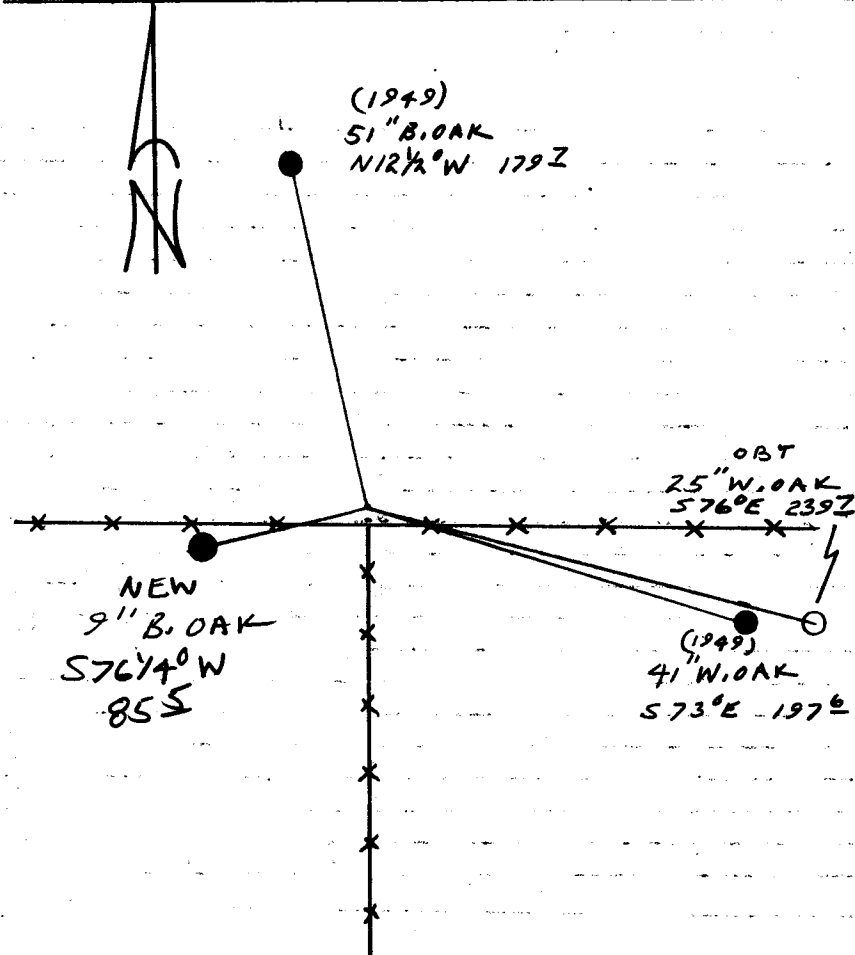

Location & Comments

CONFUSION IN OBT TIES FROM 1949 GOODFREY CS 43/74 COMES FROM INCOMPLETE BT RECORD OF OBT IN 1949 GOODFREY COR. REN. PT# 540400 AND A DOUBLE SET OF CORNER FIELD NOTES IN CS 43/74. I USED MOST COMPREHENSIVE SET OF NOTES THAT AGREED WELL WITH REMAINING EQ OBT.

Comp. Declin. 17 3/4° E  
Agency DCSD  
Party Chief RANDALL W. SMITH  
Notekeeper Randall W. Smith  
Witnesses STEPHEN J. FLAUS

Address

Surveyor's Seal  
REGISTERED PROFESSIONAL LAND SURVEYOR  
Randall W. Smith  
EXPIRES 12-31-94  
OREGON  
JULY 25, 1990  
RANDALL W. SMITH  
2469