

Monument Set (Procedure and Description)

Monument Detail

NONE

N/A

New Accessories

13" DIA. W. OAK DOUBLE BLAZED AND SCRIBED "1/4 S 25 CS BT"
BEARS S 79° W, 61.8 FT

5" DIA. D. FIR DOUBLE BLAZED AND SCRIBED "1/4 S 24 CS BT"
BEARS N 65° W, 34.5 FT

9" DIA. D. FIR DOUBLE BLAZED AND SCRIBED "1/4 S 25 CS BT"
BEARS S 80° E, 26.4 FT

Sketch of Monument, Accessories, and General Area

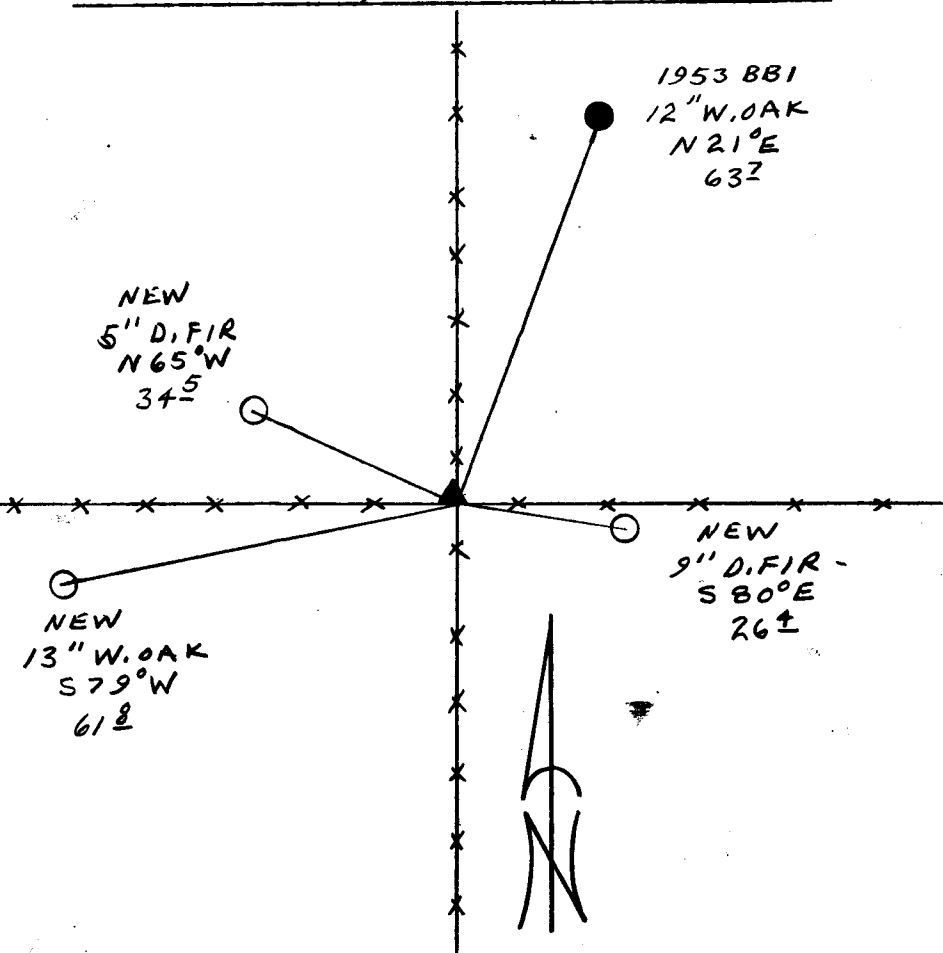

Location & Comments

CORNER LOCATED AT THE INTERSECTION OF A 4 WAY FENCE CORNER.

Comp. Declin. 17 3/4° E
Agency DCSO
Party Chief RANDALL W. SMITH
Notekeeper Randall W. Smith
Witnesses STEPHEN J. FLAUSE

Address

REGISTERED Surveyor's Seal
PROFESSIONAL LAND SURVEYOR
 EXPIRES 12-31-94
Randall W. Smith
 OREGON
 JULY 25, 1990
RANDALL W. SMITH
 2468