

Date: 3-15-94 By: JC

GOVERNMENT CORNER RESTORATION FORM

This survey consists of:

Township 27S Range 4W Sec. 18 County DOUGLAS

Map: _____

State OR Date 12-6-93 No. _____

Narrative: _____

Corner Rpt: C.S. 64/50

Corner Designation

S 13 | S 18
S 24 | S 19

DOUGLAS COUNTY SURVEYOR

Condition Report Only

Not Found

Renewed

Unrecorded

Surveyed In

Referenced Out

MONUMENT DETAIL

Previous Renewals 1953 BBI PI# 700400

Monument(s) Found: (Condition and Source)

A 2 1/2" DIA DCSO BRASS CAP ON A
1 1/2" O.D IRON PIPE FLUSH WITH
GROUND. (IN ROSEBURG LUMBER
SLAB METAL HEAP).
BC/IP BENT 0.3 EAST OF
PLUMB

COUNTY SURVEYORS OFFICE

R 5W 13 | 18 W
24 | 19 R

T 27S

Accessories Found:

N/A

RENEWAL

Monument Set (Procedure and Description)

Monument Detail

NONE

BC/IP RETURNED TO PLUMB.

N/A

New Accessories

5/8" I.R. WITH ALUM. CAP MARKED "F1" PROTRUDES 8" ABOVE GROUND.

BEARS N 77° 1/2' W, 163.31 FT

5/8" I.R. WITH ALUM. CAP MARKED "X1" PROTRUDES 3" ABOVE GROUND, BEARS

N 20° 1/4' E, 433.41 FT

NW COR OF A 15 SQUARE CONC. BASE OF A RSBG LUMBER METAL POWER TOWER

BEARS S 38° 1/2' E 186.9 FT

EASTERLY COR OF A PACIFIC POWER SUB. STATION CORNER POST S 26° W, 181.75'

Sketch of Monument, Accessories, and General Area

Location & Comments

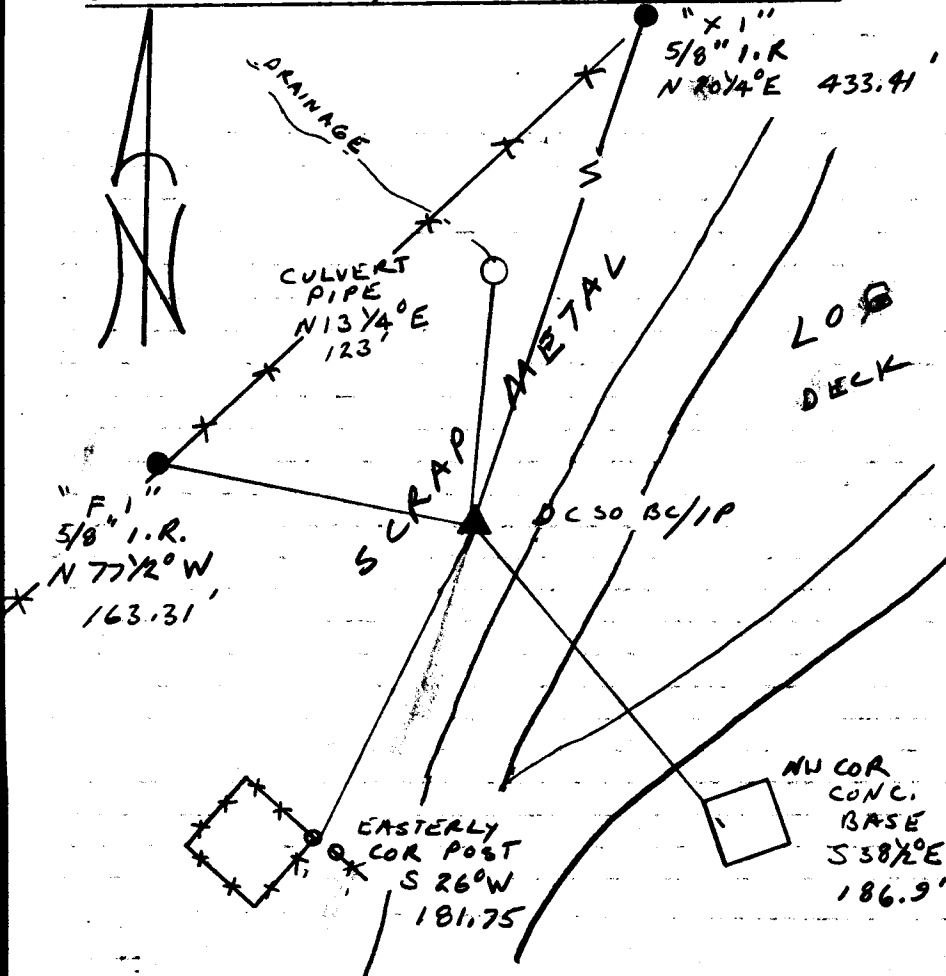

Location & Comments

Comp. Declin. 1734'0"

Agency DCSO

Party Chief RANDALL W SMITH

Notekeeper Randall W Smith

Witnesses STEPHEN J FLAUSE

Address _____

Surveyor's Seal

REGISTERED
PROFESSIONAL
LAND SURVEYOR

Randall W Smith
KNPIES 12-31-94

OREGON
JULY 25, 1990
RANDALL W. SMITH
2489