

R

FILED

GOVERNMENT CORNER RESTORATION FORM

Date: 3-15-94 By: JC

Township 27S Range 4W Sec. 7 County DOUGLASS

State OR Date 1-27-94 No. _____ Corner C.S. 64/50

Corner Designation

S12/S7
S13/S18

DOUGLASS COUNTY

Condition Report Only

Not Found

Renewed

Unrecorded

Surveyed In

Referenced Out

MONUMENT DETAIL

Previous Renewals 1953 BBI PI # 700500

Monument(s) Found: (Condition and Source)

2 1/2" DIA BRASS CAP ON 1 1/2"
O.D. IRON PIPE PROTRUDING
6" ABOVE GROUND.

COUNTY SURVEYORS OFFICE

T 27S

R 5W 12/7
13/18 R 4W

Accessories Found:

20" NOW 30" DIA DEAD B. OAK WITH A FULLY HEALED SINGLE
BLAZE BEARS N 22° E, 33.8 FT (REC N 26° E, 33.0 FT
DIST. POSSIBLE FACE MEASUREMENT). OBT

12" NOW 33" DIA B. OAK WITH A PARTIALLY HEALED OPEN BLAZE
NO SCRIBING VISIBLE, BEARS S 77 1/2° E, 29.0 FT (REC
S 75° E, 30.8 FT) OBT

18" NOW 35" DIA 12' HIGH ALIVE B. OAK WITH SAWED OFF TOP
AND A FULLY HEALED SINGLE BLAZE BEARS N 82 1/2° W,
57.3 FT (REC N 85° W, 60.8 DIST. IS ASLOPE MEASUREMENT)
OBT

ORIG SW BT NOW GONE

36" DIA. NOW 36" DIA 2 FT HIGH B. OAK STUMP, NO
BLAZES OR SCRIBING VISIBLE, BEARS S 62 1/2° W,
81.8 FT (REC S 60° W, 81.8 FT) 1953 BBI

27-4 100500
27-5 700500

C.S. File No. 64/50-4

X

Monument Set (Procedure and Description)

Monument Detail

N/A

N/A

New Accessories

15" DIA W. OAK DOUBLE BLAZED AND SCRIBED " T27S R5W
S12 CS BT" BEARS N 39 1/2° W, 21.4 FT

12" DIA. W. OAK DOUBLE BLAZED AND SCRIBED " T27S R4W
S7 CS BT" BEARS N 31 1/4° E, 105.1 FT

Sketch of Monument, Accessories, and General Area

Location & Comments

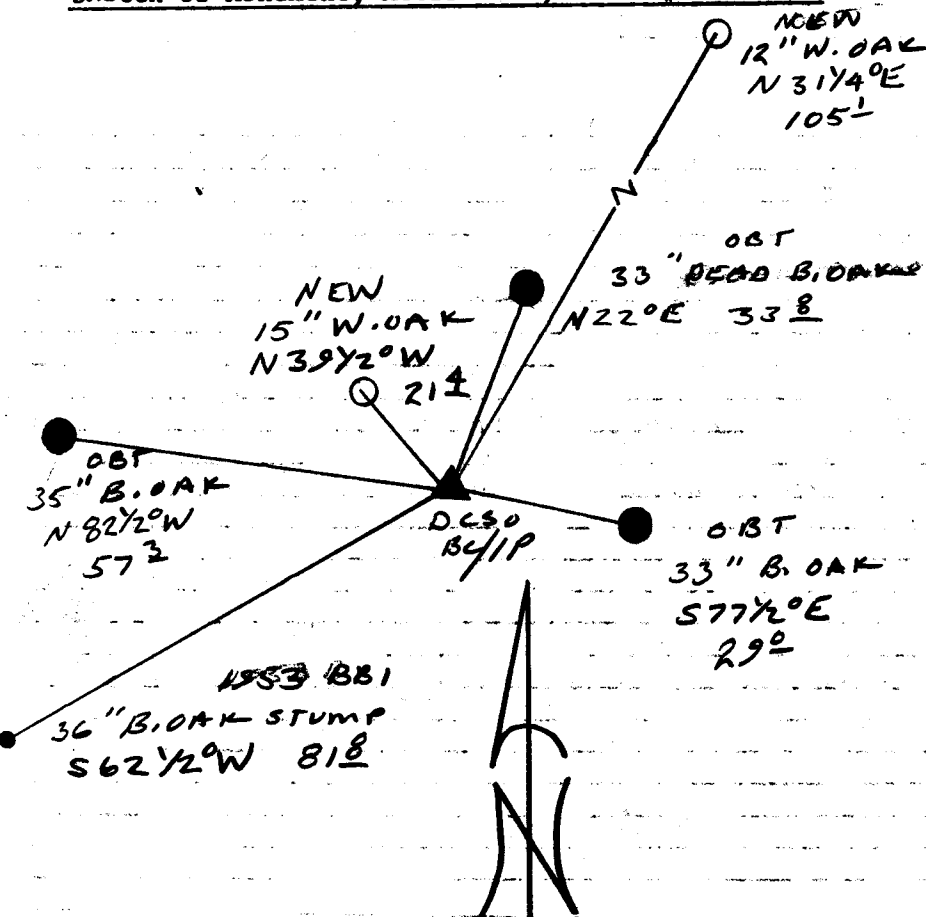

Comp. Declin. 17 3/4° E
 Agency DCSO
 Party Chief RANDALL W. SMITH
 Notekeeper Randall W. Smith
 Witnesses STEPHEN J. FLAUSK

Address

Surveyor's Seal

REGISTERED
 PROFESSIONAL
 LAND SURVEYOR

Randall W. Smith
 EXPIRES 12-31-94

OREGON
 JULY 25, 1990
 RANDALL W. SMITH
 2489