

Monument Set (Procedure and Description)

Monument Detail

NONE

N/A

New Accessories

- 14" DIA. ASH DOUBLE BLAZED AND SCRIBED "SW DLC 61 CS BT" BEARS
S 73° W, 5.3 FT
- 9" DIA. POPLAR DOUBLE BLAZED AND SCRIBED "SW DLC 61 CS BT" BEARS
N 36 1/2° W, 15.9 FT
- 17" DIA W. OAK DOUBLE BLAZED AND SCRIBED "SW DLC 61 CS BT" BEARS
N 13° E, 6.9 FT
- 9" DIA. ASH DOUBLE BLAZED AND SCRIBED "SW DLC 61 CS BT" BEARS
S 5° E, 21.6 FT

Sketch of Monument, Accessories, and General Area

Location & Comments

CORNER LIES IN BOTTOM OF CREEK APPROX 50 FT EAST OF ROAD.

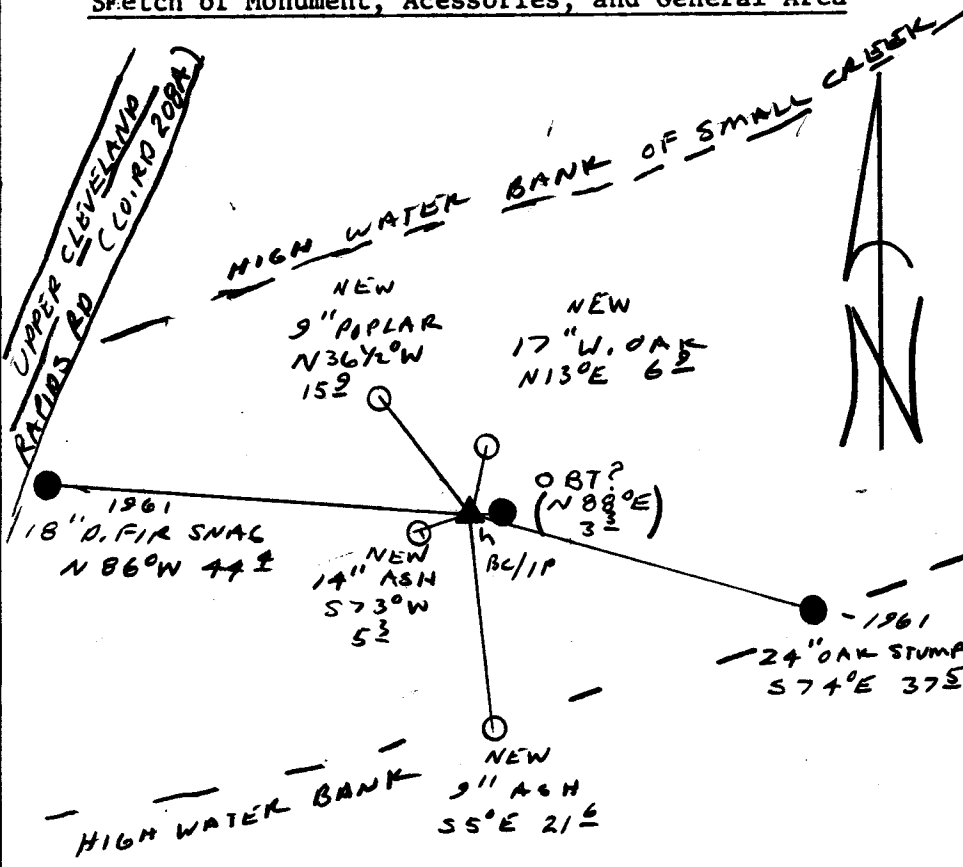

Comp. Declin. 18° E
 Agency DCSO
 Party Chief RANDALL W. SMITH
 Notekeeper Randall W. Smith
 Witnesses STEPHEN J. FLAUSÉ

Address

Surveyor's Seal

REGISTERED
 PROFESSIONAL
 LAND SURVEYOR

Randall W. Smith
 EXPIRES 12-31-94

OREGON
 JULY 25, 1990
 RANDALL W. SMITH
 2469