

GOVERNMENT CORNER RESTORATION FORM

FILED *PK*

Township 28S Range 5W Sec. 31 County DOUGLAS

NOV 16 1993

State OR Date 10-28-93 No. _____

COUNTY SURVEYOR
DOUGLAS COUNTY, ORE.

Corner Designation

$\frac{1}{4} \frac{S 31}{S 6}$

- _____ Condition Report Only
- _____ Not Found
- Renewed
- _____ Unrecorded
- _____ Surveyed In
- _____ Referenced Out

P111 140100

Previous Renewals 1920 RICHARDSON, 1961 BYRON

MONUMENT DETAIL

Monument(s) Found: (Condition and Source)

2 1/2" DIA BRASS CAP ON A
1 1/2" O.D. IRON PIPE PROTRUDING
19" ABOVE GROUND (1961 BYRON)

COUNTY SURVEYORS OFFICE

T 28S R5W

$\frac{1}{4} \frac{S 31}{S 6}$

T 29S

1961

Accessories Found:

20" NOW DOWN AND ROTTED OAK, ~~NO~~ BLAZES OR SCRIBING
VISIBLE, ROOT HOLE BEARS S 30° E, 30.9 FT
(REC S 29° E, 31.7 FT) 1920 RICHARDSON

16" NOW 17" DIA MADRONE WITH A PARTIALLY HEALED
DOUBLE BLAZE, SCRIBING VISIBLE, BEARS S 11° W, 26.7 FT
(REC S 13° W, 27.3 FT) 1961 BYRON

9" NOW 10" DIA MADRONE WITH A FULLY HEALED
DOUBLE BLAZE BEARS N 33° E, 9.8 FT (REC N 22° E,
8.8 FT) 1961 BYRON

3/4" I.D. IRON PIPE PROTRUDING 6" ABOVE GROUND
BEARS N 61 1/2° E, 3.1 FT (REC N 65° E, 4.0 FT)
SOURCE UNKNOWN

140100 ✓

Monument Set (Procedure and Description)

PLUMB POSITION OF DCSO BC/IP
 IS REFERENCED BY BC/IP. MONUMENT
 35" LONG. BC/IP IS SET AT
 REFERENCED POSITION, PROTRUDES 5"
 ABOVE GROUND.

N/A

New Accessories

6" DIA. D. FIR DOUBLE BLAZED AND SCRIBED " 1/4 S 6 CS BT "
 BEARS S 3 1/2° E, 13.3 FT

5" DIA. D. FIR DOUBLE BLAZED AND SCRIBED " 1/4 S 31 CS BT "
 BEARS N 27° W, 33.9 FT

Sketch of Monument, Accessories, and General Area

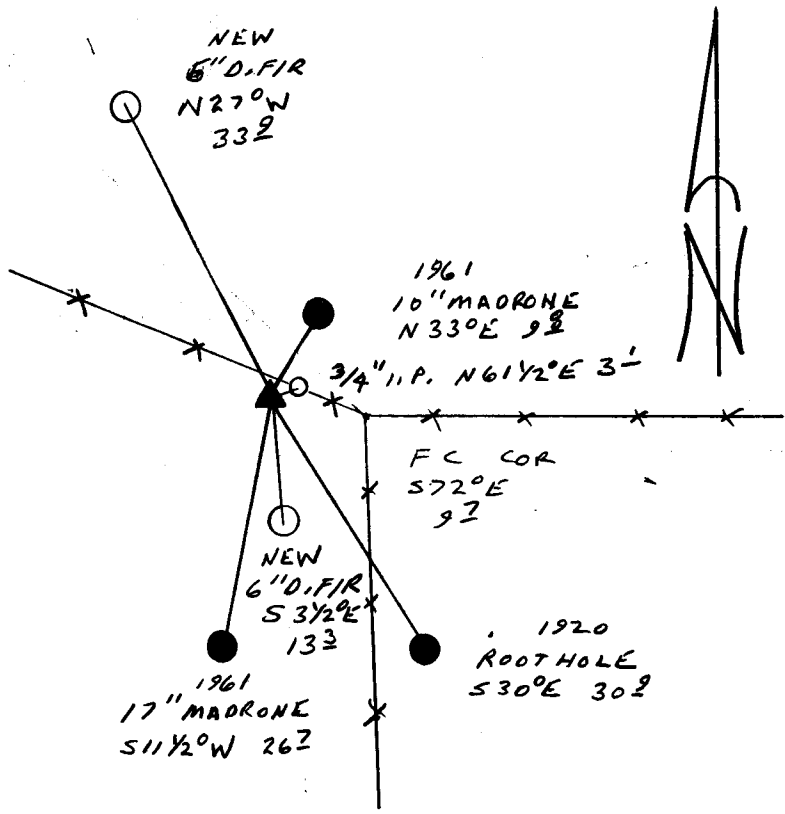

Location & Comments

Comp. Declin. 18° E
 Agency DCSO
 Party Chief RANDALL W. SMITH
 Notekeeper Randall W. Smith
 Witnesses STEPHEN J. FLAUSK

Address

Surveyor's Seal

REGISTERED
 PROFESSIONAL
 LAND SURVEYOR

Randall W. Smith
 EXPIRES 12-31-94

OREGON
 JULY 25, 1990
 RANDALL W. SMITH
 2489