

Monument Set (Procedure and Description)

Monument Detail

NONE

N/A

New Accessories

2 1/2" DIA. DCSSO BRASS CAP ON A 1 3/8" OD IRON PIPE PROTRUDING 8" ABOVE GROUND MARKED " T 285 " BEARS WEST 26.4 FT.

SW COR
DLC 51
R7W
1968

Sketch of Monument, Accessories, and General Area

Location & Comments

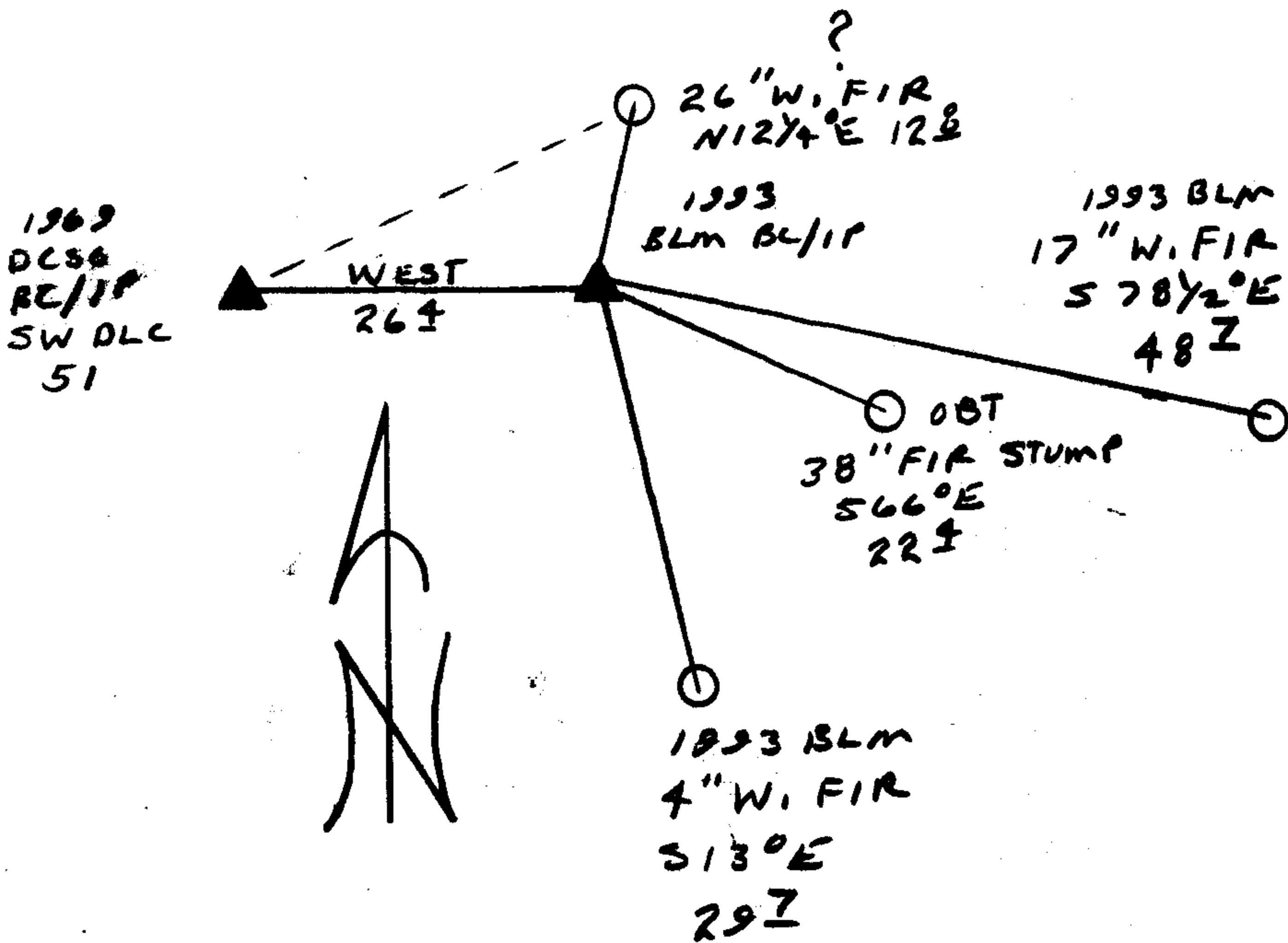

Comp. Declin. 18° E
Agency DCSSO
Party Chief RANDALL W. SMITH
Notekeeper Randall W. Smith
Witnesses STEPHEN J. FLAUSE

Address

REGISTERED PROFESSIONAL LAND SURVEYOR

Randall W. Smith
EXPIRES 12-31-94

OREGON
JULY 25, 1990
RANDALL W. SMITH
2488

Surveyor's Seal

Bear Field Crew,

BLM tie

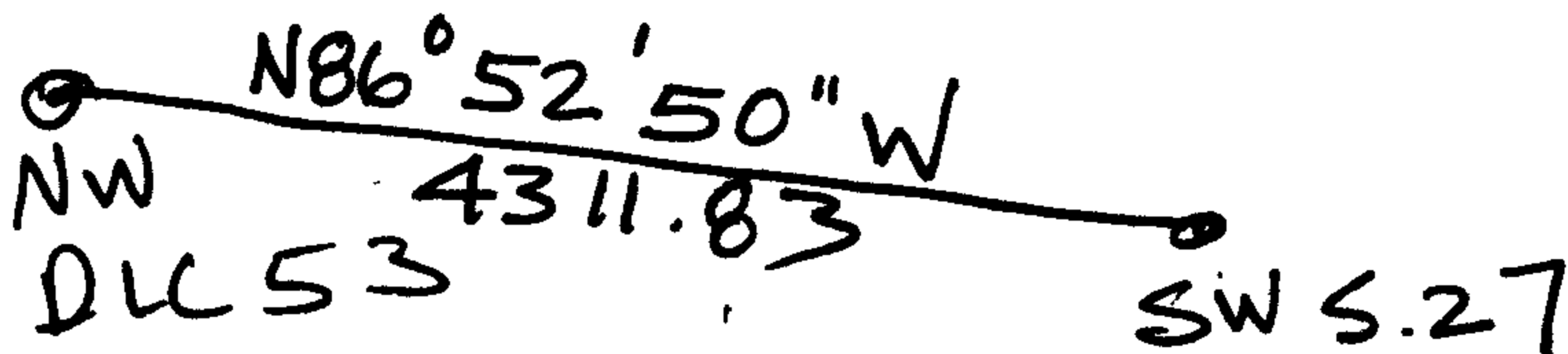

T 28 S R 7 W
S. 28

We still want SW DLC 51

Thanks

to SW S 28
C.S. File No. 64/47B

TRAVERSE SKETCH

RWS 9-30-95
SUF

HAND COMPASS BEGS
HORIZ DIST.

①

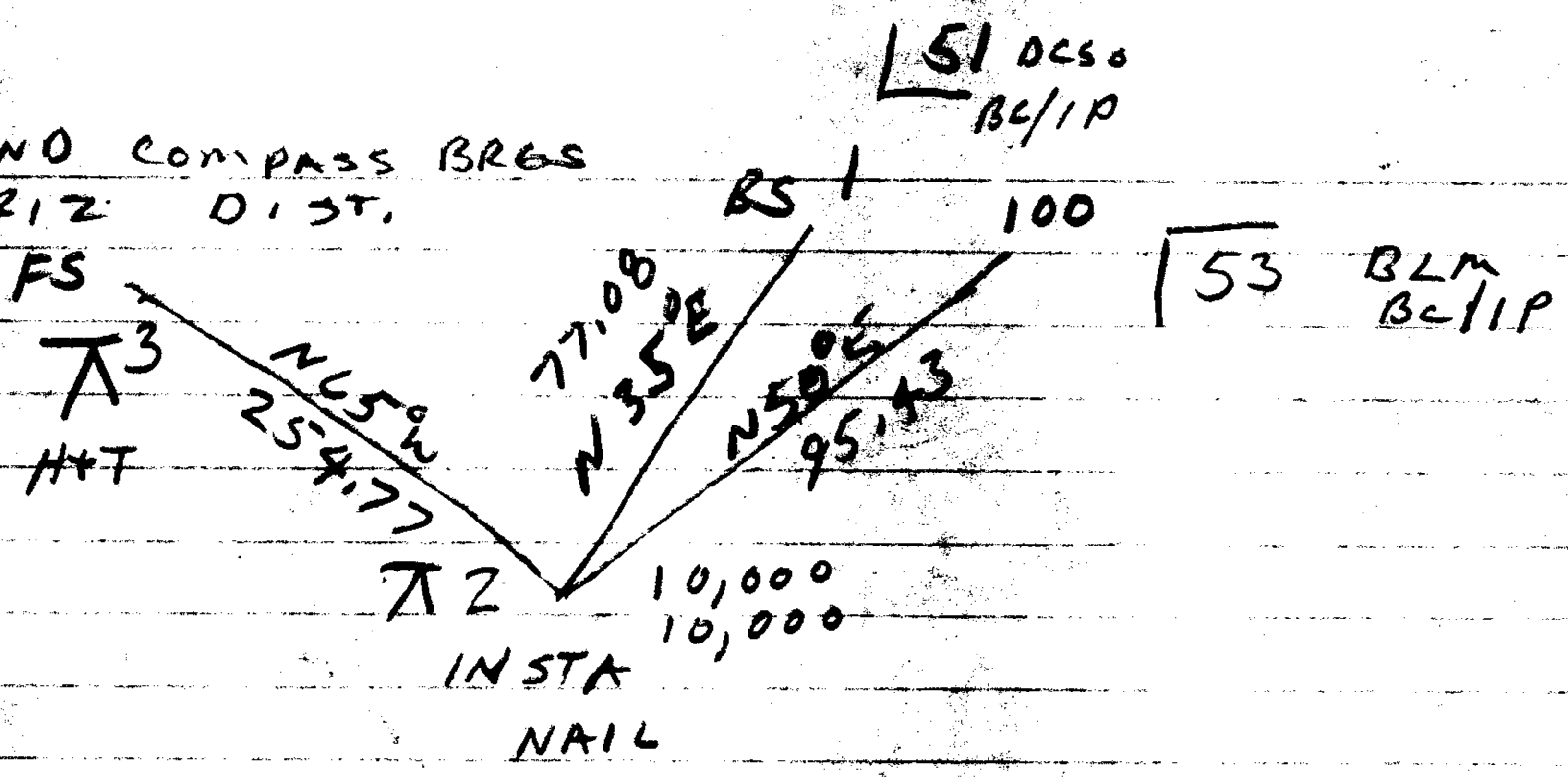

②

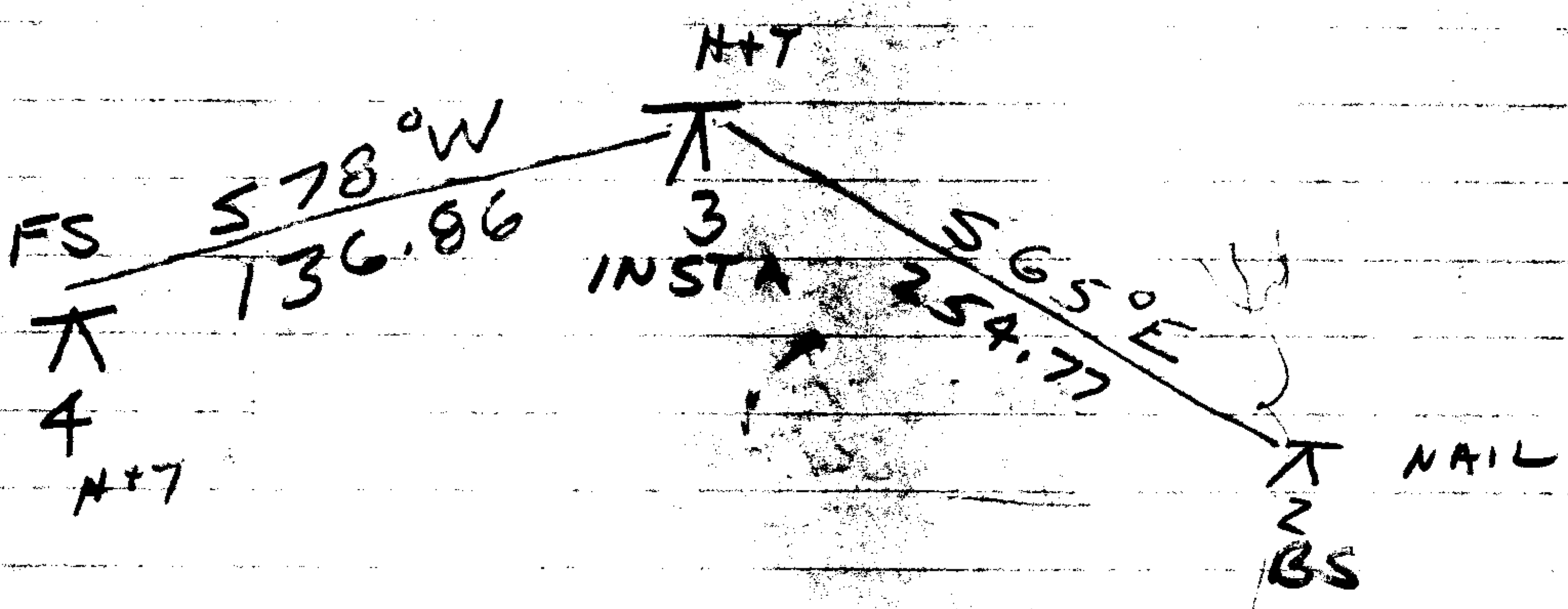

③

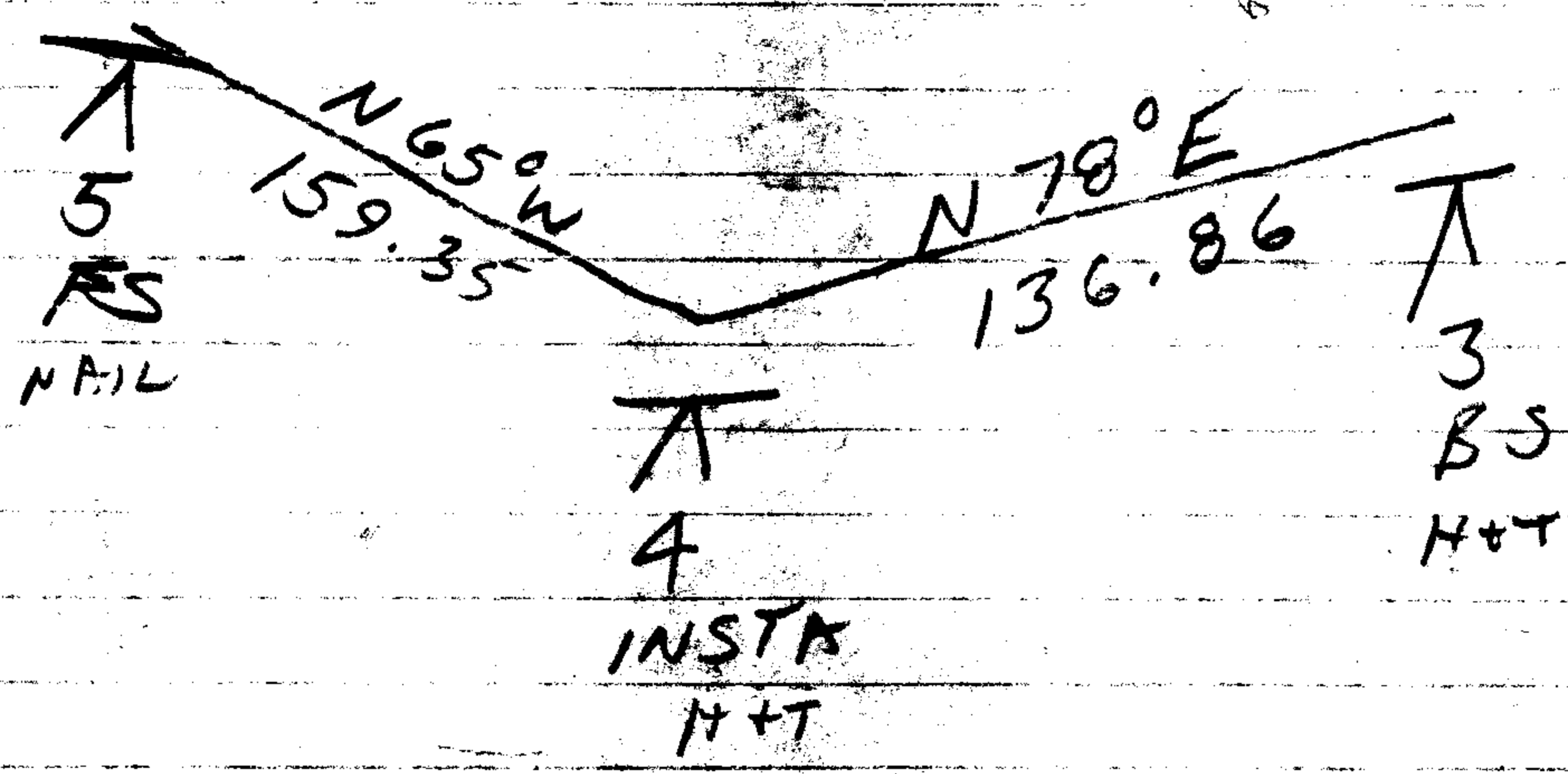

④

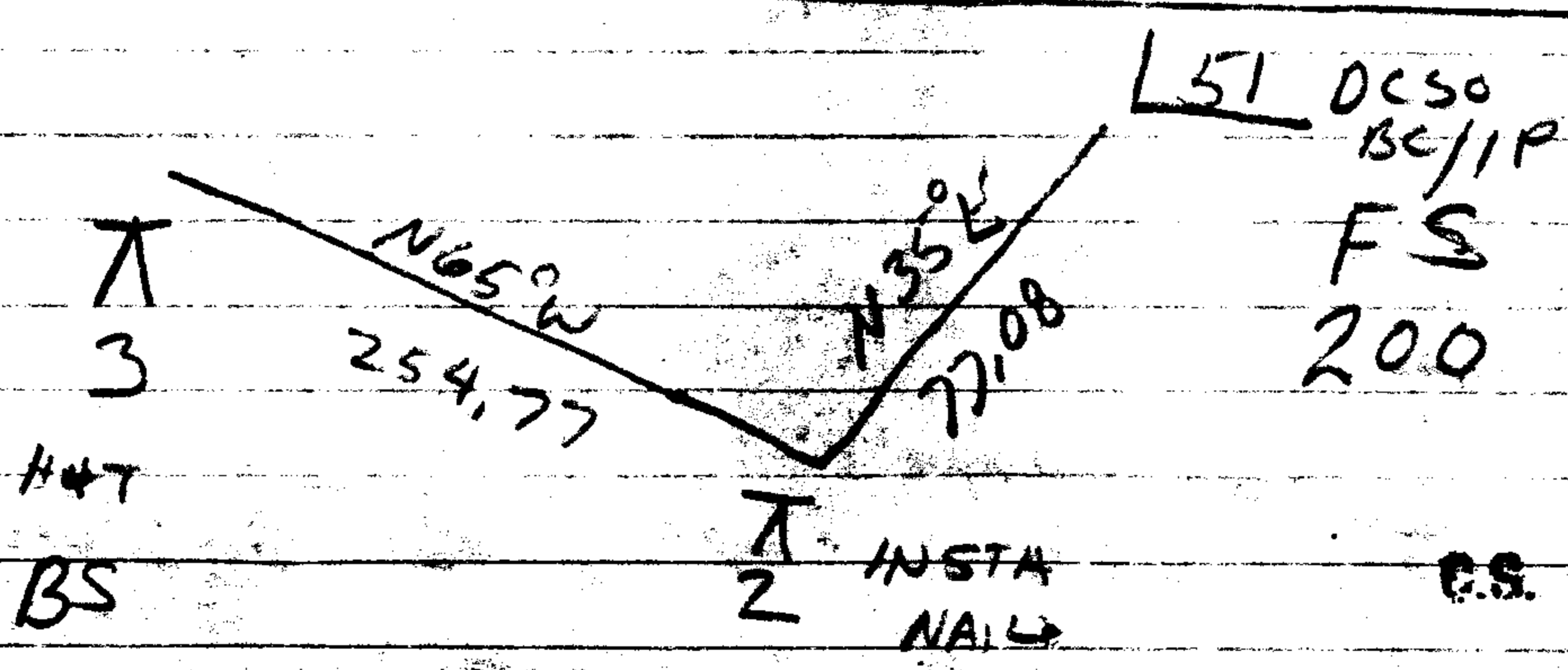

C.S. File No. 64/175

DLC
54

DCSO
DCSO
BC/IP

4

N 64° W
179.89

INSTA

5
NAIL

S 65° E
159.35

4
BS

H+T

5

N 67° W
109.19

7
FS
H+T

6
INSTA

DLC
54

DCSO
BC/IP

S 64° E
179.89

5
BS
NAIL

6

H+T

109.19
S 67° E

7
INSTA

139.60
S 88° E

DLC
54
BS

DCSO
BC/IP

BS
7

H+T

136.60
N 8° W
517.00
117.94

H+T

8
INSTA

8
FS
H+T

FS BC/IP

SECTION COR

29 | 28
32 | 33

ON 817 R. 27