

Township 22S Range 13W Sec. 36 County DOUGLAS

State OR Date 7-28-93 No. _____

AUG 27 1993

Corner Designation

COUNTY SURVEYOR
DOUGLAS COUNTY, ORE.

- Condition Report Only
- Not Found
- Renewed
- Unrecorded
- Surveyed In
- Referenced Out

C 1/4

Previous Renewals 1982 BLM

MONUMENT DETAIL

Monument(s) Found: (Condition and Source)

5/8" DIA ALUMINUM ROD AND
METAL FENCE POST, BOTH IN
A 18" DIA X 6" DEEP CONCRETE
BASE. ALUMINUM ROD AND
FENCE POST ARE BENT OVER
WESTERLY ALUMINUM ROD
PROTRUDES 5 FT OUT OF SAND.
1982 BLM

N/A

ALUMINUM ROD IS PLUMB GOING
INTO SAND. AREA IS SUBJECT
TO HEAVY ATV USE, MONUMENT
APPEARS TO HAVE BEEN BENT
OVER TO PROTECT ATV USERS

Accessories Found:

15" NOW 14" DIA DEAD D. FIR WITH A SMALL DIAMOND
SHAPED AXE BLAZE AND NAIL IN BARK DUG IN SAND
ALONG BASE APPROX. 2 1/2 FT, NO BLAZES FOUND.
BEARS N 28° E, 431.7 FT (REC N 28° E 435.3 FT)
1982 BLM

Monument Set (Procedure and Description)

Monument Detail

NONE

N/A

New Accessories

20" DBH FIR BARK SCRIBED "CYA-S36 CS BT"
BEARS N21 1/4° E, 466.0 FT.

CENTER OF TALL NARROW HOUSE (ONLY STRUCTURE IN SIGHT)
BEARS S80 1/2° E

Sketch of Monument, Accessories, and General Area

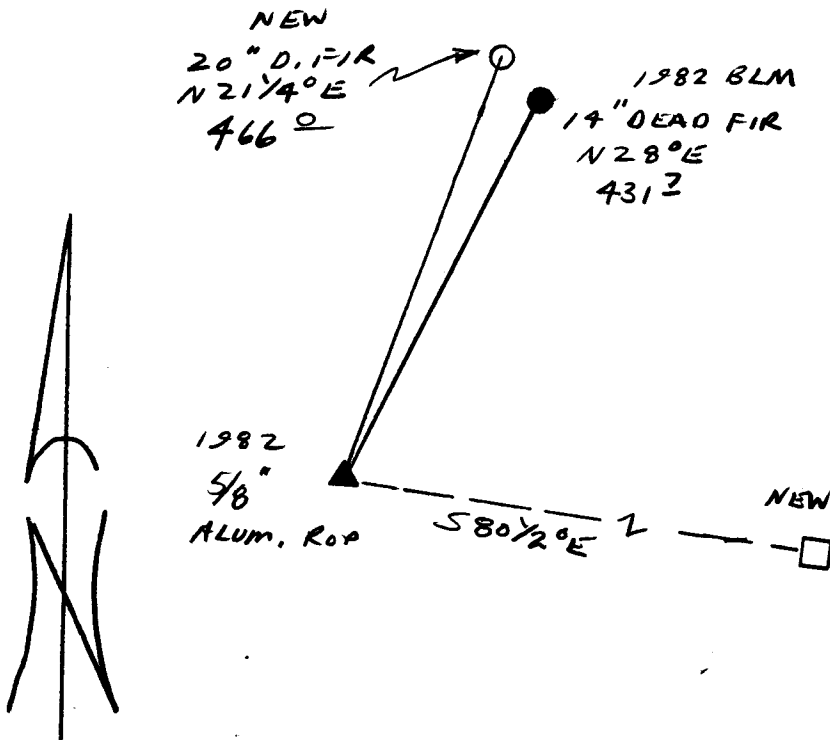

Location & Comments

CORNER LIES IN SAND
DUNES NO OTHER
TREES WITHIN REASONABLE
DISTANCE

Comp. Declin. 18° E
Agency ACSO
Party Chief RANDALL W SMITH
Notekeeper Randall W Smith
Witnesses STEPHEN J FLAUSK

Address

Surveyor's Seal

REGISTERED
PROFESSIONAL
LAND SURVEYOR

Randall W Smith

OREGON
JULY 25, 1990
RANDALL W SMITH
2989

BY AIR 7/23/94