

GOVERNMENT CORNER RESTORATION FORM

Township 275 Range 6W Sec. 29 County DOUGLAS

FILED

JK

State OR Date 5-6-93 No. _____

MAY 12 1993

Corner Designation

1/4 S30 | S29

COUNTY SURVEYOR

DOUGLAS COUNTY, ORE.
Condition Report Only

- Not Found
- Renewed
- Unrecorded
- Surveyed In
- Referenced Out

MONUMENT DETAIL

Previous Renewals EVANS 1952, BYRON 1961

Monument(s) Found: (Condition and Source)

2 1/2" DIA. BRASS CAP ON A 1 1/2" O.D. IRON PIPE, PROTRUDING 11" ABOVE GROUND. (EVANS 1952)

COUNTY SURVEYORS OFFICE

T 275 R 6W
1/4 | S
30 29

Accessories Found:

28" NOW 30" DIA DOWN AND ROTTED OAK WITH A PREVIOUSLY OPENED BLAZE, WE REOPEN NO BLAZES OR SCRIBING FOUND, ROOT HOLE BEARS $\frac{1}{2}$ S 1° E, 185.5 FT (AGREES WITH REC) ORIG. BT

20" Y. OAK NOW 36" DIA. B. OAK WITH FULLY HEALED BLAZE, BEARS S 50 1/2° W, 98.5 FT, (REC S 50 1/2° W, 97.7 POSSIBLE FACE MEASUREMENT) ORIG. BT

14" NOW 10" DIA DOWN AND ROTTING OAK, FALLEN ON FACE, ROOT HOLE BEARS N 77° E, 51.6 FT (AGREES WITH REC) BYRON 1961

7" NOW 7" DIA DEAD W. OAK WITH A FULLY HEALED DOUBLE BLAZE, BEARS S 64° W, 21.2 FT (AGREES WITH REC) BYRON 1961

200240.002 ✓

C.S. File No. 6943-16 C

Monument Set (Procedure and Description)

Monument Detail

NONE

N/A

New Accessories

- 7" W. OAK DOUBLE BLAZED, SCRIBED "1/4 S 30 CS BT", BEARS S 24 1/4° W, 31.6 FT
- 11" W. OAK DOUBLE BLAZED, SCRIBED "1/4 S 29 CS BT", BEARS S 16° E, 37.2 FT
- 7" D. FIR DOUBLE BLAZED, SCRIBED "1/4 S 29 CS BT", BEARS S 55 1/2° E, 44.0 FT

Sketch of Monument, Accessories, and General Area

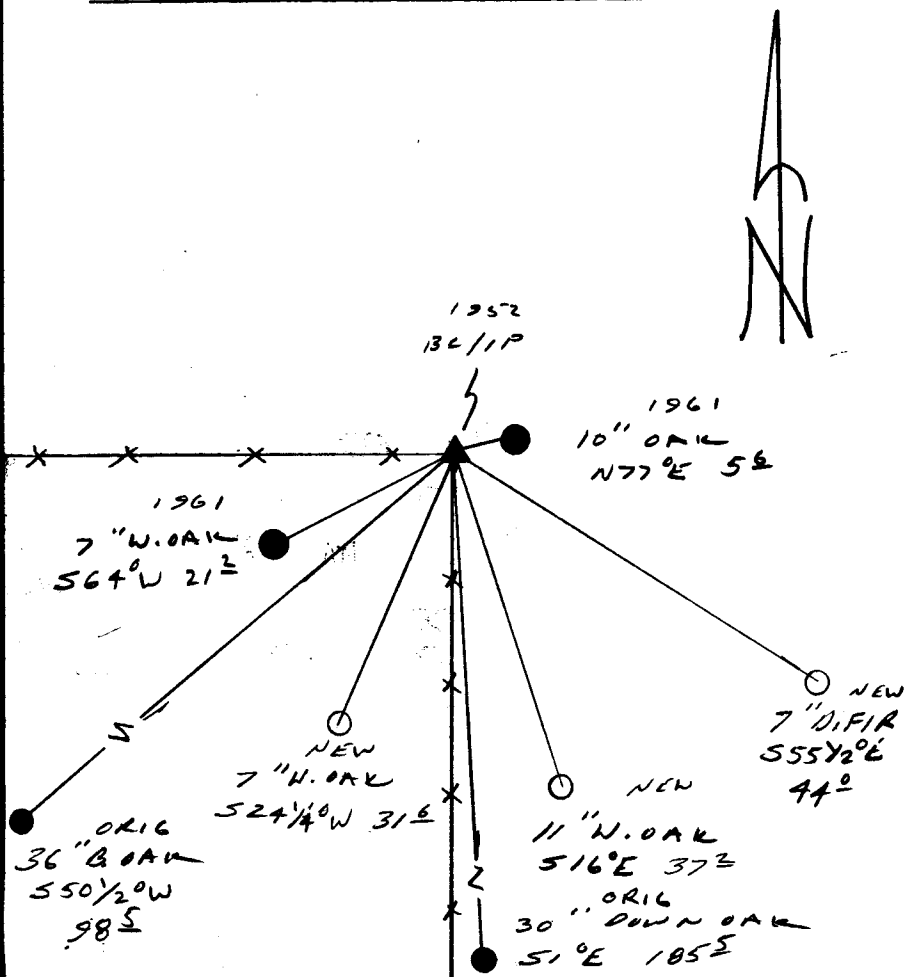

Location & Comments

CORNER LIES AT THE INTERSECTION OF SOUTH AND WEST RUNNING FENCE LINES

Comp. Declin. 18° E
 Agency OCSO
 Party Chief RANDALL W. SMITH
 Notekeeper *Randall W. Smith*
 Witnesses STEPHEN J. FLANSE

Address

Surveyor's Seal

REGISTERED PROFESSIONAL LAND SURVEYOR
Randall W. Smith
 EXPIRES 12-31-94
 OREGON
 JULY 25, 1990
 RANDALL W. SMITH
 2489