

GOVERNMENT CORNER RESTORATION FORM

FILED

Township 27S Range 6W Sec. 19 County DOUGLAS

State OR Date 5-4-93 No. _____

MAY 12 1993

Corner Designation

COUNTY SURVEYOR
DOUGLAS COUNTY, ORE.

- Condition Report Only
- Not Found
- Renewed
- Unrecorded
- Surveyed In
- Referenced Out

$\frac{1}{4} \frac{S19}{S30}$

MONUMENT DETAIL

Previous Renewals 1961 BYRON VOL 1 pg 242

Monument(s) Found: (Condition and Source)

2 1/2" DIA BRASS CAP ON A 1 1/2" OD
IRON PIPE, PROTRUDING 14" ABOVE
GROUND. (1961 BYRON - NOT RECORDED
IN PI# 140300, OR OLD REN# 83 IS
IN CS 49/79)
CORNER STONE TOP MEASURES
6" x 6" x 6" ABOVE GROUND
ALONG NORTH EDGE OF BC/1P.
(VOL 1 pg 242)

COUNTY SURVEYORS OFFICE

T27S R6W

$\frac{1}{4} \frac{S19}{S30}$

1961

Accessories Found:

12" NOW 17" DIA B. OAK WITH A FULLY HEALED DOUBLE BLAZE,
BEARS N 33° E, 24.7 FT (AGREES WITH REC) 1961 BYRON

6" NOW 7" DIA W. OAK WITH A FULLY HEALED DOUBLE BLAZE,
BEARS S 59° W, 13.6 FT (AGREES WITH REC) 1961 BYRON

POSSIBLE, ROTTED REMAINS OF DOWN ORIG. SW BT
FOUND NEAR RECORD BEARING AND DISTANCE.

ALL REMAINS OF ORIG NE BT NOW GONE

140300, OR 22

Monument Set (Procedure and Description)

Monument Detail

NONE

N/A

New Accessories

8" DIA. D. FIR DOUBLE BLAZED "1/4 S19 CS BT" BEARS
N 15 1/2° E , 7.4 FT

12" DIA MADRONE BARK SCRIBED "1/4 S 30 CS BT" BEARS
S 44 1/4° E , 20.8 FT

Sketch of Monument, Accessories, and General Area

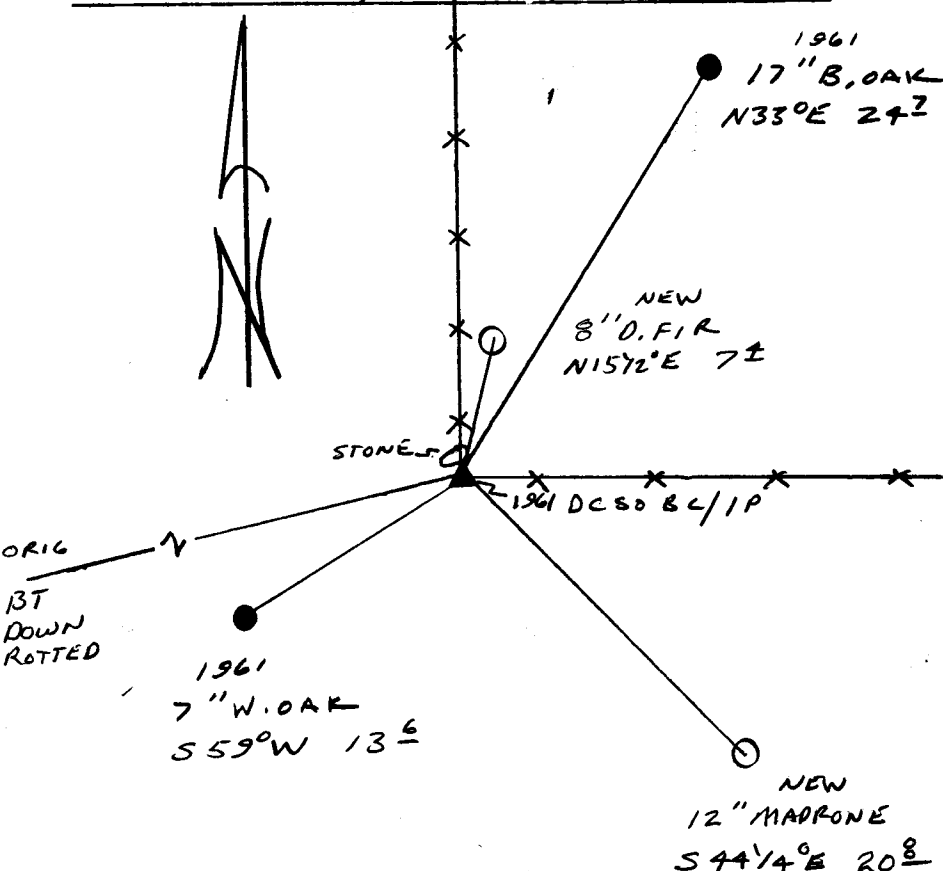

Location & Comments

CORNER LIES AT THE
INTERSECTION OF A NORTH
AND EAST RUNNING FENCE
LINES

Comp. Declin. 18° E
Agency OCSO
Party Chief RANDALL W SMITH
Notekeeper Randall W Smith
Witnesses STEPHEN J FLAUSE

Address

Surveyor's Seal

REGISTERED
PROFESSIONAL
LAND SURVEYOR

Randall W Smith
EXPIRES 12-31-94

OREGON
JULY 25, 1990
RANDALL W. SMITH
2489