

GOVERNMENT CORNER RESTORATION FORM

FILED JP

Township 27S Range 6W Sec. 31 County DOUGLAS

JUN 9 1993

State OR Date 5-11-93 No. _____

Corner Designation

COUNTY SURVEYOR
DOUGLAS COUNTY, ORE.

1/4 S31 | S32

- _____ Condition Report Only
- _____ Not Found
- Renewed
- _____ Unrecorded
- _____ Surveyed In
- _____ Referenced Out

Previous Renewals 1961 BYRON

Monument(s) Found: (Condition and Source)

2 1/2" DIA. BRASS CAP ON A 1 1/2" O.D. IRON PIPE, PROTRUDING 20" ABOVE GROUND

1/2" I.D. IRON PIPE PROTRUDES 7" ABOVE GROUND BE ALONG EAST EDGE OF BC/IP. (SOURCE UNKNOWN)

MONUMENT DETAIL

COUNTY SURVEYORS OFFICE
T27S R6W

1/4 S31 | S32
1961

Accessories Found:

12" NOW 25" DIA B. OAK WITH A FULLY HEALED DOUBLE BLAZE, BEARS N37°W, 30.0 FT (AGREES WITH 1961 BYRON REN) ORIG BT ORIG EAST BT IS GONE

7" NOW 9" DIA N. OAK WITH A FULLY HEALED DOUBLE BLAZE, BEARS N28°E, 62.6 FT (AGREES WITH REC) 1961 BYRON

Monument Set (Procedure and Description)

Monument Detail

NONE

N/A

New Accessories

8" DIA MADRONE BARK SCRIBED "CS 1/4 S 31 BT" BEARS
S 19° W, 10.0 FT

12" DIA. ASH DOUBLE BLAZED AND SCRIBED "1/4 S 32 CS BT"
BEARS N 57° E, 66.7 FT

Sketch of Monument, Accessories, and General Area

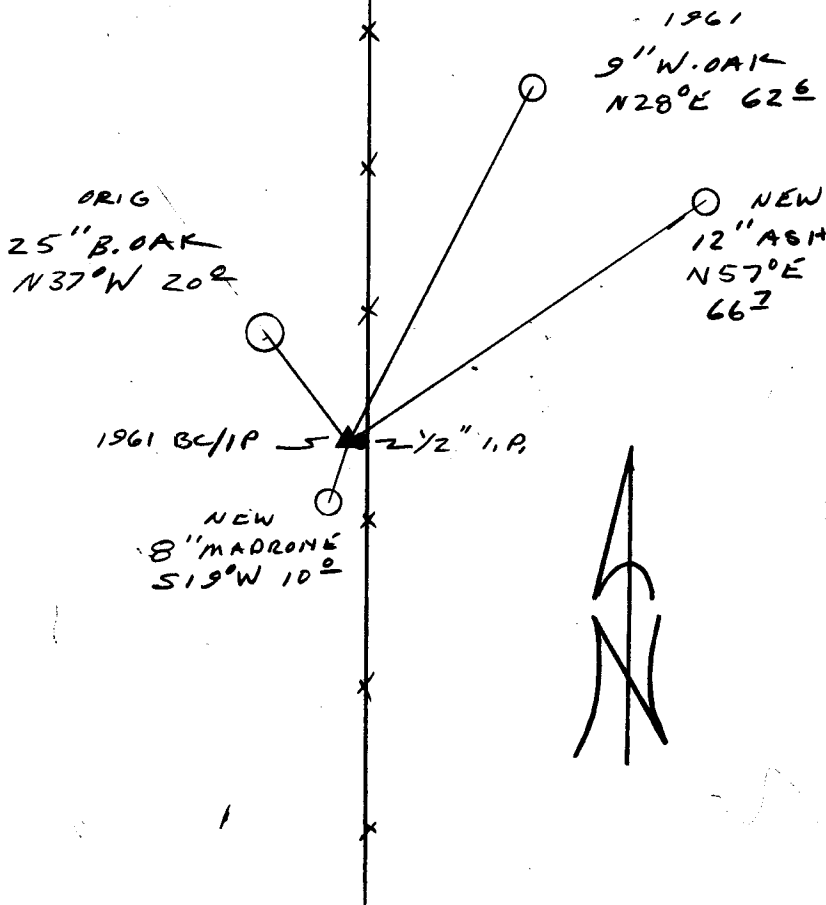

Location & Comments

COR IS 1 FT WEST OF
A NORTH - SOUTH FENCE
LINE.

Comp. Declin. 18° E
Agency DC SO
Party Chief RANDALL W SMITH
Notekeeper [Signature]
Witnesses STEPHEN J FLAUSE

Address

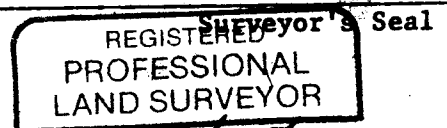

[Signature]
EXPIRES 12-31-94

