

GOVERNMENT CORNER RESTORATION FORM

FILED 8

Township 27S Range SW Sec. 7 County DOUGLAS

APR 22 1993

State OR Date 4-20-93 No. _____

Corner Designation

COUNTY SURVEYOR
DOUGLAS COUNTY, OR.

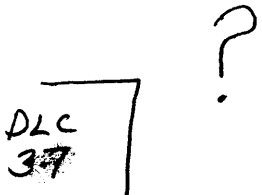

- Condition Report Only
- Not Found
- Renewed
- Unrecorded
- Surveyed In
- Referenced Out

MONUMENT DETAIL

Previous Renewals 1932 OLC REN.

Monument(s) Found: (Condition and Source)

A 3/4" BOLT WITH A 1/2" SQUARE HEAD, PROTRUDING 3" ABOVE GROUND.

I.P. SET IN 1932 REN. NOT FOUND.

N/A

Accessories Found:

8" NOW 20" DIA. W. OAK WITH A FULLY HEALED SINGLE BLAZE, BEARS S 85°W, 41.9 FT CREC S83°W 35.0 FT POSSIBLE ORIG. DIST ERROR? 63 LKS INSTEAD OF 53 LKS) ORIG. BT.

11" NOW 15" DIA. 1 FT HIGH ROTTED OAK STUMP NO BLAZES OR SCRIBING FOUND. BEARS NORTH, 11.9 FT. (AGREES WITH RECORD), ORIG. BT

12" NOW 16" DIA W. OAK WITH A FULLY HEALED SINGLE BLAZE, BEARS S 38°W, 33.0 FT CREC S 34 1/2°W, 33.0 FT) 1932 REN.

Monument Set (Procedure and Description)

Monument Detail

NONE

N/A

New Accessories

10" DIA. MADRONE, BARK SCRIBED "NE DCS 37 CS BT"
BEARS N 11 3/4° E, 27.7 FT.

18" DIA MADRONE, BARK SCRIBED "NE DCS 37 CS BT"
BEARS N 56° E, 44.8 FT.

Sketch of Monument, Accessories, and General Area

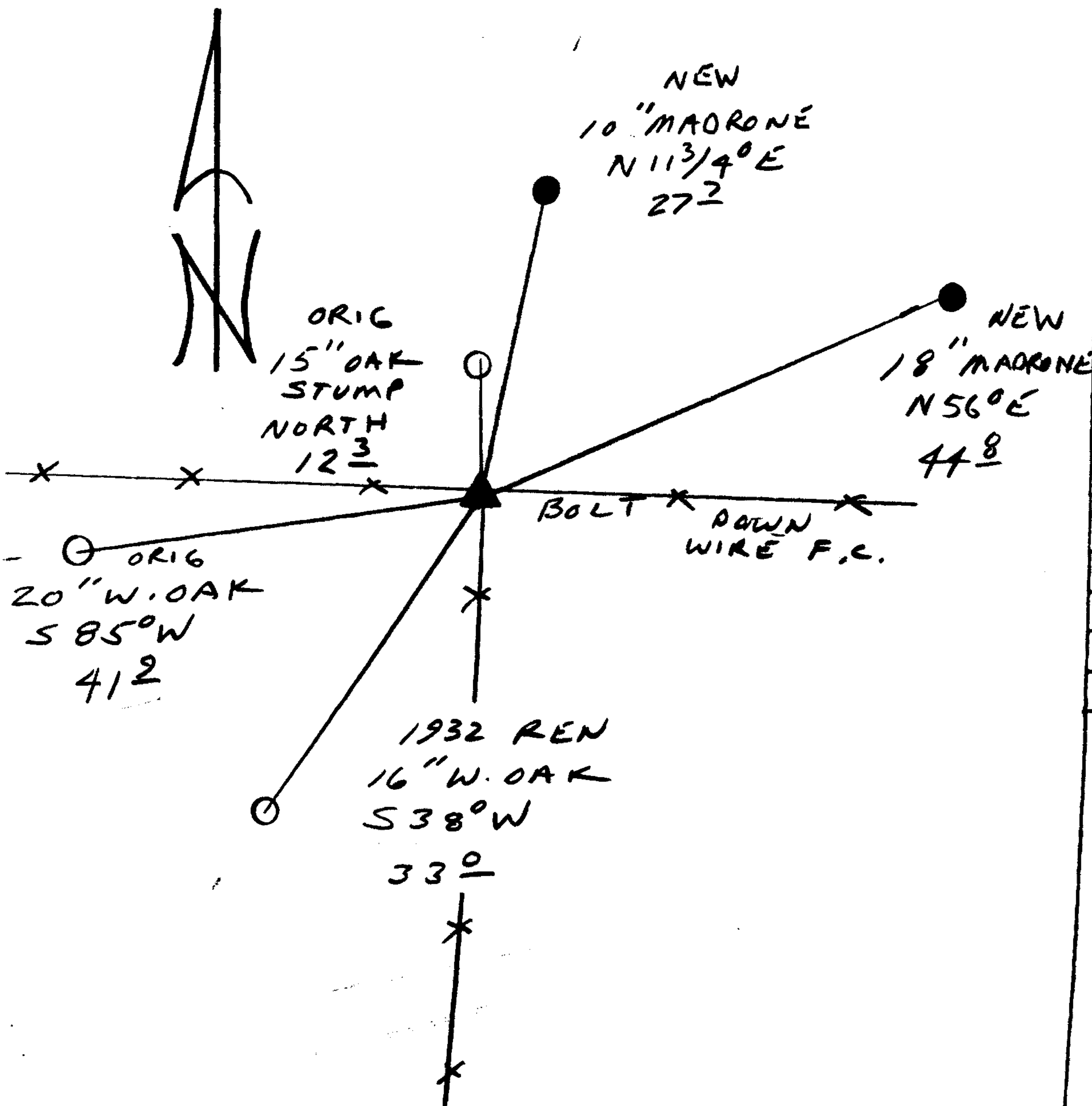

Location & Comments

EAST-WEST AND
SOUTH RUNNING FENCE
LINES AT CORNER.

WE PERPETUATED A LOCALLY
ACCEPTED MONUMENT

Comp. Declin. 18° E
Agency DCSO
Party Chief RANDALL W. SMITH
Notekeeper Randall W. Smith
Witnesses STEPHEN J. FAUSE

Address

EXPIRES 12-31-94 Surveyor's Seal

REGISTERED
PROFESSIONAL
LAND SURVEYOR

Randall W. Smith

OREGON
JULY 25, 1990
RANDALL W. SMITH
2489