

GOVERNMENT CORNER RESTORATION FORM

FILED

Township 22 S Range 11 W Sec. 4 County DOUGLAS

MAR 17 1993

State OR Date 2-24-93 No. _____

COUNTY SURVEYOR
DOUGLAS COUNTY, OREGON

Corner Designation

W.C. EY4S4 ONLY

- _____ Condition Report Only
- _____ Not Found
- Renewed
- _____ Unrecorded
- _____ Surveyed In
- _____ Referenced Out

Previous Renewals #109

Monument(s) Found: (Condition and Source)

A 3" DIA ORK. ST. BR. OF FORESTRY
BRASS CAP ON AN IRON PIPE, 18"
BELOW GROUND. UNABLE TO READ
TOP OF BRASS CAP. REN #109

N/A

Accessories Found:

5' X 2' X 1/2' HIGH SAND STONE BOULDER, NO "X" FD
BEARING AND DISTANCE FROM REN #109, FITS BOULDER
(REC S63°W, 72.9 FT) REN #109

8" NOW 11" DIA. MYRTLE IN CLUSTER OF MYRTLES,
CENTER OF NE TRUNK HAS A PARTIALLY HEALED DOUBLE
BLAZE SCRIBING VISIBLE "X" CNT NE TRUNK BEARS S33 1/2°W,
58.0 FT (AGREES WITH REC) REN #109

Be/1P WY4S3, BEARS N 0 3/4° E, 116.7 FT

#178 ✓

RENEWAL

Monument Set (Procedure and Description)

Monument Detail

NONE

N/A

New Accessories

POWER POLE, BEARS N 6 1/2° W, 297.6 FT

Sketch of Monument, Accessories, and General Area

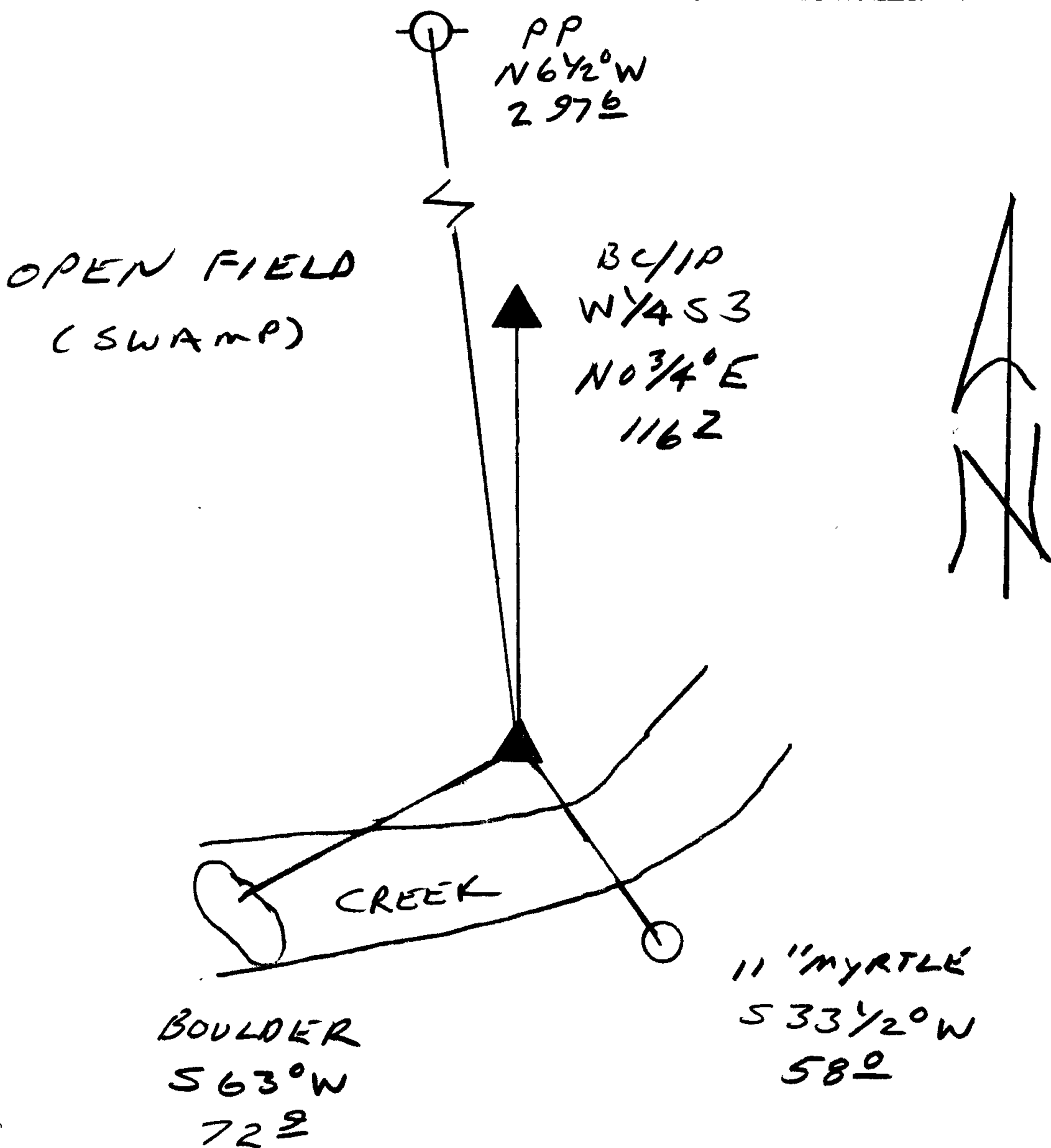

Location & Comments

Comp. Declin. 18° E
 Agency DLSO
 Party Chief RANDALL W SMITH
 Notekeeper Randall W Smith
 Witnesses STEPHEN J FLAUSE

Address

Surveyor's Seal

REGISTERED
 PROFESSIONAL
 LAND SURVEYOR

Randall W Smith
 EXPIRES 12-31-94

OREGON
 JULY 25, 1990
 RANDALL W. SMITH
 2489