

GOVERNMENT CORNER RESTORATION FORM

Township 22S Range 10W Sec. 30 County DOUGLAS

State OR Date 2-22-93 No. _____

Corner Designation

FILED

S25 | S30 cc
S31

MAR 17 1993

Condition Report Only
 Not Found
 Renewed
 Unrecorded
 Surveyed In
 Referenced Out

COUNTY SURVEYOR
DOUGLAS COUNTY, OR

Previous Renewals #65(T22-10) (#119T22-11)

MONUMENT DETAIL

Monument(s) Found: (Condition and Source)

FD ORIGINAL STONE (36"x20"x10")
LAYING ON SIDE WITH MARKS
CC ON TOP, 5 NOTCHES ON NORTH
EDGE AND + ON EAST EDGE.

N/A

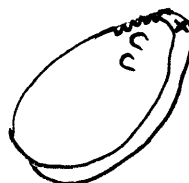

Accessories Found:

- 6" NOW 29" DIA. 7 FT HIGH BURNT D. FIR STUMP, WITH A FULLY HEALED BLAZE, BEARS S65°E, 13.2 FT. (ORIG. BT)
- 8" NOW 26" DIA 4 FT HIGH BURNT D. FIR STUMP, WITH A FULLY HEALED SINGLE BLAZE, BEARS N63°E, 40.8 FT (REC REN#65 N63°E 40.0 FT) ORIG. BT
- 29" DIA 3 FT HIGH BURNT D. FIR STUMP, WITH A FULLY HEALED BLAZE, BEARS S80°W, 10.0 FT (REC. REN#65 S75°W 10.0 FT).
- 20" DIA 2 FT HIGH BURNT D. FIR STUMP, WITH EVIDENCE OF A HEALED LOWER BLAZE, BEARS S33 1/2°E, 43.7 FT (REC S33 1/2°E, 44.9 FT, POSSIBLE SLOPE DISTANCE TO BLAZE) REN #65

NO WHITE CEDAR POST FROM REN#65 FOUND

#116 T22-10 X
#180 T22-11 X

RENEWAL

Monument Set (Procedure and Description)

A 2 3/8" DIA BRASS CAP ON A 1 3/8" OD BY 32" LONG IRON PIPE, IS SET AT A POSITION DETERMINED FROM BEARING TREE'S (SEE FRONT). BC/IP PROTRUDES 4" ABOVE GROUND, ORIG. STONE IS PLACED ALONG SOUTHERLY EDGE OF BC/IP ON TOP OF GROUND.

Monument Detail

DOUGLAS COUNTY SURVEYORS

T 22 S

R
I
S 25 | S30
W | S31 CC R
W

1993
OFFICE

New Accessories

N/A

Sketch of Monument, Accessories, and General Area

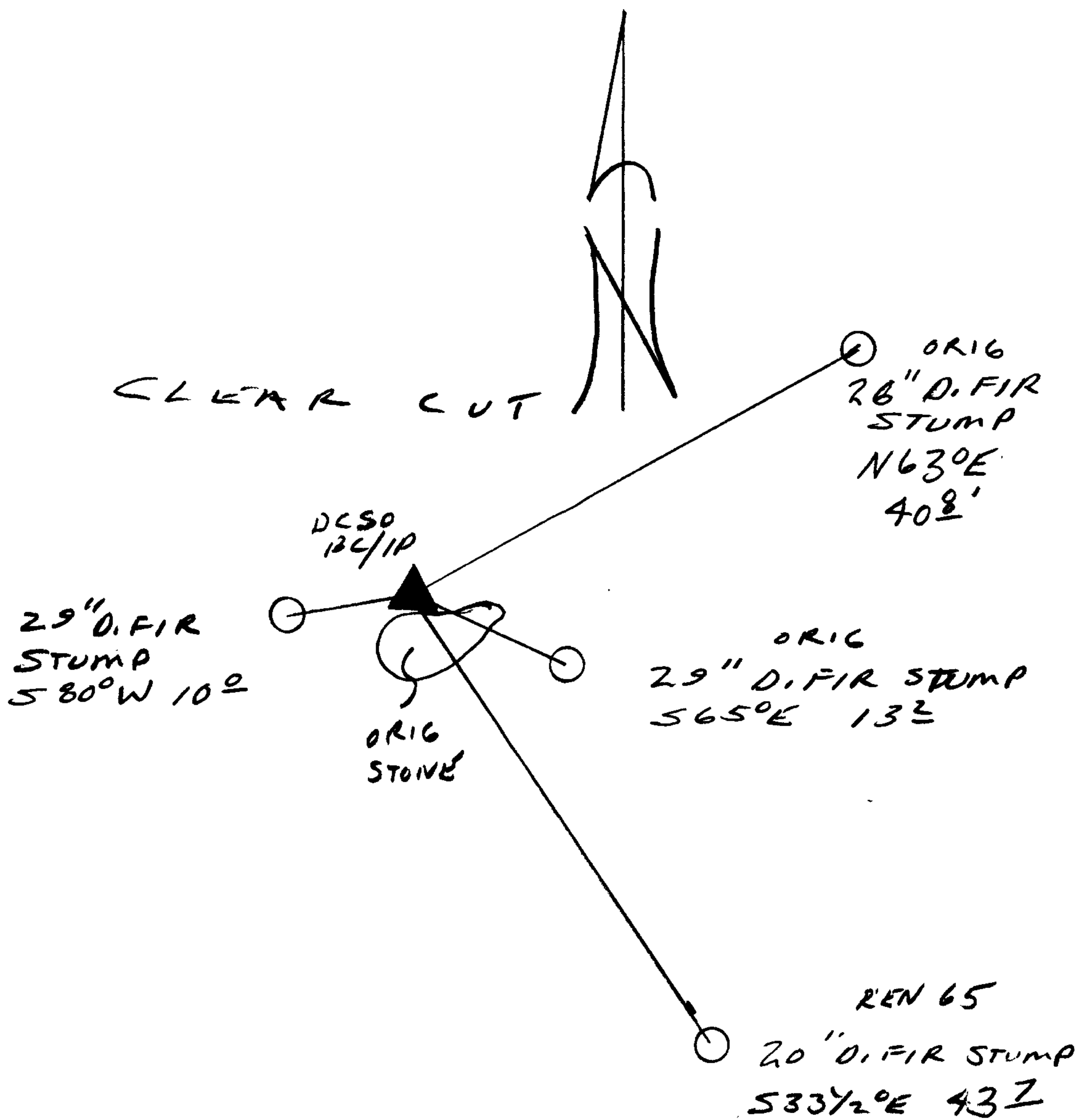

Location & Comments

Comp. Declin. 18° E
Agency DCSO
Party Chief RANDALL W. SMITH
Notekeeper Randall W Smith
Witnesses STEPHEN J FLAUSE

Address

REGISTERED
PROFESSIONAL
LAND SURVEYOR

Randall W Smith
EXPIRES 12-31-94

OREGON
JULY 25, 1990
RANDALL W. SMITH
2489