

GOVERNMENT CORNER RESTORATION FORM

FILED

Township 24 S Range 4 W Sec. 5 County DOUGLAS

DEC 14 1992

State OR Date 11-9-92 No. _____

COUNTY SURVEYOR
DOUGLAS COUNTY, OREGON

Corner Designation

56 | 55
57 | 58

- Condition Report Only
- Not Found
- Renewed
- Unrecorded
- Surveyed In
- Referenced Out

Previous Renewals #64

MONUMENT DETAIL

Monument(s) Found: (Condition and Source)

BC/IP FROM REN #64
NOT FOUND. AREA AROUND
CORNER IS IN POWER LINE R/W.
PROPERTY OWNER CLIFFORD
BYDED INDICATED AREA HAD BEEN
BULLDOZED APPROX. 4 OR 5 YEARS
AGO

N/A

Accessories Found:

10" NOW 37" DIA. B. OAK WITH A PREVIOUSLY OPENED
NOW HEALED SINGLE BLAZE AND BT TAG. BEARS
578 1/2° E, 378.2 FT (ORIG BT)

NO REMAINING BT'S OR ANY EVIDENCE OF THEIR
LOCATION FOUND OF BT'S FROM REN #64

WEST POWER POLE FROM REN #64 APPEARS TO HAVE BEEN
REPLACED.

HIGH PEAK OF HOUSE BEARS N 75 1/2° W, (REC TO HOUSE
N 75° W) REN #64

177 x

RENEWAL

Monument Set (Procedure and Description)

A DCSG 2 3/8" DIA BRASS CAP ON
 1 1/2" O.D. X 31" LONG IRON PIPE IS
 SET AT REC BRG AND DIST FROM
 REMAINING ORIG. BT. (N 78 1/2° W, 378.2 FT)
 BC/IP PROTRUDES 5" ABOVE GROUND

Monument Detail

DOUGLAS COUNTY SURVEYORS
 T 24 S

56	55	R
57	58	W

1992
 OFFICE

New Accessories

16" DIA. APPLE DOUBLE BLAZED AND SCRIBED " X BT " BEARS S 29° W, 122.7 FT

8" DIA W. OAK DOUBLE BLAZED AND SCRIBED " T 24 S R A W S 7 C S BT " BEARS S 82 1/2° W, 174.2 FT

WEST POWER POLE, BEARS N 80° E 106.6 FT

Sketch of Monument, Accessories, and General Area

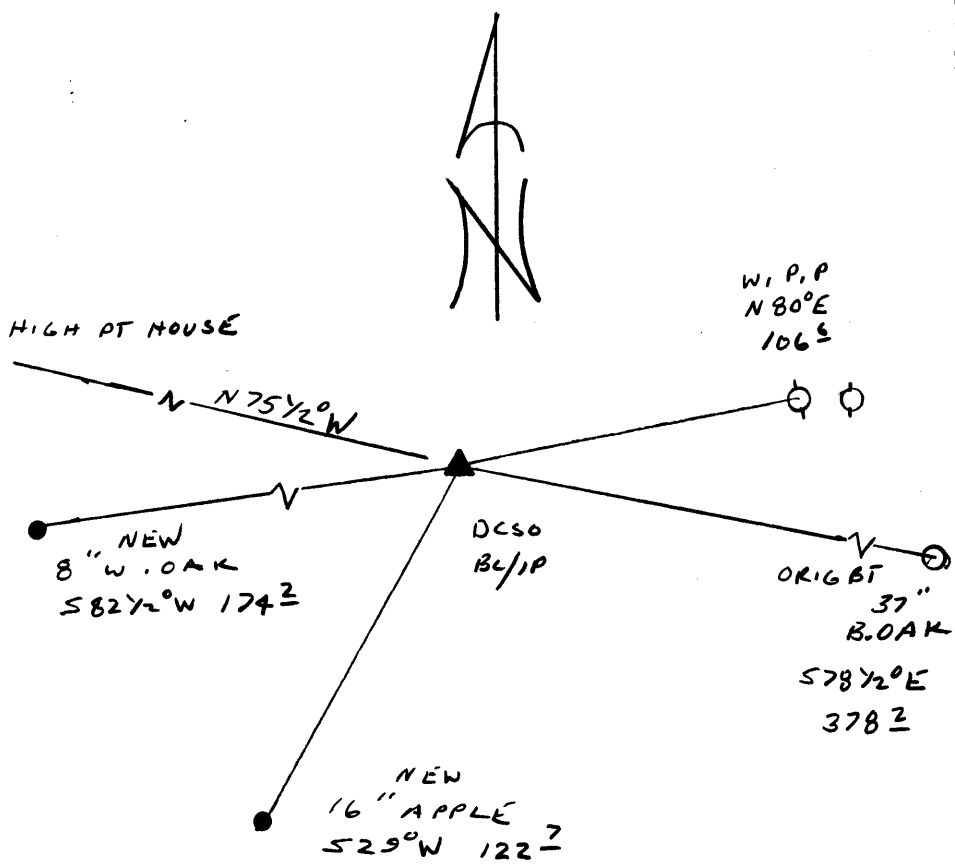

Location & Comments

CORNER LIES IN POWER
 LINE R/W, A METAL
 FENCE POST IS SET
 1 FT WEST

Comp. Declin. 18° E
 Agency DCSG
 Party Chief RANDALL W SMITH
 Notekeeper Randall W Smith
 Witnesses STEPHEN J FLAISE

Address

Surveyor's Seal

REGISTERED
 PROFESSIONAL
 LAND SURVEYOR

Randall W Smith

OREGON
 JULY 25 1980
 RANDALL W. SMITH
 2459