

GOVERNMENT CORNER RESTORATION FORM

FILED

Township 25S Range 2W Sec. 31 County DOUGLAS

JH
SEP 8 1992

State OR Date 8/10/92 No. _____

Corner Designation

COUNTY SURVEYOR
DOUGLAS COUNTY, ORE.

- _____ Condition Report Only
- _____ Not Found
- Renewed
- _____ Unrecorded
- _____ Surveyed In
- _____ Referenced Out

$\frac{1}{4}$
S 36 | S 31
ONLY

(# 700138 T25-3) # 66 T25-2

Previous Renewals 1972 BLM

Monument(s) Found: (Condition and Source)

3/4" DIA BLM BRASS CAP ON A
2 1/2" O.D. IRON PIPE, PROTRUDES
6" ABOVE GROUND (1972 BLM)

U.S. DEPT. OF THE INTERIOR

T25S R2W

| $\frac{1}{4}$ S 31

1972

BUR. OF LAND MANAGEMENT

Accessories Found:

18" NOW 23" DIA O.FIR WITH A FULLY HEALED SINGLE BLAZE,
BEARS N53 1/2° E, 68.0 FT CAGREES WITH REC. 1972 BLM

10" NOW 14" DIA HEMLOCK WITH A FULLY HEALED SINGLE BLAZE
BEAR S60° E, 58.6 FT (REC. S60° E 60.1 FT IS A SLOPE DIST).
1972 BLM

GLO 1943 BLIP (EY4S36 T25S R3W ONLY) BEARS NORTH
73.9 FT CAGREES WITH REC)

T25-3
700138 ✓
T25-2 #728 ✓

FILE NO. 6432-1

RENEWAL

Monument Set (Procedure and Description)

Monument Detail

NONE

N/A

New Accessories

14" DIA D. FIR DOUBLE BLAZED AND SCRIBED "1/4 S31CS BT"
BEARS N1 1/2° E, 24 FT

8" DIA D. FIR DOUBLE BLAZED AND SCRIBED "1/4 S31CS BT"
BEARS S55 1/2° E, 24.7 FT

Sketch of Monument, Accessories, and General Area

Location & Comments

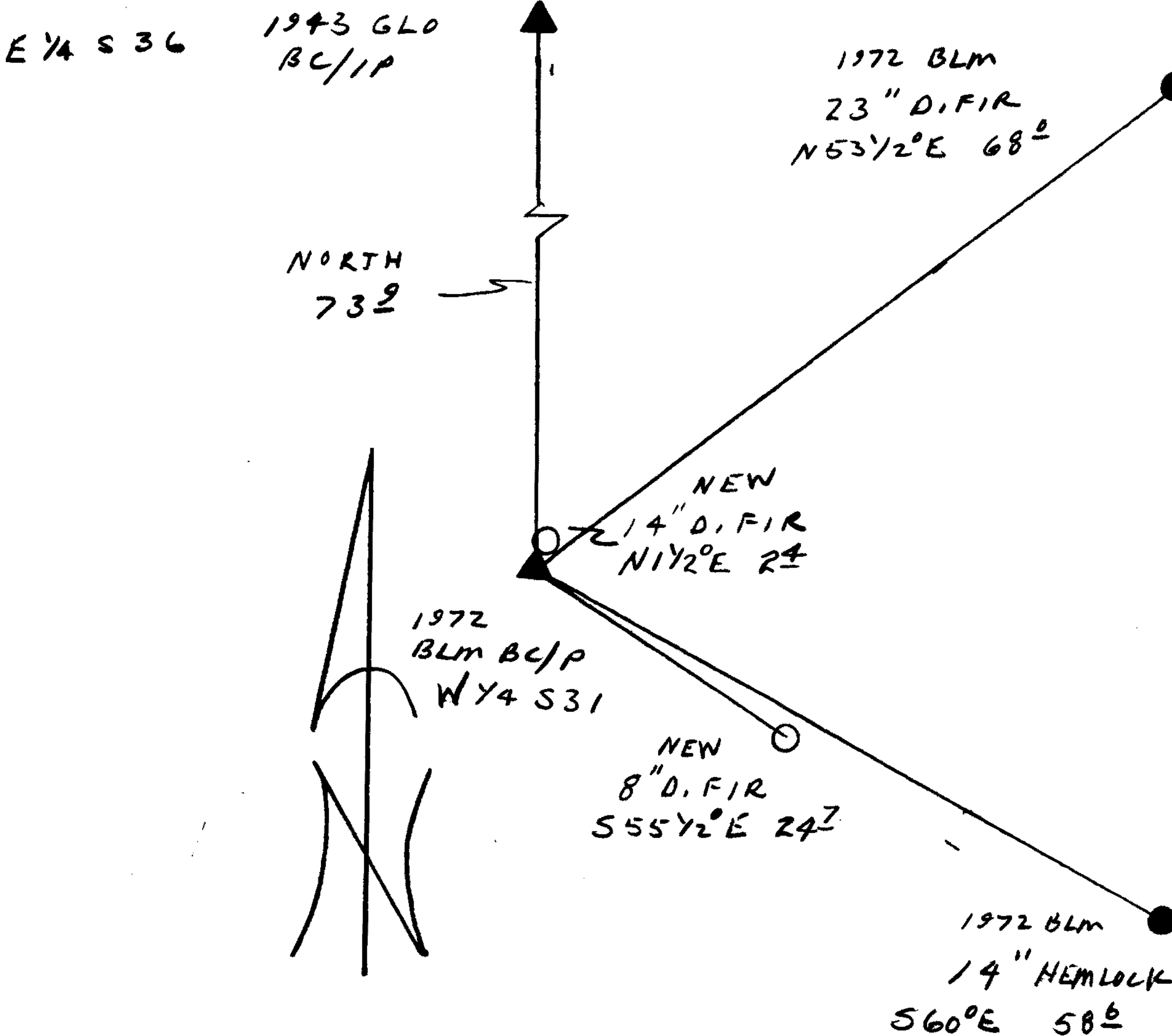

Comp. Declin. 17 3/4° E
 Agency DCSG
 Party Chief RANDALL W SMITH
 Notekeeper Randall W Smith
 Witnesses STEPHEN J FLAUSE

Address

Surveyor's Seal

REGISTERED
 PROFESSIONAL
 LAND SURVEYOR

Randall W Smith

OREGON
 JULY 25, 1990
 RANDALL W. SMITH
 2469