

GOVERNMENT CORNER RESTORATION FORM

FILED

JH

Township 22S Range 9W Sec. 7

County DOUGLAS

JUN 12 1992

State OR Date 6/10/92

No. \_\_\_\_\_

COUNTY SURVEYOR  
DOUGLAS COUNTY, ORE.

Corner Designation

57 | 58  
---  
518 | 517

- Condition Report Only
- Not Found
- Renewed
- Unrecorded
- Surveyed In
- Referenced Out

Previous Renewals 1970 BLM, M69-36

Monument(s) Found: (Condition and Source)

3/4" BLM BRASS CAP ON A 2 1/2" O.D.  
IRON PIPE, LEANING 1 FT WEST.  
BC/IP 1 FT UNDER GROUND.  
(1970 BLM)

MONUMENT DETAIL

US DEPT OF THE INTERIOR

T 22 S R 9 W

57 | 58  
---  
518 | 517

1970

BUR OF LAND MANAGEMENT

Accessories Found:

15" NOW 18" DIA, 2' TALL D. FIR STUMP WITH A FULLY HEALED  
SINGLE BLAZE, BEARS N83 1/2° E, 72.9 FT (AGREES WITH REC)  
(1970 BLM)

23" NOW 24" DIA, 3' TALL D. FIR STUMP WITH A FULLY HEALED  
SINGLE BLAZE, BEARS S56° E, 67.3 FT (AGREES WITH REC)  
(1970 BLM)

12" NOW 24" DIA, 1' TALL D. FIR STUMP, WE OPENED BLAZE  
AND FOUND SCRIBING "W", BEARS S48 1/2° W, 48.2 FT  
(AGREES WITH REC) (1970 BLM)

15" NOW 24" DIA, 3' TALL D. FIR STUMP WITH A FULLY HEALED  
SINGLE BLAZE, BEARS N54 1/2° W, 44.2 FT (AGREES WITH REC)  
(1970 BLM)

5/8" I.R. FROM M69-36, WE AGREE WITH REC. DIST.  
OF 327.6", BEARING NOT CHECKED.

#111X

RENEWAL

Monument Set (Procedure and Description)

Monument Detail

BLM BRASS CAP IRON PIPE RETURNED TO PLUMB POSITION, 1 FT BELOW GROUND.

N/A

New Accessories

9" "x" CHISELED IN SANDSTONE CUT BANK, 3 FT ABOVE ROAD, ALONG EAST SIDE OF GRAVEL RD, BEARS S 87 1/2° E, 41.9 FT.
6" "x" CHISELED IN SANDSTONE CUT BANK, 2 FT ABOVE ROAD, ALONG EAST SIDE OF GRAVEL RD, BEARS S 27° E, 38.6 FT.

Sketch of Monument, Accessories, and General Area

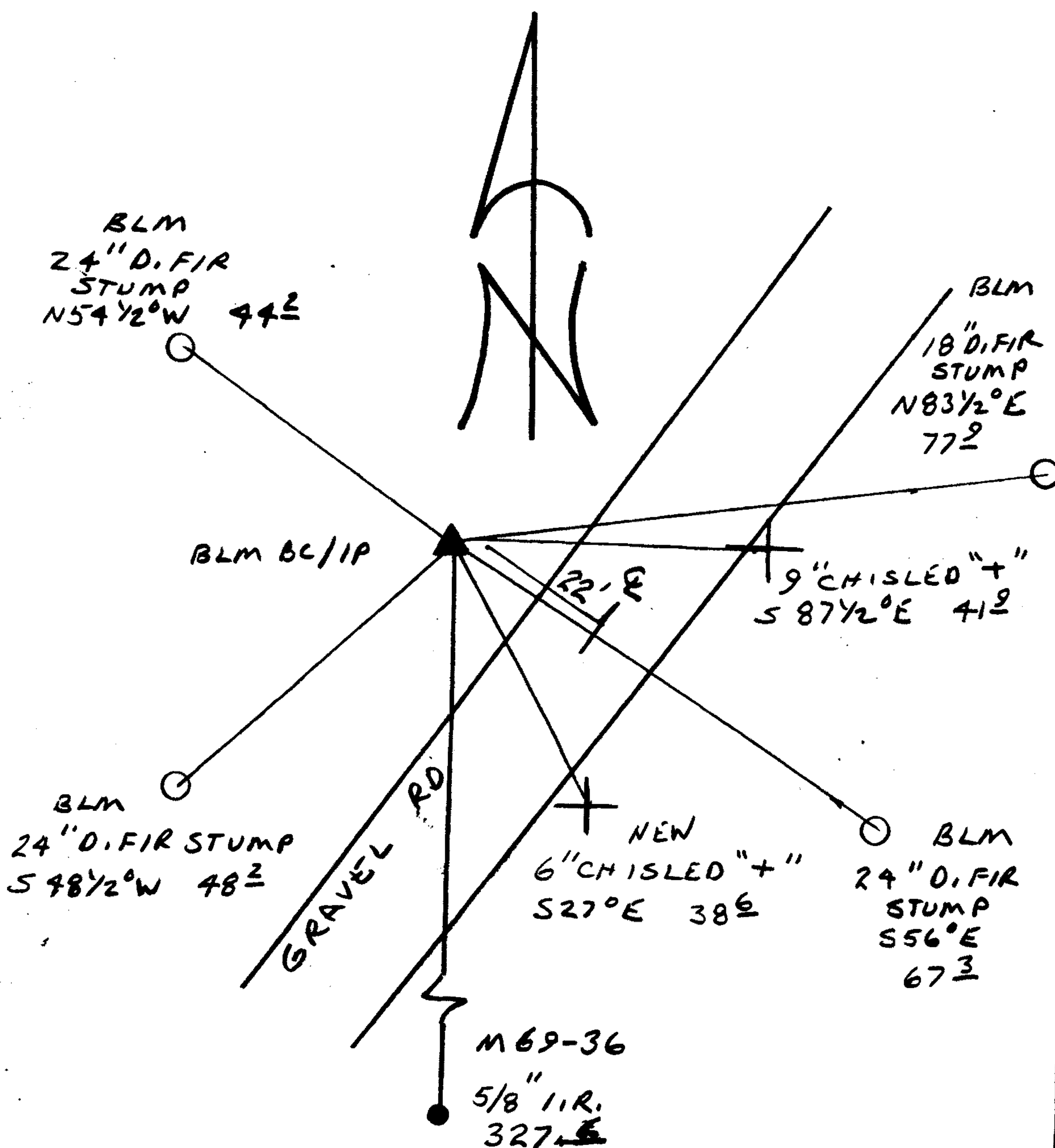

Location & Comments

METAL WITNESS POST + SIGN 4 FT EAST OF CORNER.
AREA AROUND CORNER IS CLEAR CUT NO REASONABLE TREES TO SCRIBE

Comp. Declin. 18° E
Agency DCSO
Party Chief RANDALL W. SMITH
Notekeeper Randall W. Smith
Witnesses STEPHEN J. FLAUSK

Address

Surveyor's Seal
REGISTERED PROFESSIONAL LAND SURVEYOR
Randall W. Smith
OREGON
JULY 25, 1990
RANDALL W. SMITH
2469